

Thermostat Installation Guide: Manual Thermostat

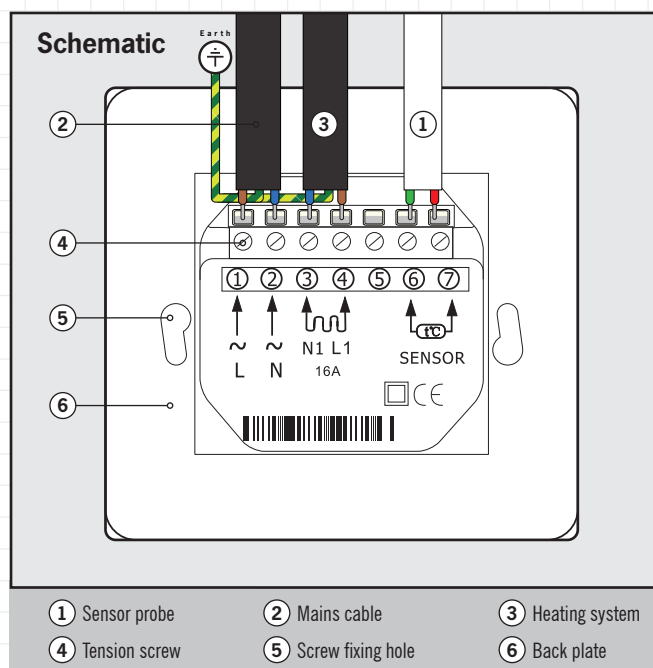
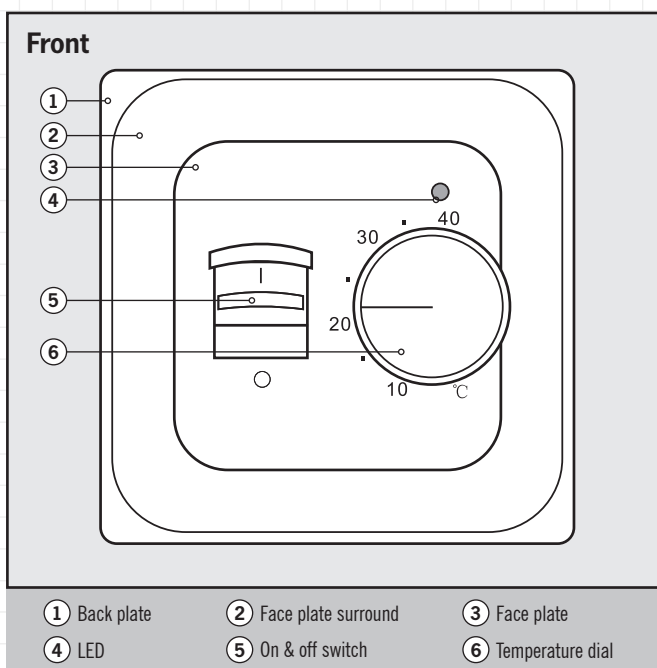

Installation: Introduction

A conduit should be in place prior to installation. This conduit receives the sensor probe allowing it to be removed where necessary.

Step 1: Temperature dial & remove face plate

Firstly remove the temperature dial using a flat head screw driver. Now unscrew the captive screw situated to the left under the temperature dial using a cross head screw driver, and remove the face plate.

Step 2: Wire your 5250

To install the 5250 Thermostat you will need a single gang back box of at least 30mm deep. Firstly insert the sensor probe supplied into the back box and down into the conduit. Then connect the sensor probe and mains cable to the 5250 (See schematic above). Ensure that the wiring is adequate for the total load of the underfloor heating system. If installed into a metal back box, earthing of the back box is required.

Step 3: Insert into a back box

Secure the back plate and main body to the back box with the 3.5mm screws provided. Tidy the cables during installation to avoid entrapment and cable damage. Now reposition the face plate surround and tighten the captive screw.

Operation: Power up and controls

Use the on & off Switch to turn the unit on and off. The LED positioned on the front of the 5250 will light up once on. Turn the temperature dial to select a desired temperature. Do not turn on the underfloor heating system until all adhesives and levelling compounds have fully cured. Consult manufacturer guidelines for curing times.

✓ PRO TIP

When the room temperature has been stabilized, the thermostat set position may be adjusted to match the actual floor temperature. Measure the temperature of the floor with an accurate thermometer. Remove the temperature dial so that the indicated temperature line shows the same as the measured temperature.

✓ PRO TIP

A locking mechanism is positioned behind the temperature dial to limit the minimum and maximum temperatures. To adjust simply remove the temperature dial, loosen the small screw on the right and manoeuvre the green rings to your desired minimum & maximum. The range can be adjusted between 10°C minimum & 40°C maximum. Please note it is not advised to run the underfloor heating system over 28°C.



Technical Specification

Operating ambient temperature	Voltage	Protective housing	Size	Minimum wall box depth	Total Load
-5 to +40°C	230V	IP20	86mm (L) x 86mm (W) x 50mm (D)	30mm	16A

Final Checklist

- FIX AND SECURE THE THERMOSTAT PROPERLY
- FULLY EARTH TO A METAL BACK BOX
- CONFIGURE MINIMUM AND MAXIMUM TEMPERATURE
- SAFELY CONNECT TO MAINS SUPPLY

! IMPORTANT SAFETY PRECAUTIONS !

-  A FULLY QUALIFIED & CERTIFIED ELECTRICIAN SHOULD INSTALL THIS PRODUCT
-  TO PREVENT FIRE OR ELECTRICAL SHOCK, DO NOT EXPOSE THIS PRODUCT TO MOISTURE OR WET ZONES. THIS THERMOSTAT IS IP20 RATED
-  DO NOT ADJUST THE SET TEMPERATURE ONCE INSTALLED

5250IG_A4_161014.PDF