

Protek 358 Profile

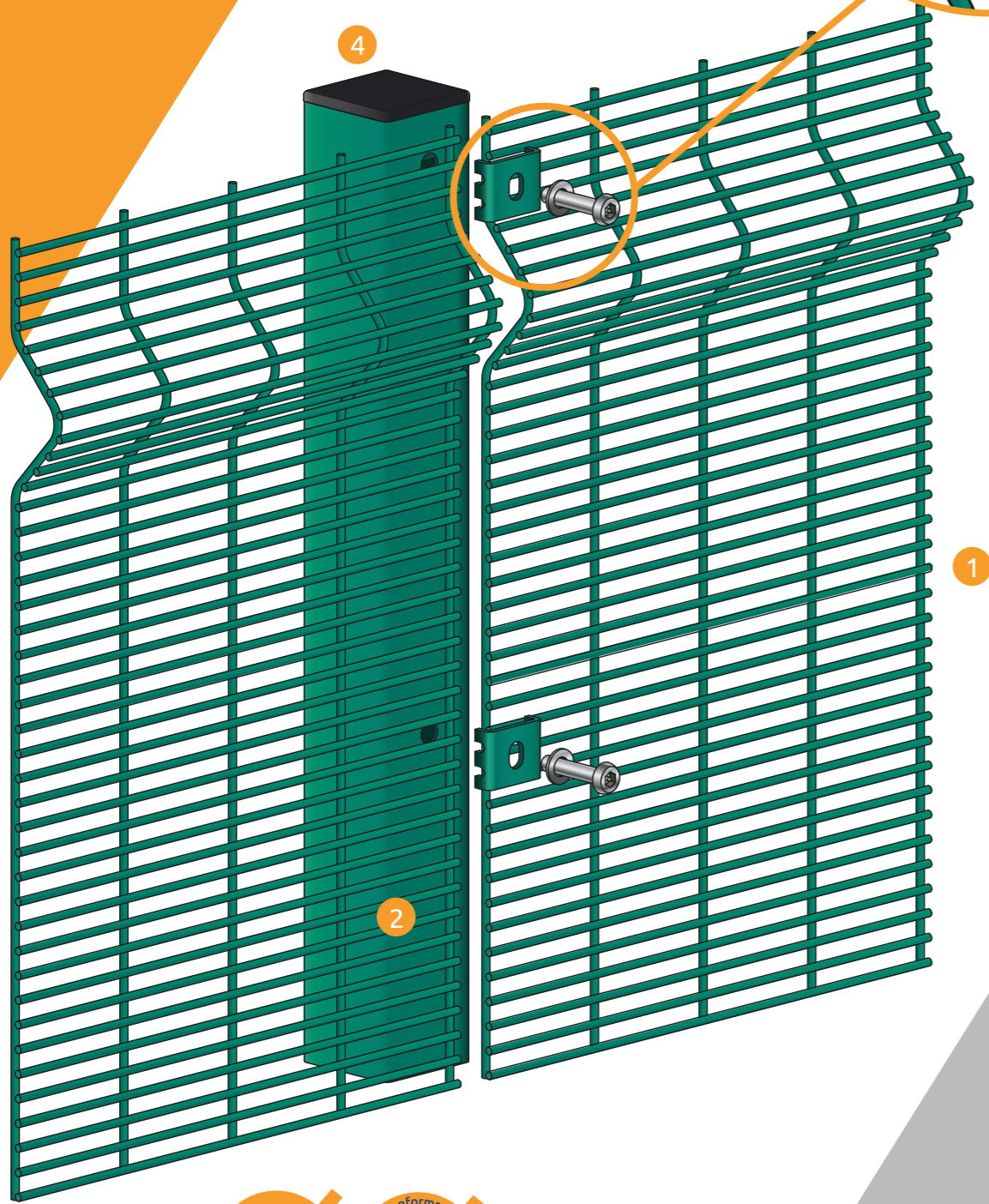
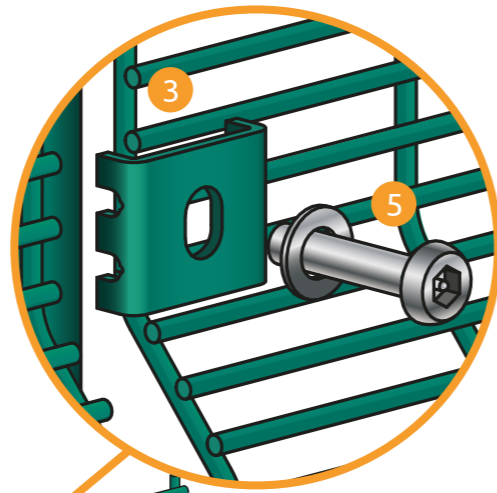

Protek 358 Profile

Profile Mesh Panel System

All the anti-climb benefits of the standard flat panel 358 prison mesh, but with triangular folds top and bottom of the panel which help to form a strong rigid fence line. The mesh is secured to the post using metal clips, and can be installed with additional anti-climb features.

Posts, Clips and Fixings

The posts and clips that Alexandra Security Limited offers provide a fixing system which secures the panels but allows for variations. The system is easy to install and allows the panels to be stepped, helping the fence line to follow the contours of the ground. With the vandal resistant security fixings this post and clip system provides a reasonable level of security to any boundary.

Product and Finish Standards

- Mesh panel wire manufactured to BS 4102 and galvanised to BS EN 10244-2:2001 class D, weld strength is 75% of the minimum tensile strength of the wire (tensile range 540-690 N/m²)
- Post material manufactured to BS EN 10210-2:1997 and galvanised to BS EN 10346:2009
- Panels & Posts are powder coated to BS EN 13438:2005 (min 100 micron)

Options

- System is available in a galvanised finish using galfan panels
- Refer to Anti-Climb section on pages 114-119 for more options for this product

Nominal Fence Height (m)	Panel Size Height x Width (m)	Overall Length of Post (mm)	Post Size (mm)	Number of Clips	
				Per Post	Per Corner
1.8	1,730 x 2,515	2,450	60 x 60	5	10
2.0	1,930 x 2,515	2,600	60 x 60	6	12
2.4	2,330 x 2,515	3,100	60 x 60	7	14
3.0	2,930 x 2,515	3,800	80 x 80	8	16

Subject to change

- 1 Mesh panel - mesh size 12.5 x 76.2mm - 4mm wire
- 2 Post size varies with height (see table)
- 3 Durable Metal Clip
- 4 Plastic cap varies with post size (see table)
- 5 M8 x 40 stainless steel security screw

Intermediate post

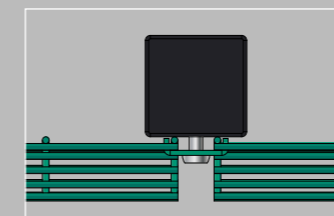

End post

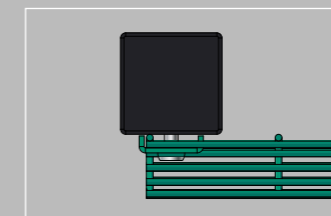

Internal corner post

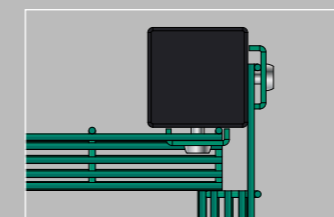

External corner post

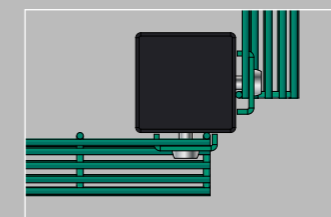

Suitable For:

High Security Facilities,
MoD Property, Industrial
Estates, Prisons



For more details on this product please visit our website:
www.alexandrasecurity.com/general-mesh