

SYSTEM DATA SHEET

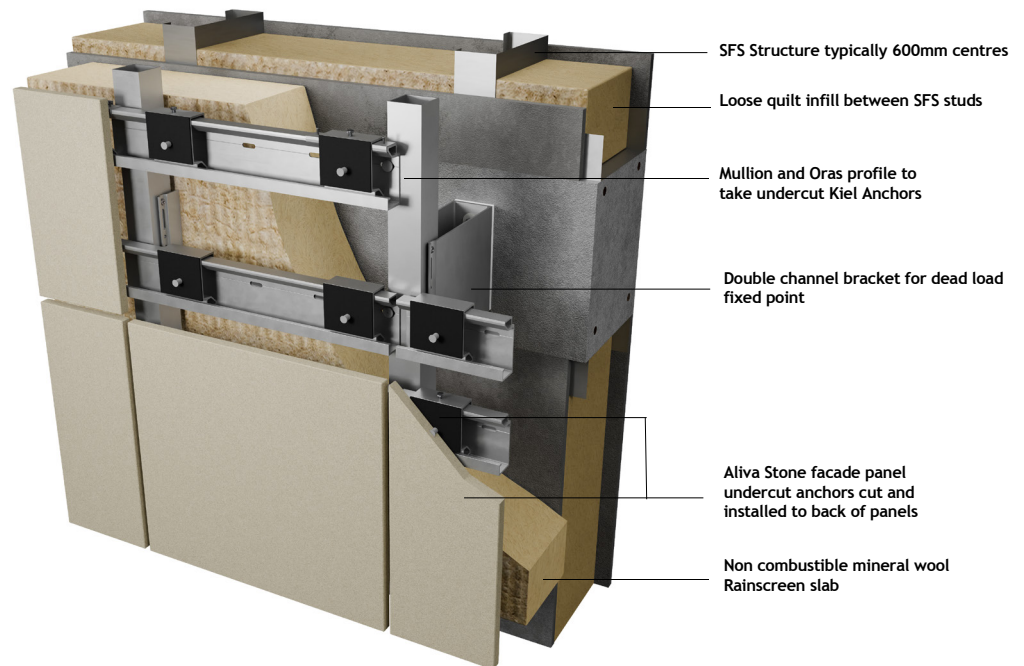

DESCRIPTION

Aliva Stone.covering is a secret anchor fix facade system that incorporates Aliva's substructure system for our stone facade cladding covering. The substructure, in aluminium extruded alloy, consists of U brackets, vertical mullions and horizontal profiles, with undercut anchors into the back of the panel. The system is available in a number of finishes, colours, complex shapes and textures.

TECHNICAL PROPERTIES



Fixing Method:

Typically fixed to Lightweight Steel Frame through the weathering Cement Particle Board, alternatively concrete structures using specified Mechanical fixings. For fixing into concrete and similar substrates pull out tests should be undertaken.

Main mullion extrusions are connected back to deadload and sliding brackets to form a substrate to enable tight and accurate installation tolerances, by means of inward and outward adjustment, to support the stone facade panels.

A support extrusion is fixed to the face of the main mullion extrusions to carry clips that lock into the back of the panel via undercut anchors.

Insulation is incorporated to provide the required thermal performance and this dictates the depth of the deadload and sliding brackets.



Design Life:

The system when installed to Specification will achieve a Design Life of in excess of 35 years.



Fire Classification:

A1 to BS EN 13501-1;2019
Surface Spread of Flame.



Accreditation/Certification:

Instituto Giordano load testing & CE Marked Stone Panels in factory.