

SYSTEM DATA SHEET

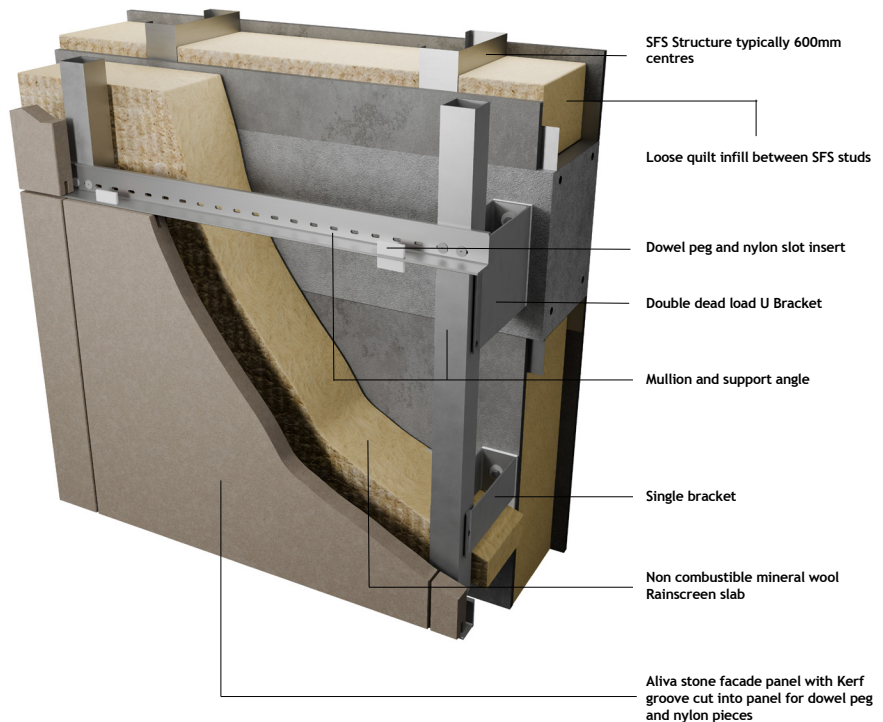

STONE.COVERING



DESCRIPTION

Aliva Stone.covering is a secret fix facade system that incorporates Aliva's substructure system for our vertically stacked stone facade cladding covering. The substructure system, in aluminium extruded alloy, consists of U brackets, vertical mullions and horizontal profiles. The Aliva stone facade panels are secured by means of pegs/dowels of stainless steel and nylon pieces that are inserted into the panel slot/kerf. The stone is available in a number of finishes, colours and textures. Panels are vertically stacked with no visible fixings.

TECHNICAL PROPERTIES



Fixing Method:

Typically fixed to Lightweight Steel Frame through the weathering Cement Particle Board, alternatively concrete structures using specified Mechanical fixings. For fixing into concrete and similar structures pull out tests for the substrates should be undertaken. Main mullion extrusions are connected back to deadload and sliding brackets to form a substrate to enable tight and accurate installation tolerances, by means of inward and outward adjustment, to support the stone facade panels. A secondary punched angle is fixed to the face of the main mullion extrusions for positioning of the pegs and dowels.



Design Life:

The system when installed to Specification will achieve a Design Life of in excess of 35 years.



Fire Classification:

A1 to BS EN 13501-1;2019 Surface Spread of Flame.



Accreditation/Certification:

CE Marked Stone Product at factory.