

SYSTEM DATA SHEET

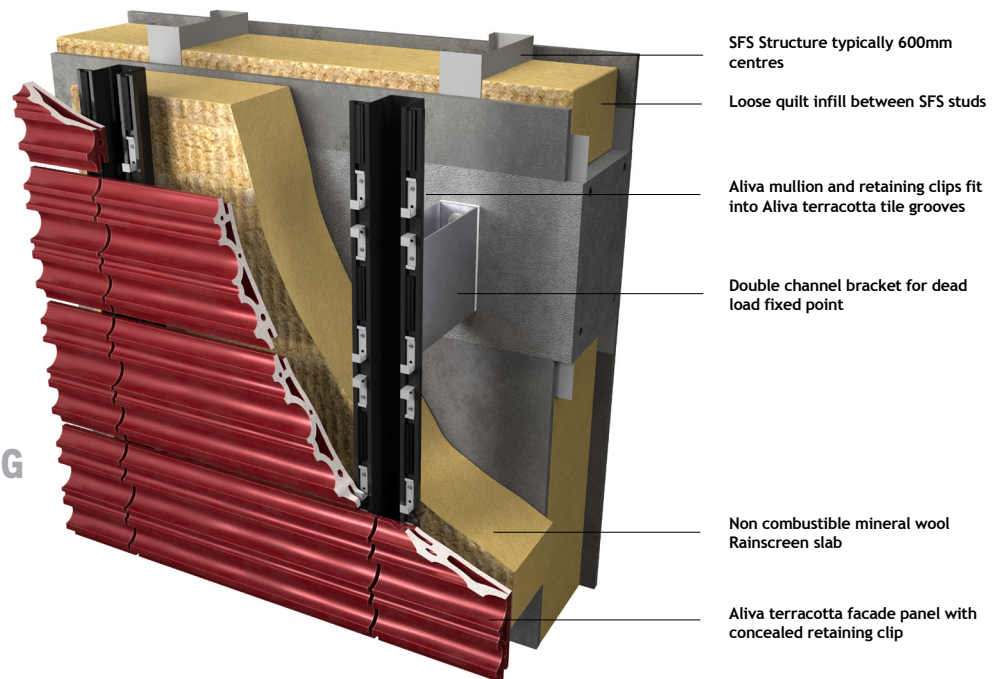

DESCRIPTION

Aliva's Terra.covering is a BBA approved secret fix facade system and aluminium substructure system, consisting of U brackets and omega section vertical mullions, with high structural strength. The vertical mullions have slots into which stainless steel clips, coloured to match the tiles, are inserted into the joints to retain the terracotta tiles, with joints of 6 or 8 mm. Terracotta panels are available in a number of finishes, colours, glazes and shapes.

TECHNICAL PROPERTIES



Fixing Method:

Typically fixed to Lightweight Steel Frame through the weathering Cement Particle Board, alternatively concrete structures using specified Mechanical fixings. For fixing into concrete and similar substrates pull out tests should be undertaken.

Main mullion extrusions are connected back to deadload and sliding brackets to form a substrate to enable tight and accurate installation tolerances, by means of inward and outward adjustment, to support the terracotta facade panels.

A support extrusion is fixed to the face of the main mullion extrusions to carry clips that slot into the joints of the terracotta panels.

Insulation is incorporated to provide the required thermal performance and this dictates the depth of the deadload and sliding brackets.



Design Life:

The system when installed to Specification will achieve a Design Life of in excess of 35 years.



Fire Classification:

A1 to BS EN 13501-1;2019
Surface Spread of Flame.



Accreditation/Certification:

BBA 13/4975.