

SYSTEM DATA SHEET

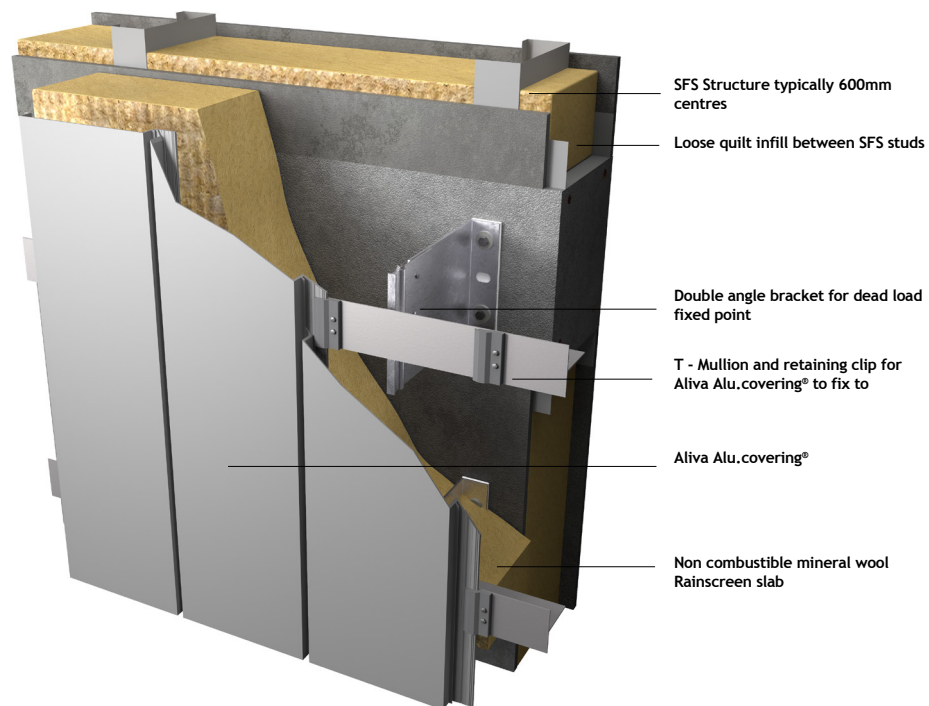

DESCRIPTION

Aliva Alu.covering® is a facade system that incorporates Aliva's substructure system for external wall build ups. The system, in aluminium extruded alloy, consists of U brackets, vertical mullions and horizontal profiles, which support the panel facade. The Aliva facade panels are secured by means of a concealed mechanism or through fixing via folded flanges. The panels are available in a number of finishes, colours and textures including durable powder coating and anodised.

TECHNICAL PROPERTIES



Fixing Method:

Typically fixed to Lightweight Steel Frame through the weathering Cement Particle Board, or can be used in a single skin application, alternatively concrete structures using specified Mechanical fixings. For fixing into concrete and similar substrates pull out tests should be undertaken.

Main mullion extrusions are connected back to deadload and sliding brackets to form a substrate to accurate installation tolerances, to allow inward and outward adjustment, to support the facade panels.

Insulation may be incorporated to provide the required thermal performance and this dictates the depth of the deadload and sliding brackets where used.

The brackets and mullion allow for making adjustment in line and level should there be any discrepancies in the main structure.



Design Life:

The system when installed to Specification will achieve a Design Life of in excess of 30 years subject to material finishes.



Fire Classification:

A1 to BS EN 13501-1;2019
Surface spread of flame subject to specified finish.



Accreditation/Certification:

BBA 13/4975 & CWCT 2013/59.