

COMPLETE GUIDE TO:

- › CURTAIN WALLING SYSTEMS
- › WINDOW SYSTEMS
- › DOOR SYSTEMS
- › GROUND FLOOR TREATMENTS
- › SLIDING DOOR SYSTEMS
- › SLIDING FOLDING DOOR SYSTEMS

Specification Guide

- › Product guide and technical information





Contents

| | |
|-------------------------------------|-----------|
| WHY ALUK? | 4 |
| THE RIGHT SERVICE | 4 |
| FROM DESIGN TO BUILD | 6 |
| COLLABORATION AT HEART | 8 |
| WORKING WITH US | 10 |
| RIBA PLAN | 10 |
| FROM CHALLENGES TO SOLUTIONS | 12 |
| SILVERSTONE CASE STUDY | 14 |
| CURTAIN WALLING SYSTEMS | 16 |
| AW86 | 18 |
| SL50 | 20 |
| SG50 | 22 |
| WINDOW SYSTEMS | 24 |
| 77IW OPEN-IN | 26 |
| 77IWE OPEN-OUT | 28 |
| C70S | 30 |
| 58BW OPEN-IN | 32 |
| 58BW OPEN-OUT | 34 |
| 58BW ST STEEL REPLACEMENT WINDOW | 36 |
| 58BW FLUSH | 38 |
| STUDENT ACCOMMODATION WINDOW | 40 |
| DOOR SYSTEMS | 42 |
| GT55 TB COMMERCIAL DOOR | 44 |
| GT55 NI COMMERCIAL DOOR | 46 |
| 58BD HI ENTRANCE DOOR | 48 |
| 77ID | 50 |
| HERITAGE DOOR | 52 |
| SLIDING DOOR SYSTEMS | 54 |
| INFINIUM | 56 |
| SC156 | 58 |
| S140 LIFT AND SLIDE | 60 |
| BSC94 HI | 62 |
| SLIDING FOLDING DOOR SYSTEMS | 64 |
| F82 PLUS | 66 |
| BSF70 HI | 68 |
| CANADA STREET CASE STUDY | 70 |

The right service – **customised, not compromised**

At AluK, we understand the challenges of modern building construction. For over 6 decades we have been working around the globe to deliver the finest tailored aluminium façade systems.

As part of AluK International, we have over 2,600 clients worldwide that have different challenges, which is why we offer different solutions wherever your project may be. We don't provide a one-size-fits-all service, we work with you, detailing the

specification your project really needs to make it the best it can be – whilst adopting a 'right first time and on-schedule' attitude.

You will also have the support of a dedicated project consultant team from design through to installation, who will advise on legislation and provide guidance throughout the RIBA Plan of Work.

Expertise, customised.



AluK GB at a glance



150+
employees



350,000 sq. ft
factory space with
500 sq. ft design studio,
based in Chepstow



4,000 sq. ft
architectural design
studio in central London



35,000
orders processed
per year



4,500 tonnes
aluminium sold per year
£190M installed value

AluK International at a glance



800+
collaborators in
13 countries



2700+
Customers in
50 countries



20,000 tonnes
produced each year



1,000,000
windows produced
with our systems



>3% of turnover
dedicated to R&D



From design to build

From our 350,000 sq. ft facility at our UK headquarters we engineer the finest, tailored aluminium façade systems – comprising of windows, doors and curtain walling. All our market-leading systems are developed and produced by our own in-house research and development team. We also design, produce and manufacture our own fittings and hardware, ensuring a seamless end result.

The facility's three thermal break assembly lines enable us to produce over 3,000,000 linear metres per year. To optimise manufacturing over 1,400 tonnes of aluminium profile is held in stock at the facility.

We are an aluminium systems house based in the UK with our own fully integrated pre-treatment and finishing line. On average 3,000 tonnes are painted per shift, per year.

Our processes also ensure there is almost zero manual handling of bars, which enables us to optimise finish quality and minimise any risk of contamination.

The capability to deliver



Dedicated
project consultant team



Global leader
in powder coating technology,
including in-house pre-
anodisation

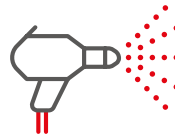

3,000,000 m
powder coating
completed per year



Marine Grade
paint as standard



3 thermal break
assembly lines



1,400 tonnes
of aluminium profile in stock,
held in the UK



End-to-end
supply of our systems
managed in-house



Investing in success

Our aluminium expertise covers both new-builds and refurbishment projects, providing you with building systems that deliver industry-leading aesthetics, performance and reliability.

To ensure efficient and effective project delivery we are committed to continual investment in first-class design tools, software and personnel. This includes BRE BIM-accredited professionals, a range of REVIT and IFC Objects, fabrication, thermal, acoustic, structural calculation and NBS Specification software.



Driven by design

Our dedicated R&D and technical teams use the latest 3D and 2D CAD technology software. This is linked to prototyping machines that ensure we are able to quickly and efficiently realise your vision, saving you valuable time and money on the project.

We have a dedicated project consultant team, who are able to provide BIM support covering in-house designed REVIT and IFC Objects. We can also offer expert guidance on buildability, thermal and acoustic project calculations, budgeting and estimating. We can also aid in learning and development through a range of RIBA-approved CPDs.

Collaboration at heart

Our Design Studios are a space for collaboration, networking, education and interaction, bringing our range of curtain walling, window and door systems to the heart of the fenestration and architectural communities.

There are currently two dedicated AluK Design Studios in the UK, one at our Chepstow HQ and the second in London.

Our studios are available for product viewing and meetings to support architects, contractors and consultants with their project design developments and specifications.

info.uk@aluk.com

Registered Office

AluK (GB) Ltd
Newhouse Farm Ind Est
Chepstow
NP16 6UD

London Office

Henry Thomas House
AluK Design Studio
5-11 Worship Street
London
EC2A 2BH



Scan to book in to
our Design Studio.



RIBA Plan of Work 2020

with AluK Consultancy benefits

AluK's Project Consultancy is a resource available to support architects and specifiers as they move through the definitive design and process management tool which is the RIBA plan of work.

Typically, our team are most often invited to get involved at stage 3 or 4 once a project has moved into developed and technical design, but experience shows us that architects and specifiers who talk to us even earlier in the plan can derive significantly more benefit.

That's not just in terms of avoiding technical problems on complex facades and unusual glazing elements, but also by adding value with straightforward advice on budget expectations, cost implications and design.



Concept Design

Architectural Concept approved by the client and aligned to the Project Brief

CORE TASKS

Preparing Architectural Concept incorporating Strategic Engineering requirements and aligned to Cost Plan. Also preparing Outline Specification. Undertake Design Reviews with client and Project Stakeholders. Finally Prepare stage Design Programme.

THE ALUK DIFFERENCE

Our clarity and expertise at Concept Design stage can help with calculating budgets and, where necessary, we can bring in trade contractors to develop an even more robust cost plan early on. Our consultants can also guide specifiers on how best to achieve regulatory requirements, by focusing on the key drivers. We can provide input on preliminary structural viability and initial acoustic, thermal and ventilation considerations for instance, as well as reviewing strategies for fire egress

and long-term maintenance. We can prepare NBS outline specifications and generate generic CAD & BIM models, samples and a detailed programme of delivery, which can be key factors in the decision-making process at Stage 2.



Spatial Coordination

Architectural and engineering information
Spatially Coordinated

CORE TASKS

Undertake Design Studies, Engineering Analysis and Cost Exercises to test Architectural Concept resulting in Spatially Coordinated design aligned to updated Cost Plan. Prepare Project Strategies and Outline Specification. Initiate Change Control Procedures and Prepare stage Design Programme

THE ALUK DIFFERENCE

At Stage 3, Aluk's consultants will guide specifiers through the information required to gain regulatory compliance, while trying to help them stick as closely as possible to their Concept Design.

If we have been involved at Stage 2, then the process is more streamlined, as issues arising around the structural design of the glazing façade and building systems will have already been considered. However, we can still make the coordination and updating of proposals fairly straightforward.

During Stage 3, the role of our consultants typically comes in more specific design and technical support. At this point, we will help develop tender information, such as project specific ventilation, thermal and acoustic specification reports, together with project specific CAD drawings and relevant BIM models. We can even provide valuable validation test data derived from our own in-house testing facility and provide updated NBS specifications into virtually any chosen format.



Technical Design

All design information required to manufacture
and construct the project completed

CORE TASKS

Develop architectural and engineering technical design, Then prepare and coordinate design team Building Systems information, whilst preparing and integrating specialist subcontractor Building Systems information. Finally Prepare stage Design Programme

THE ALUK DIFFERENCE

There is real value to be derived from working with our team, particularly if there is a requirement to consider Value Engineering on the project. We can bring together all the elements from Stage 2 & 3 and help identify opportunities for Value Engineering that might otherwise have been overlooked. We can generate alternative proposals for consideration and even invite specialist subcontractors to tender on that basis to give specifiers a direct like-for-like comparison.

An Aluk consultant at Stage 4 will always work closely with the project team and provide valuable technical and design support to help in the qualification of tenders and ensure full compliance with the specification. Again, they will help to develop the NBS and offer detailed guidance on the implementation of any Value Engineering opportunities identified.



Manufacturing and Construction

Manufacturing, construction and Commissioning completed

CORE TASKS

Finalise Site Logistics and manufacture Building Systems and construct building. Monitor progress against Construction Programme whilst Inspecting Construction Quality. Resolve Site Queries as required then Undertake Commissioning of building and prepare Building Manual

THE ALUK DIFFERENCE

In a continued support role through manufacturing and Construction stage Aluk can even ensure fabrication and installation training for all operatives and management that have not passed through our Training Academy.

From challenges to solutions

Every AluK system is tested to ensure industry performance and reliability. Each of our systems offers the following:

- › Enhanced Security – PAS 24 / BS6375
- › Secured By Design (SBD)
- › Q Mark Certification
General Performance Windows
- › CWCT Sequence B Certification
- › Factory Product Controls (FPC)
- › ISO 9001
- › ISO 14001
- › NBS
- › Council for Aluminium in Building (CAB)
- › Green Guide Ratings





Here for you

Upon project completion you will have full access to our aftersales team, who will quickly address any fabrication, installation or remedial queries.



Facility to react to remedial issues with full reporting



10 year product warranty



Team of field engineers engaging in fabrication, installation and post-installation, providing written reports for full audit trail

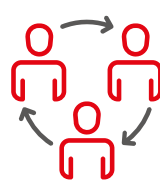

The AluK Academy trains fabricators, installers and site management staff

Case Study

Escapade Silverstone

AluK has partnered with Arkay Contractors on another landmark residential project – Escapade Silverstone, a £53m development of 44 luxury villas positioned right on the edge of the iconic British racetrack.

Designed as an investment and hospitality opportunity for serious motorsport fans, the contemporary villas are on a 14-acre site next to Copse, Maggots and Becketts, the most nail-biting corners on the circuit, and also give unbroken views over Chapel Corner and Hangar Straight.

There are a mix of trackside, dual-aspect and countryside villas on the project, all configurable as 3-4 bedroom houses or 1-2 bedroom apartments.

With some of them just 11m from the trackside fence, views and acoustics were obviously critical to the glazing specification. AluK worked closely with Twelve architects and main contractors HG Construction to refine the specification so that it delivered the slim sightlines, U-Values and acoustic performance required within the client's budget.

All the villas feature a mix of AluK **SC156** sliding doors opening up on to viewing terraces, AluK **C70S** tilt & turn and top hung windows in kitchen, bathroom and bedroom spaces and **SL52** capped curtain walling maximising the views out and the light into living spaces.



Architect: **12 Architects**

Main Contractor: **HG Construction**

Fabricator & Installer: **Arkay Contractors**

AluK Systems:

C70S Tilt Before Turn Window

Sc156 Sliding Doors

SL52 Capped Curtain Walling



There is 3200m² of glazing in total, with sightlines of just 89mm for the **C70S** windows and 50mm for centre interlock on the **SC156** sliders. U-Values are 1.4 W/m²K throughout, and 45dB acoustic glass has been fitted in the villas nearest to the track. AluK's technical team supported Arkay throughout, advising particularly on the compatibility of the systems with the thickness and weight of the acoustic glass.

Arkay Contractors were awarded the window, door and curtain walling fabrication and installation contract for Escapade Silverstone on the basis of their excellent working relationship with HG Construction and following on from their recent joint project at the £77m Canada Street development in London's docklands.

Throughout the installation our technical engineers visited site to support Arkay's contracting team and emphasise our support to AluK partners in the delivery of a project. We kept to a very efficient supply and delivery schedule so that Arkay could finish the project on time.

The Silverstone Escapade villas all feature a steel framing system with rainscreen timber cladding and luxury specification throughout – from the AluK aluminium windows and doors to the underfloor heating, comfort cooling, bespoke kitchens and ensuite bathrooms. They have been rated BREEAM 'Very Good'.



This project highlights the capabilities of AluK as a leading aluminium system supplier in the commercial project environment. Proving the level of product performance and support that we can provide alongside our installation partners throughout the RIBA stages will meet the highest standards and demands from all stakeholders to achieve a common goal. The successful delivery of outstanding buildings.



Scan to view the full case study.

Curtain Walling Systems

At AluK we understand the integral role curtain wall plays in façade design, from absorbing building sway and resisting wind to dictating thermal efficiency and controlling light. It's why our systems have been specified and installed in many of the world's most prestigious buildings.

We also appreciate the importance of flexibility in the design process. Our unique lightweight solutions offer you the freedom to bring your vision to life without compromising on the performance, functionality and safety demanded by modern buildings. They can be faceted, curved or angled to create your desired finish, with sightlines minimised to offer maximum light transmission into the building. All profiles are thermally broken to optimise performance.

We have a range of systems from unitised to stick build construction that can be built to accommodate large single span atriums, enabling impressive expanses of uninterrupted glazing. Systems are available in a range of finishes and colours for further design flexibility.

A comprehensive range of options is available for our curtain walling systems, including capped and structurally bonded systems. Fully integrated insert options include: Parallel Opening Vent (POV), Tilt-Before-Turn (TBT), Side Hung and Top Hung. Swinging and sliding doors are also available for multiple applications.

Our technical experts will provide you with comprehensive wind calculations, thermal data and safety information to enable you to turn your building design into an efficient and impactful reality.

**OUR UNIQUE SOLUTIONS
OFFER YOU THE FREEDOM TO
BRING YOUR VISION TO LIFE
WITHOUT COMPROMISING
ON THE PERFORMANCE,
FUNCTIONALITY AND SAFETY
DEMANDED BY MODERN BUILDING
SPECIFICATIONS.**



AW86 Unitised Curtain Walling System

The AW86 system has been designed and engineered to support the construction of high-rise building envelopes where unitised frames are fabricated in the factory and installed on site by crane without the use of scaffolding or external access.

On site, the installation of the unitised system enables workers to work from the inside of the building in a total safety, whilst dramatically reducing installation time and ensuring a high-quality standard of installed finished components.



DESIGN FEATURES

AW86 offers two architectural solutions:

- › The S variant in which the elements of the façade are characterised by the structural bonding of the glazing provides a frameless glass façade externally
- › The B variant in which an exterior glazing bead mechanically holds the glass. This provides a framed external façade

OPTIONS

- › Available with a range of window and door inserts including; top hung, side hung, tilt & turn, fixed light, single and double door
- › A "Split wall" option is also available. This involves placing a main grid structure, consisting of "H" frames, by means of quick-fastening components

SPECIFICATIONS

| Performance and accreditations | AW86 |
|---|------------------------------------|
| Air Permeability | 900Pa |
| Water Tightness | 1950Pa |
| Wind Resistance | 2000Pa |
| Acoustic Performance | $R_w = 42 (-2.5) \text{ dB}$ |
| CWCT Certified | BS EN 13830 |
| System | |
| Width | 86mm |
| Inserted window and door configurations | |
| Fixed Light | ✓ |
| Tilt & Turn | ✓ |
| Top Hung | ✓ |
| Side Hung | ✓ |
| Parallel Opening Window | ✓ |
| Single Door | ✓ |
| Double Door | ✓ |
| Weight limits | |
| Tilt & Turn Max. Weight | 130kg |
| Top Hung Max. Weight | 180kg |
| Side Hung Max. Weight | 55kg |
| Parallel Opening Window Max. Weight | 200kg |
| Single Door Max. Weight | 160kg |
| Glazing | |
| Glazing Options | Dependent on contract requirements |
| Glazing Thickness | Dependent on contract requirements |
| Design | |
| Drainage | Zone drained |
| Dry Glazed Option | ✓ |

CAD CROSS SECTIONS

Additional details are available on request.

► AW86S

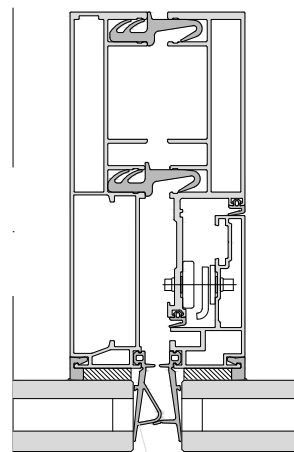

► AW86B

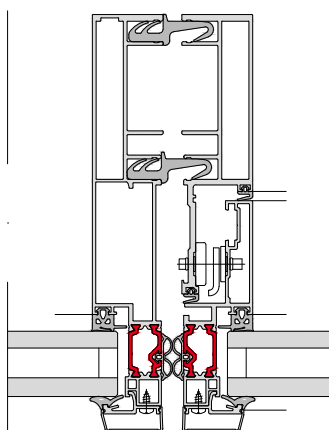

SL50 Curtain Walling System

The SL50 is a capped 'mullion drained' curtain walling system designed to offer the highest performance through a combination of profile design and thermal optimisation.

Offering complete flexibility of design and functionality, the SL50 has a range of glazing infills and face caps to suit any project. Our drainage and ventilation system, sited within glazing rebates, ensures an attractive finish with optimal weather performance.

The system is available in a variety of mullion depths, as well as an enhanced thermal performance variant. For added design flexibility, the system can be faceted, curved or sloped, and drainage can be achieved through the mullion. The system has been tested to CWCT Sequence B and has been designed to be fully integrated with AluK window, door and brise soleil systems to provide a complete façade solution.

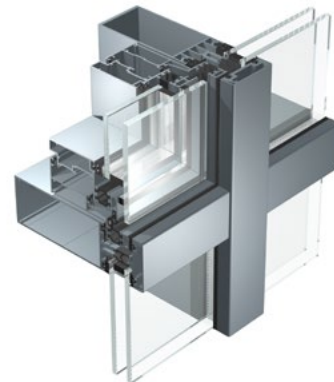

DESIGN FEATURES

- › 7.5° angles can be created with a faceted mullion without changing the glazing gasket
- › Hybrid mullion allowing a direct fix to steel / timber structures
- › Design features such as concealed vent options, purlin and eave details
- › Consistent slim 50mm sightlines throughout

OPTIONS

- › 11 mullion and 9 transom options to overcome most design challenges
- › Concealed drainage options for maximum drainage efficiency
- › Glazing and infill range from 6mm-44mm
- › Variety of face cap options
- › Slim cap options available at 2.5mm
- › Fully integrates with AluK window and door systems

SPECIFICATIONS

| Performance and accreditations | SL50 |
|--|--------------------|
| Air Permeability | Class A4 (600 Pa) |
| Water Tightness | RE1200 |
| Wind Resistance | 2400 Pa |
| Acoustic Performance | 46 dB |
| CWCT Certified | Sequence B |
| System | |
| Width | 50mm |
| Depth | 50 - 330mm |
| Inserted window and door configurations | |
| Fixed Light | ✓ |
| Tilt & Turn | ✓ |
| Top Hung | Concealed & Framed |
| Side Hung | Concealed & Framed |
| Parallel Opening Window | Concealed & Framed |
| Single Door | Swinging & Sliding |
| Double Doors | Swinging & Sliding |
| Weight limits | |
| Fixed Light Max. Weight | 690kg |
| Tilt & Turn Max. Weight | 130kg |
| Top Hung Max. Weight | 180kg |
| Side Hung Max. Weight | 55kg |
| Parallel Opening Window Max. Weight | 200kg |
| Glazing | |
| Glazing Options | Capped |
| Glazing Thickness | 6mm - 44mm |
| Design | |
| Drainage | Mullion |
| Dry Glazed Option | ✓ |
| Faceted | ✓ |
| Sloped | ✓ |
| Curved | ✓ |

CAD CROSS SECTIONS

Additional details are available on request.

► SL50 TRANSOM

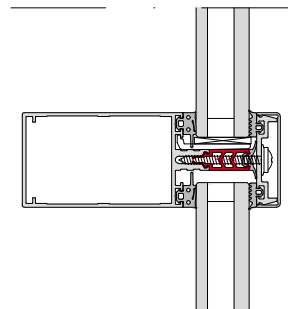

► SL50 MULLION

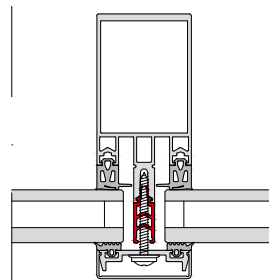

► SL50 CORNER DETAIL

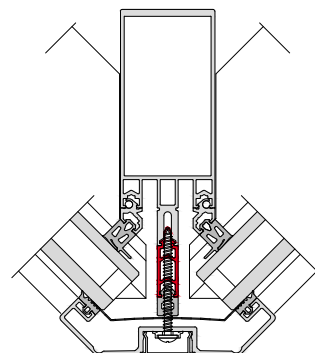

► SL50 CONCEALED VENT

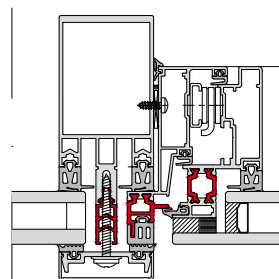

SG50 Curtain Walling System

The SG50 is a structural glazed curtain wall designed to offer optimal performance through a combination of unique profile design and thermal optimisation.

The system is available in a variety of mullion depths. For added design flexibility, the system can be faceted, curved or sloped, and drainage can be achieved through the mullion. The system has been tested to CWCT Sequence B and has been designed to be fully integrated with AluK window, door and brise soleil systems to provide a complete façade solution.

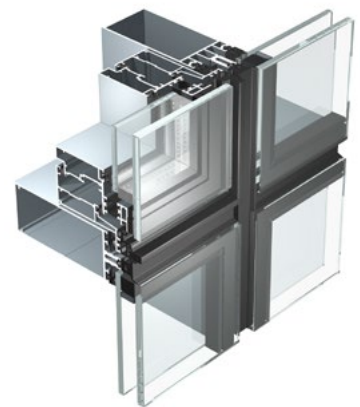

DESIGN FEATURES

- › 7.5° angles can be created with a faceted mullion without changing the glazing gasket
- › Hybrid mullion allowing a direct fix to steel / timber structures
- › Design features such as concealed vent options, purlin and eave details
- › Consistent slim 50mm sightlines throughout
- › Toggle glazed system for ease of manufacture and installation

OPTIONS

- › 11 mullion and 9 transom options to overcome most design challenges
- › Concealed drainage options for maximum drainage efficiency
- › Glazing and infill range from 6mm-44mm
- › Dry glazed or structural sealant glazing
- › Fully integrates with AluK window and door systems

SPECIFICATIONS

| Performance and accreditations | SG50 |
|--|--------------------|
| Air Permeability | Class A4 (600 Pa) |
| Water Tightness | RE1500 |
| Wind Resistance | 2400 Pa |
| Acoustic Performance | 44 dB |
| CWCT Certified | Sequence B |
| System | |
| Width | 50mm |
| Depth | 50 - 330mm |
| Inserted window and door configurations | |
| Fixed Light | ✓ |
| Tilt & Turn | ✓ |
| Top Hung | Concealed & Framed |
| Side Hung | Concealed & Framed |
| Parallel Opening Window | Concealed & Framed |
| Single Door | Swinging & Sliding |
| Double Doors | Swinging & Sliding |
| Weight limits | |
| Fixed Light Max. Weight | 320kg |
| Tilt & Turn Max. Weight | 130kg |
| Top Hung Max. Weight | 180kg |
| Side Hung Max. Weight | 100kg |
| Parallel Opening Window Max. Weight | 200kg |
| Glazing | |
| Glazing Options | Silicone or Gasket |
| Glazing Thickness | 28mm - 35mm |
| Design | |
| Drainage | Face |
| Dry Glazed Option | ✓ |
| Faceted | ✓ |
| Sloped | ✓ |
| Curved | ✓ |

CAD CROSS SECTIONS

Additional details are available on request.

➤ SG50 TRANSOM

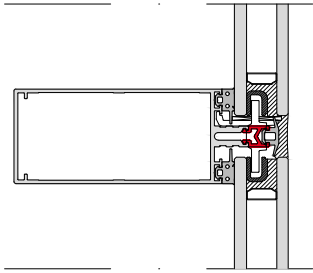

➤ SG50 MULLION

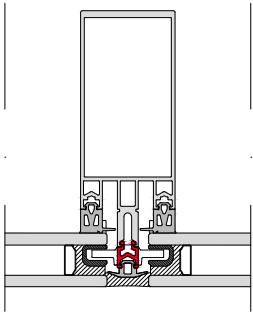

➤ SG50 CORNER DETAIL

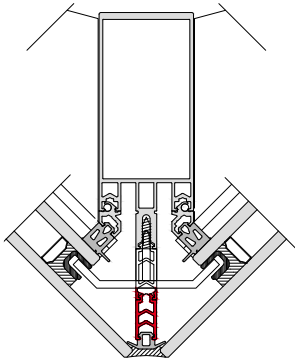

➤ SG50 CONCEALED VENT MULLION

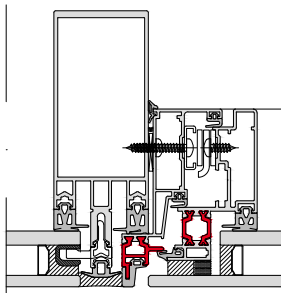

Window Systems

We understand when it comes to designing and specifying glazing solutions that performance, flexibility and security are all key drivers in the decision-making process. All our window systems are designed with advanced thermal break technology to ensure maximum comfort related to thermal, acoustic, light transmission and security – making them perfect for any commercial or residential project.

Our ongoing commitment to innovation sees us recognised as a leader in the design and manufacture of aluminium windows across the UK and beyond. This ensures when choosing our systems for your project you can be confident they will meet the aesthetic demands of building occupiers, in addition to exceeding building regulations and standards.

As with our range of aluminium systems, we don't provide a one-size-fits-all service, but instead work closely with specifiers to provide bespoke solutions designed around specific performance requirements.

All our window systems include high quality multi-point locking mechanisms alongside other key security features. Our systems are certified under the Secured by Design scheme managed by the UK Association of Chief Police Officers.

OUR WINDOWS ARE AMONG THE
MOST ADVANCED ON THE MARKET
AND PROVIDE EXCEPTIONAL
THERMAL PERFORMANCE, AS
DEMANDED BY ALL MODERN
BUILDING CONSTRUCTION.



77IW Open-In Window System

Our highest performing window, the 77IW Open-In Window System is ideal for new build and refurbishment developments. The versatility of the system also makes it suitable for use in both high-rise and low-rise buildings. The system has been specifically designed to meet the most demanding British and European performance requirements in terms of thermal, weathering and security.

A wide variety of styles and configurations are available to choose from, all of which deliver high levels of thermal performance through incorporating technologies such as thermal polyamides, insulated centre seals and foam insertions to reach passive house principles.

The 77IW system also fully integrates with our curtain walling and door systems, ensuring greater installation ease. For optimal design flexibility, the 77IW is available in single or dual colour options, including anodised finishes.

DESIGN FEATURES

- › High levels of thermal performance
- › Ability to reach passive house principles
- › Integrates with AluK curtain wall & door systems
- › Dedicated groove for EPDM mounting
- › 77mm frame depth
- › Suites with open-out system
- › Concealed window available

OPTIONS

- › Wide variety of configurations
- › Range of locking options with patented AluK Groove
- › Trickle ventilation available
- › Choice of restrictors
- › Available in single or dual colour polyester powder coating, texture and anodised finishes

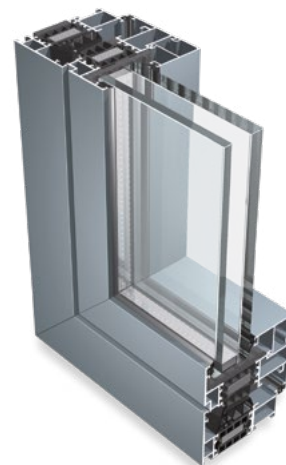

SPECIFICATIONS

| Performance and accreditations | | 77IW |
|---------------------------------|--|--------------------------------------|
| U-Value (Double Glazing) 1.0 CP | | 1.2 W/m²K |
| U-Value (Triple Glazing) 0.4 CP | | 0.8 W/m²K |
| Air Permeability | | Class 4 (600 Pa) |
| Water Tightness | | E1050 (1200 Pa) |
| Acoustic Performance | | Rw = 45 (-2;-6)dB |
| Wind Resistance | | C5 (2000 Pa) |
| Security | | PAS 24 & SBD |
| 3rd Party Certification Q-Mark | | ✓ |
| System | | |
| Depth | | 77mm |
| Configurations | | |
| Side Hung | | ✓ |
| Bottom Hung | | ✓ |
| Tilt & Turn | | ✓ |
| French Casement | | ✓ |
| Weight limits | | |
| Side Hung | | |
| Max Size (mm) | | 1400w x 2350h (See Technical Manual) |
| Min. Size (mm) | | 500w x 600h (See Technical Manual) |
| Max Weight | | 100kg (See Technical Manual) |
| Bottom Hung | | |
| Max Size (mm) | | 2000w x 1800h (See Technical Manual) |
| Min. Size (mm) | | 460w x 500h (See Technical Manual) |
| Max Weight | | 80kg (See Technical Manual) |
| Tilt & Turn | | |
| Max Size (mm) | | 1500w x 2200h (See Technical Manual) |
| Min. Size (mm) | | 460w x 550h (See Technical Manual) |
| Max Weight | | 130kg (See Technical Manual) |
| Glazing | | |
| Glazing Thickness | | 24mm – 50mm |
| System features | | |
| Single Colour | | ✓ |
| Dual Colour | | ✓ |
| Textured Finish | | ✓ |
| Anodised Finish | | ✓ |
| Locking | | Multi-Point |
| Locking Handles | | ✓ |
| Espagnolette Handle | | ✓ |
| 100mm Restriction | | ✓ |
| Trickle Ventilation | | ✓ |
| Reverse Glazing Adapter | | ✓ |
| Z-profile | | ✓ |
| Variable Angle Corner Post | | ✓ |

CONFIGURATIONS

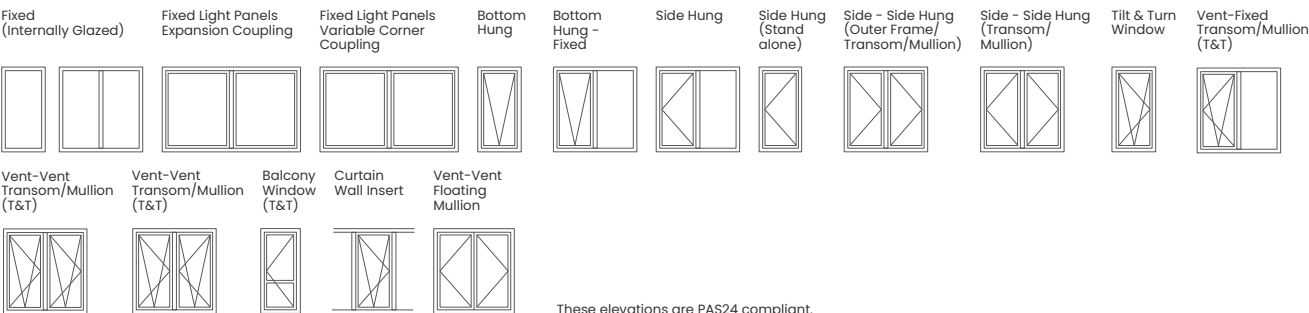

CAD CROSS SECTIONS

Additional details are available on request.

77IW VENT

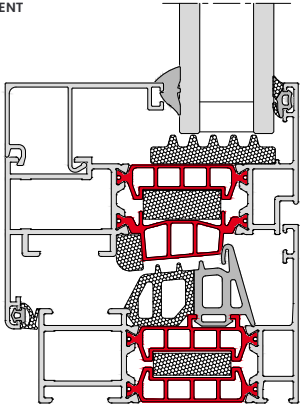

77IW FIXED LIGHT

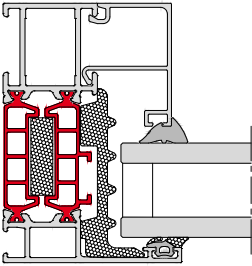

77IWE Open-Out Window System

Our high performance 77IWE Open-Out Window System is perfectly suited for a wide number of applications including hospitals, schools and high-rise apartments. The 77IWE shares the same impressive performance figures as our Open-In variant, making it our most efficient casement window.

The system is available in a wide variety of configurations, all of which offer exceptional levels of thermal performance as a result of incorporating technologies such as thermal polyamides, insulated centre seals and foam insertions. For ease of installation, the 77IWE system has been designed to fully integrate with our aluminium curtain walling and door systems.



DESIGN FEATURES

- › High levels of thermal performance
- › Multi chamber polyamide thermal breaks, insulated centre seals and foam insertions provide excellent performance
- › Integrates with AluK curtain wall and door systems
- › Dedicated groove for EPDM mounting
- › 77mm frame depth
- › Suites with 77IW open-in system

OPTIONS

- › Wide variety of configurations
- › Range of locking options with patented AluK Groove
- › Trickle ventilation available
- › Choice of restrictors
- › Available for actuators and teleflex opening options
- › Folding openers with link bar for safety
- › Available in single or dual colour polyester powder coating, texture and anodised finishes

Secured by Design



Police Preferred Specification



SPECIFICATIONS

| Performance and accreditations | 77IWE |
|---------------------------------|--------------------------------------|
| U-Value (Double Glazing) 1.0 CP | 1.2 W/m²K |
| U-Value (Triple Glazing) 0.4 CP | 0.8 W/m²K |
| Air Permeability | Class 4 (600 Pa) |
| Water Tightness | E1050 (1050 Pa) |
| Wind Resistance | C5 (2400 Pa) |
| Security | PAS 24 & SBD |
| 3rd Party Certification Q-Mark | ✓ |
| System | |
| Depth | 77mm |
| Configurations | |
| Top Hung | ✓ |
| Side Hung | ✓ |
| Bottom Hung | ✓ |
| Weight limits | |
| Top Hung | |
| Max Size (mm) | 1500w x 2400h (See Technical Manual) |
| Min. Size (mm) | 460w x 460h (See Technical Manual) |
| Max Weight | 180kg (See Technical Manual) |
| Side Hung | |
| Max Size (mm) | 838w x 2400h (See Technical Manual) |
| Min. Size (mm) | 460w x 460h (See Technical Manual) |
| Max Weight | 55kg (See Technical Manual) |
| Bottom Hung | |
| Max Size (mm) | - (See Technical Manual) |
| Min. Size (mm) | 460w x 460h (See Technical Manual) |
| Max Weight | 90kg (See Technical Manual) |
| Glazing | |
| Glazing Thickness | 24mm – 50mm |
| System features | |
| Single Colour | ✓ |
| Dual Colour | ✓ |
| Textured Finish | ✓ |
| Anodised Finish | ✓ |
| Locking | Multi-Point |
| Locking Handles | ✓ |
| Folding Openers | ✓ |
| Espagnolette Handle | ✓ |
| 100mm Restriction | ✓ |
| Trickle Ventilation | ✓ |
| Variable Angle Corner Post | ✓ |
| Reverse Glazing Adapter | ✓ |
| Z-profile | ✓ |

CONFIGURATIONS

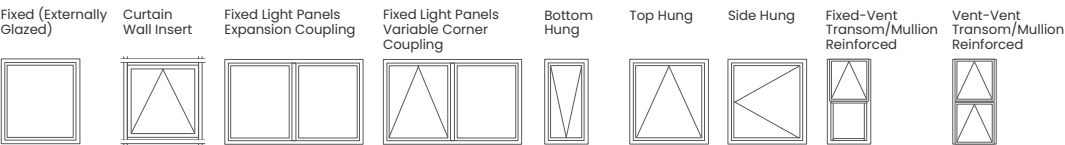

These elevations are PAS24 compliant.

CAD CROSS SECTIONS

Additional details are available on request.

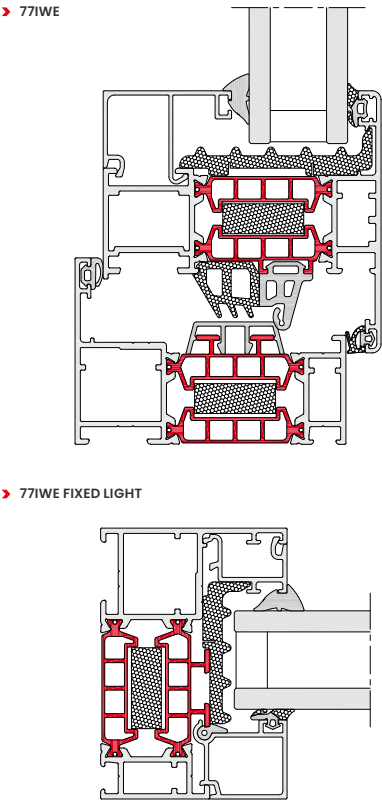

C70S

Window System

Beautifully engineered and brilliantly functional, the C70S delivers class-leading performance, advanced water tightness and a range of features to simplify fabrication and installation.

Meeting and exceeding the key thermal, acoustic and performance demands of the commercial specifiers, the C70S is the perfect aluminium solution for residential and commercial projects.

DESIGN FEATURES

- › Universal EPDM carrier groove – allows clip-in EPDM strip and direct lug fixing to be used on all outer frames, frame extenders and sub cill profiles
- › Outer Frames, Transoms/Mullions, Beads, Gaskets, Ancillary profile parts used across both Open-in and Open-out
- › Consistent sightlines with 58BW system offering maximum project flexibility

OPTIONS

- › Three levels of insulation: standard, partial and HI
- › Glazing options 24mm-50mm
- › Side Hung, Top Hung, Fixed Light & Tilt Before Turn configurations available
- › Trickle ventilation available

› Open-out Details



› Open-in Details



SPECIFICATIONS

| Performance and accreditations | C70S HI Open-in | C70S HI Open-out |
|--|----------------------|----------------------|
| Uw (Double Glazing) | 1.3W/m²k | 1.3W/m²k |
| Uw (Triple Glazing) | 1.1W/m²k | 1.1W/m²k |
| Window Energy Rating | A Rated | A Rated |
| Air Tightness (Pa) | Class 4 (600Pa) | Class 4 (600Pa) |
| Water Tightness (Pa) | E900 (900Pa) | E1500 (1500Pa) |
| Wind Load (Pa) | Class E2400 (2400Pa) | Class E2400 (2400Pa) |
| Security | PAS 24 & SBD | PAS 24 & SBD |
| Acoustic Performance | 48 (-2;-7) | 48 (-2;-7) |
| System | | |
| Depth | 70mm | 70mm |
| Configurations | | |
| Top Hung | - | ✓ |
| Side Hung | ✓ | ✓ |
| Tilt before Turn | ✓ | - |
| Bottom Hung | ✓ | ✓ |
| Internally glazed | ✓ | ✓ |
| Externally glazed | ✓ | ✓ |
| Size and weight limits | | |
| Top Hung | | |
| Max Size (mm) | 1680w x 2500h | 1680w x 2500h |
| Min. Size (mm) | 320w x 267h | 320w x 267h |
| Max Weight | 180kg | 180kg |
| Side Hung | | |
| Max Size (mm) | 1000w x 1680h | 1000w x 1680h |
| Min. Size (mm) | 300w x 320h | 300w x 320h |
| Max Weight | 55kg | 55kg |
| Tilt & Turn | | |
| Max Size (mm) | 1300w x 2300h | 1300w x 2300h |
| Min. Size (mm) | 480w x 375h | 480w x 375h |
| Max Weight | 130kg | 130kg |
| Fixed Light | | |
| Max Size (mm) | 2300w x 2300h | 2300w x 2300h |
| Min. Size (mm) | 300w x 300h | 300w x 300h |
| Max Weight | 300kg | 300kg |
| Glazing | | |
| Glazing panel options: double and triple | 24mm - 50mm | 24mm - 50mm |
| System Features | | |
| Single Colour | ✓ | ✓ |
| Dual Colour | ✓ | ✓ |
| Anodised | ✓ | ✓ |
| Textured | ✓ | ✓ |
| Groove type | PVC Euro 16mm | PVC Euro 16mm |
| Variable Handle Position | ✓ | ✓ |
| Trickle ventilation | ✓ | ✓ |
| Sightlines | 89mm | 89mm |
| Frame to Vent | 89mm | 89mm |
| Vent to Mullion | 103mm | 103mm |
| Fixed Light | 43mm | 43mm |

CONFIGURATIONS

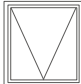
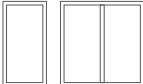
| | | | | | |
|---|---|---|---|---|---|
| Top Hung | Bottom Hung | Side Hung | Tilt & Turn | Fixed (Internally Glazed) | Fixed (Externally Glazed) |
|  |  |  |  |  |  |

CAD CROSS SECTIONS

Additional details are available on request.

➤ C70S FIXED LIGHT EXTERNAL BEAD

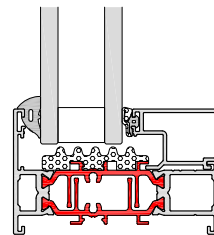

➤ C70S FIXED LIGHT INTERNAL BEAD

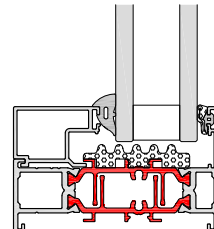

➤ C70S OPEN OUT VENT

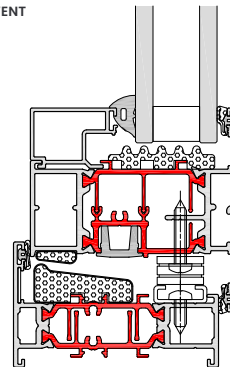

➤ C70S TBT VENT

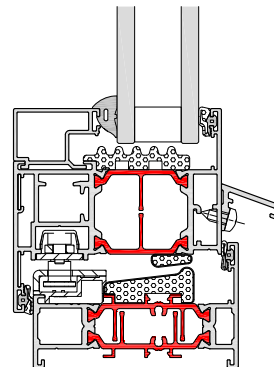

➤ C70S TBT VENT INTO SL50 CURTAIN WALL

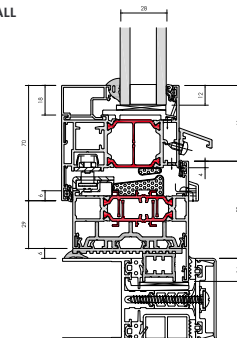

58BW HI Open-In Window System

Built to the highest UK standards, the 58BW HI Window System delivers a high performance and cost-effective solution with impressively narrow profiles. Equally at home on residential and commercial projects, the system is available in a number of formats including Side Hung and Tilt-Before-Turn.

The system's clean lines and advanced functionality meet the demands of almost every modern building construction. Its competitive pricing also makes it a highly popular choice with specifiers both in the UK and around the globe. The system is certified under Secured By Design and tested to PAS 24.

DESIGN FEATURES

- › Certified under the Secured By Design scheme
- › Tested to PAS 24
- › Integrated deep head profiles for ease of trickle ventilation
- › Tilt-Before-Turn system sightlines to match the casement window sightlines

OPTIONS

- › Available in two frame depths: 58mm or 70mm
- › Supports both open-in and open-out projects
- › Glazing 24mm-40mm
- › Available in the following configurations: Side Hung, Bottom Hung, Fixed Light, Multi-light and Tilt-Before-Turn
- › Available for Lifetime Homes (LFT)
- › Available in single or dual colour polyester powder coating, texture and anodised finishes



SPECIFICATIONS

| Performance and accreditations | 58BW TBT HI |
|--------------------------------|-----------------------|
| U-Value (Double Glazing) | 1.4 W/m²K |
| U-Value (Triple Glazing) | 1.2 W/m²K |
| Window Energy Rating (WER) | B - C |
| BRE Green Guide Rating | A rated |
| Air Permeability | Class 4 (600 Pa) |
| Water Tightness | Class 8a (600Pa) |
| Wind Resistance | Class E2400 (2400 Pa) |
| Acoustic performance | 44 (-1;-4) |
| Security | PAS 24 |
| 3rd Party Certification Q-Mark | ✓ |

System

| | |
|-------|-------------|
| Depth | 58mm & 70mm |
|-------|-------------|

Configurations

| | |
|-----------------|---------|
| Opening | Open-in |
| Top Hung | - |
| Side Hung | ✓ |
| Bottom Hung | ✓ |
| Tilt & Turn | ✓ |
| Fixed Light | ✓ |
| Multi-Light | ✓ |
| French Casement | - |

Size and weight limits

Side Hung

| | |
|---------------|-------------------------------|
| Max Size (mm) | 1725mm x 2300mm |
| Min. Size | 380mm x 575mm / 480mm x 375mm |
| Max Weight | 150kgs |

Bottom Hung

| | |
|---------------|-------------------------------|
| Max Size (mm) | 1725w x 2300mm |
| Min. Size | 380mm x 575mm / 480mm x 375mm |
| Max Weight | 150kgs |

Tilt & Turn

| | |
|----------------|-------------------------------|
| Max Size (mm) | 1725w x 2300mm |
| Min. Size (mm) | 380mm x 575mm / 480mm x 375mm |
| Max Weight | 150 kgs |

Fixed Light

| | |
|------------|-------|
| Max Weight | 250kg |
|------------|-------|

Glazing

| | |
|----------------------|---------------|
| Glazing Options | Internal Bead |
| Glazing Thickness ** | 24mm - 40mm |

System Features

| | |
|-----------------------------|-------|
| Single Colour | ✓ |
| Dual colour option | ✓ |
| Textured Finish | ✓ |
| Anodised Finish | ✓ |
| Multi-Point Locking | ✓ |
| Lifetime Homes | ✓ |
| Sightline (Frame to Vent) | 86mm |
| Sightline (Vent to Mullion) | 100mm |
| Sightline (Fixed Light) | 43mm |

CONFIGURATIONS

Top Hung



Bottom Hung



Side Hung



Tilt & Turn



Fixed Light



CAD CROSS SECTIONS

Additional details are available on request.

➤ 58BW TBT HI HEAD

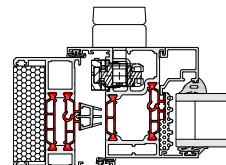

➤ 58BW TBT HI MULLION

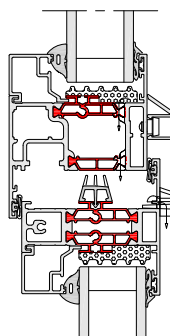
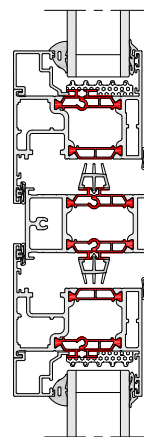

58BW HI Open-Out Window System

Built to the highest UK standards, the 58BW Window System delivers a high performance and cost-effective solution with impressively narrow profiles. Equally at home on residential and commercial projects, the system is available in a number of formats including Top Hung, Side Hung and French Casement.

The system's clean lines and advanced functionality meet the demands of almost every modern building construction. Its competitive pricing also makes it a highly popular choice with specifiers both in the UK and around the globe. In addition to being certified under Secured By Design and tested to PAS 24, the 58BW also holds a Green Guide 'A' rating.



DESIGN FEATURES

- › Certified under the Secured By Design scheme
- › Tested to PAS 24
- › Integrated deep head profiles for ease of trickle ventilation
- › Casement system sightlines to match the Tilt-Before-Turn window sightlines
- › Reverse rebate option for internal glazing throughout

OPTIONS

- › Available in two frame depths: 58mm or 70mm
- › Supports both open-in and open-out projects
- › Internally or externally glazed to accommodate low and high-rise projects
- › Glazing 23mm-40mm
- › Available in the following configurations: Top Hung, Side Hung, Bottom Hung, Fixed Light, Multi-light and French Casement
- › Available for Lifetime Homes (LFT)
- › Smoke vent certification compliance to EN12101-2:2003 Annex G
- › Available in single or dual colour polyester powder coating, texture and anodised finishes



SPECIFICATIONS

| Performance and accreditations | 58BW HI Open-Out |
|--|--------------------------|
| U-Value (Double Glazing) (Ug: 1.0 W/m²K) | 1.4 W/m²K |
| U-Value (Triple Glazing) (Ug: 0.7 W/m²K) | 1.2 W/m²K |
| Window Energy Rating (WER) | B - C |
| BRE Green Guide Rating | A Rated |
| Air Permeability | Class 4 (600 Pa) |
| Water Tightness | Class 9a (600 Pa) |
| Wind Resistance | Class E2400 (2400pa) |
| Acoustic Performance | Rw (C;Ctr) 43 (-1;-5) dB |
| Security | PAS 24 & SBD |
| 3rd Party Certification Q-Mark | ✓ |

System

| | |
|-------|-----------|
| Depth | 58 & 70mm |
|-------|-----------|

Configurations

| Opening | Open-Out |
|-----------------|----------|
| Top Hung | ✓ |
| Side Hung | ✓ |
| Bottom Hung | ✓ |
| Tilt & Turn | × |
| Fixed Light | ✓ |
| Multi-Light | ✓ |
| French Casement | ✓ |

Size and weight limits

Top Hung

| | |
|---------------|---------------|
| Max Size (mm) | 1750w x 2500h |
| Min Size (mm) | 300w x 200h |
| Max Weight | 180kg |

Side Hung

| | |
|---------------|---------------|
| Max Size (mm) | 1300w x 1750h |
| Min Size (mm) | 300w x 300h |
| Max Weight | 55kg |

Bottom Hung

| | |
|---------------|-----------------|
| Max Size (mm) | 1750w x 2500h |
| Min Size (mm) | 300w x 200h |
| Max Weight | 50kg (2 hinges) |

Fixed Light

| | |
|------------|-------|
| Max Weight | 250kg |
|------------|-------|

Glazing

| | |
|----------------------|--------------------------|
| Glazing Options | Internal & External Bead |
| Glazing Thickness ** | 23mm - 40mm |

System Features

| | |
|-----------------------------|------------------|
| Single Colour | ✓ |
| Dual Colour | ✓ |
| Textured Finish | ✓ |
| Anodised Finish | ✓ |
| Multi-Point Locking | ✓ |
| Smoke Vent Compliance | EN12101 - 2:2003 |
| Sightline (Frame to Vent) | 75mm |
| Sightline (Vent to Mullion) | 89mm |
| Sightline (Fixed Light) | 43mm |

**Glazing thickness: Other thicknesses may be possible dependant on profile combinations specified. Fabricators should refer to AluK technical manual glazing section for details.

CAD CROSS SECTIONS

Additional details are available on request.

58BW TRICKLEVENT HEAD EXTENSION

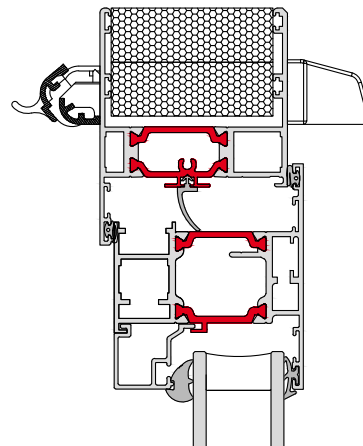

58BW MULLION TRANSOM

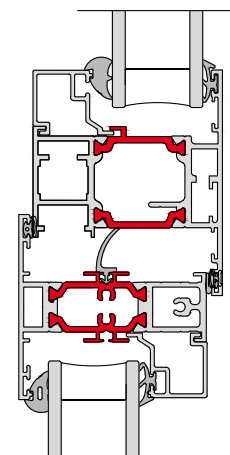

58BW BASE

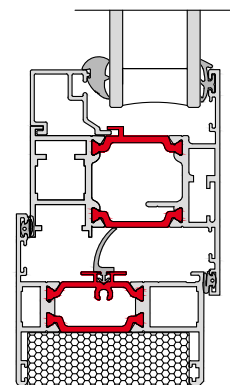

CONFIGURATIONS

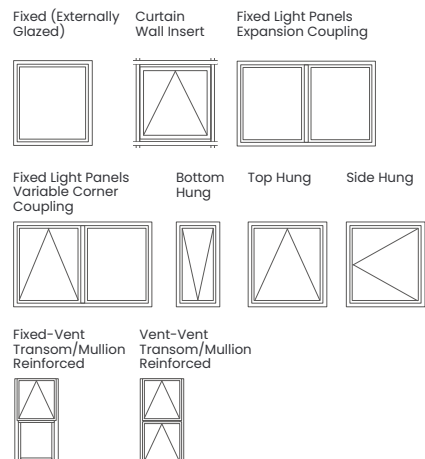

These elevations are PAS24 compliant.

58BW ST HI Steel Replacement Heritage System

Ideal for projects where planning or design requires the installation of sympathetic materials, our 58BW ST Steel Replacement Heritage Window System provides the look of steel with the benefits of aluminium. Designed to replace and complement existing steel windows, the range has been specifically developed for use on listed buildings, warehouses and similar buildings, where steel windows have always traditionally been fitted. The system can also provide a heritage aesthetic for modern and new build projects.

Available in a wide range of styles including Top Hung, Side Hung, Fixed Light and French Casement, the system cleverly replicates the narrow sight lines associated with steel windows whilst providing superior performance and security. The system also includes hardware that is sympathetic to traditional steel window designs. The range is available in a wide range of standard and RAL colours. Anodised finishes are also available, with marine grade guarantees on request.



DESIGN FEATURES

- › Slim sightlines to match existing steel windows
- › Internally and externally beaded for ease of site glazing on high-rise applications
- › Integrated deep head profiles for ease of trickle ventilation
- › Certified under the Secured By Design scheme
- › Ideal for Heritage, Listed Buildings and steel window replacements

OPTIONS

- › Accommodates up to 28mm glazing units for thermal and acoustic performance
- › Four different sash profiles to achieve design and planning permission requirements
- › Available in single or dual colour polyester powder coating, texture and anodised finishes

Secured by Design



Police Preferred Specification



SPECIFICATIONS

| Performance and accreditations | 58BW ST HI |
|--|-----------------------|
| U-Value (Double Glazing) (Ug: 1.0 W/m²K) | 1.4 W/m²K |
| U-Value (Triple Glazing) (Ug: 0.7 W/m²K) | 1.1 W/m²K |
| Window Energy Rating (WER) | A - B |
| BRE Green Guide Rating | A rated |
| Air Permeability | Class 4 (600 Pa) |
| Water Tightness | Class E1500 (1500 Pa) |
| Wind Resistance | Class E2400 (2400 Pa) |
| Acoustic Performance | 43 (-1;-5) |
| Security | PAS 24 & SBD |
| 3rd Party Certification Q-Mark | ✓ |
| System | |
| Depth | 58mm & 70mm |
| Configurations | |
| Opening | Open-Out |
| Top Hung | ✓ |
| Side Hung | ✓ |
| Bottom Hung | ✓ |
| Fixed Light | ✓ |
| Multi Light | ✓ |
| Size and weight limits | |
| Top Hung | |
| Max Size (mm) | 1436w x 1336h |
| Min. Size | 386w x 336h |
| Max Weight | 40kg |
| Side Hung | |
| Max Size (mm) | 736w x 1436h |
| Min. Size | 336w x 386h |
| Max Weight | 24kg |
| Bottom Hung | |
| Max Size (mm) | - |
| Min. Size | - |
| Max Weight | 45kg (5 hinges) |
| Fixed Light | |
| Max Size (mm) | - |
| Min. Size | - |
| Max Weight | 250kg |
| Glazing | |
| Glazing Options | Internal & External |
| Glazing Thickness** | 24mm-32mm |
| System Features | |
| Single Colour | ✓ |
| Dual Colour | ✓ |
| Textured Finish | ✓ |
| Anodised Finish | ✓ |
| Multi-Point Locking | ✓ |
| Sightline (Frame To vent) | 66mm |
| Sightline (Vent To Mullion) | 81mm |
| Sightline (Fixed Light) | 43mm |
| Aesthetics | |
| Putty Line | ✓ |
| Stepped Edge | ✓ |
| Square | ✓ |
| Exterior Glazed Chamfer | ✓ |

CAD CROSS SECTIONS

Additional details are available on request.

58BW ST HI HEAD

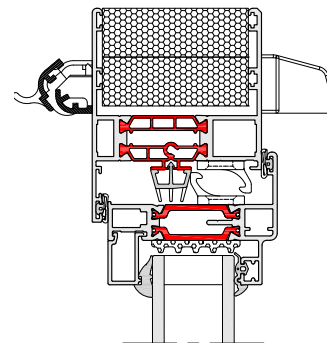

58BW ST HI JAMB

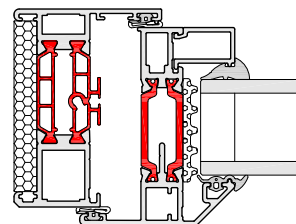

58BW ST HI MULLION

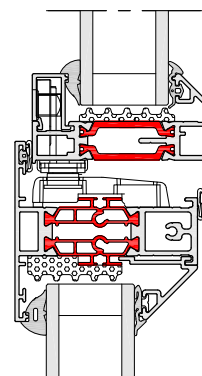

CONFIGURATIONS

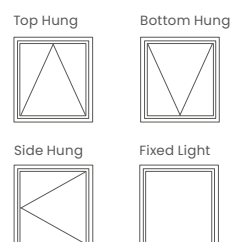

**Glazing thickness: Other thicknesses may be possible dependant on profile combinations specified. Fabricators should refer to AluK technical manual glazing section for details.

58BW Flush HI Window System

The 58BW Flush window combines minimal sightlines and maximum weather resistance with all the best features of the tried and trusted 58BW range: advanced performance, versatility and security. With a choice of slim sashes and a range of configuration options, the flush finish and slim sightlines of the 58BW Flush make this the perfect choice for contemporary new-build and refurbishment projects.

A double rebate provides market-leading weather performance, even in more exposed locations, and the 58BW Flush utilises common hardware with the existing 58BW window ranges to ensure it can withstand a range of weather conditions. The 58BW Flush shares the same sashes, features and hardware with the 70mm frame option for the 58BW suite, making it quicker and easier to fabricate.

DESIGN FEATURES

- › Advanced weather performance
- › Slimmer sightlines – 45mm ultra-slim sash suits a range of property styles
- › Certified under the Secured by Design scheme
- › Tested to PAS 24

OPTIONS

- › Open-out sashes including top and side-hung.
- › The flush shadow line can be complemented with a choice of flat, putty line or stepped edge (crittal style) vent styles to suit the property
- › Available in a range of standard and RAL colours.



Secured by Design



Police Preferred Specification



SPECIFICATIONS

| Performance and accreditations | 58BW FLUSH HI |
|-------------------------------------|-----------------------|
| U-Value (Double Glazing) | 1.4 W/m²K |
| U-Value (Triple Glazing) | 1.2 W/m²K |
| Window Energy Rating (WER) | B - C |
| BRE Green Guide Rating | A rated |
| Air Permeability | Class 4 (600 Pa) |
| Water Tightness | Class 9a (600Pa) |
| Wind Resistance | Class E2400 (2400 Pa) |
| Security | PAS 24 |
| 3rd Party Certification Q-Mark | ✓ |
| System | |
| Depth | 70mm |
| Configurations | |
| Opening | Open-Out |
| Top Hung | ✓ |
| Side Hung | ✓ |
| Bottom Hung | ✓ |
| Dummy Sashes | ✓ |
| Fixed Light | ✓ |
| Multi Light | ✓ |
| French Casement | ✓ |
| Size and weight limits | |
| Top Hung | |
| Max Size (mm) | 1750w x 2500h |
| Min. Size | 300w x 350h |
| Max Weight | 180kg |
| Side Hung | |
| Max Size (mm) | 1300w x 1750h |
| Min. Size | 300w x 300h |
| Max Weight | 55kg |
| Fixed Light | |
| Max Size (mm) | - |
| Min. Size | - |
| Max Weight | 250kg |
| Glazing | |
| Glazing Options | Internal & External |
| Glazing Thickness** | 24mm-40mm |
| System Features | |
| Single Colour | ✓ |
| Dual Colour | ✓ |
| Textured Finish | ✓ |
| Anodised Finish | ✓ |
| Multi-Point Locking | ✓ |
| Sightline (Frame to Vent) | 98mm |
| Sightline (Vent to Mullion to Vent) | 113mm |
| Sightline (Dummy Sash) | 158mm |
| Sightline (Fixed Light) | 53mm |

**Glazing thickness: Other thicknesses may be possible dependant on profile combinations specified. Fabricators should refer to AluK technical manual glazing section for details.

CAD CROSS SECTIONS

Additional details are available on request.

58BW FLUSH HI HEAD

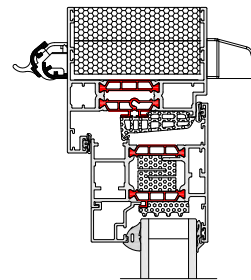

58BW FLUSH HI JAMB

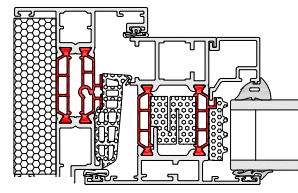

58BW FLUSH HI MULLION

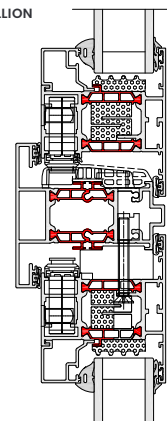

58BW FLUSH HI WITHOUT HANDLES

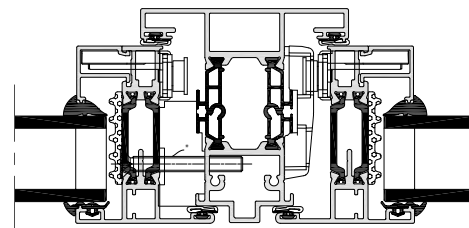

CONFIGURATIONS

Fixed (Externally Glazed) Curtain Wall Insert Fixed Light Panels Expansion Coupling

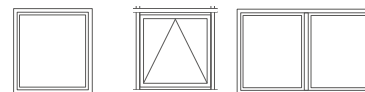

Fixed Light Panels Variable Corner Coupling Bottom Hung Top Hung Side Hung



Fixed-Vent Transom/Mullion Reinforced Vent-Vent Transom/Mullion Reinforced



These elevations are PAS24 compliant.

Student Accommodation Window

The Student Accommodation Window System is uniquely designed to create uniformed interfaced details. Ideal for both low-rise and high-rise projects that require purge ventilation, the system can use a range of ventilation inserts including: perforated panels, grills, aluminium louvres and timber slats, as well as bespoke design panels.

Designed in line with the 58BW window series, the system maintains the same high performance, sightlines and aesthetics and can be integrated with all AluK systems.



DESIGN FEATURES

- › No mechanical fixings required for the louvre, which is held within the glazing rebate
- › Certified under the Secured By Design scheme
- › Inward opening
- › Maintains the same sightlines as the 58BW series
- › Integrated with AluK systems
- › 94mm frame depth
- › Concealed hardware (no visible hinges)
- › Multi-point locking

OPTIONS

- › Available for Lifetime Homes (LFT)
- › Ventilation insert options include: perforated panels, grills, louvres, timber slats and bespoke design ventilation panels
- › Configurations include Tilt-Before-Turn, Side Hung and Bottom Hung
- › Multi-point locking
- › Glazing 24mm–40mm
- › Available in single or dual colour polyester powder coating, texture and anodised finishes

SPECIFICATIONS

Performance* and accreditations

| | |
|--|-----------------------|
| U-Value (Double Glazing) (Ug: 1.0 W/m²K) | 1.6 W/m²K |
| U-Value (Triple Glazing) (Ug: 0.7 W/m²K) | 1.4 W/m²K |
| Air Permeability | Class 4 (600 Pa) |
| Water Tightness | Class 8a (450 Pa) |
| Wind Resistance | Class E2400 (2400 Pa) |
| Weather Performance | (BS 6375: 1-3) |
| Security | PAS 24 & SBD |
| 3rd Party Certification Q-Mark | ✓ |

SYSTEM

| | |
|-------|------|
| Depth | 97mm |
|-------|------|

Configurations

| | |
|-------------|---------|
| Opening | Open-In |
| Side Hung | ✓ |
| Bottom Hung | ✓ |
| Tilt & Turn | ✓ |
| Fixed Light | ✓ |

Size and weight limits

| | |
|------------------|---------------|
| Side Hung | |
| Max Size (mm) | 1725w x 2300h |
| Min. Size (mm) | 380w x 575h |
| Max Sash Area | 3m² |
| Max Weight | 100kg |

| | |
|--------------------|---------------|
| Bottom Hung | |
| Max Size (mm) | 1725w x 2300h |
| Min. Size (mm) | 380w x 575h |
| Max Sash Area | 3m² |
| Max Weight | 100kg |

| | |
|------------------------|---------------|
| Tilt & Turn | |
| Max Size (mm) | 1725w x 2300h |
| Min. Size (mm) | 380w x 575h |
| Max Sash Area | 3m² |
| Max Weight | 150kg |

Glazing

| | |
|-------------------|-----------|
| Glazing Thickness | 24mm-40mm |
|-------------------|-----------|

System Features

| | |
|------------------------------|---|
| Single Colour | ✓ |
| Dual Colour | ✓ |
| Textured Finish | ✓ |
| Anodised Finish | ✓ |
| Punched Out Openings | ✓ |
| 100mm Restriction | In Tilt Mode or with Separate Restrictor Fitted |
| Trickle Ventilation | ✓ |
| Multi-Point / Single Locking | Wrap Around Perimeter Locking |
| Standard Hardware Groove | Euro Groove |
| Locking Handles | ✓ |
| Hinges | Concealed Hinges |

CAD CROSS SECTIONS

Additional details are available on request.

STUDENT ACCOMMODATION WINDOW MULLION

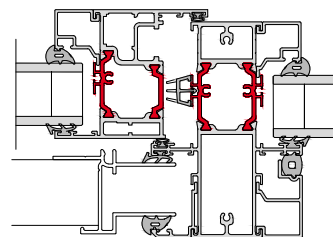

STUDENT ACCOMMODATION WINDOW HEAD

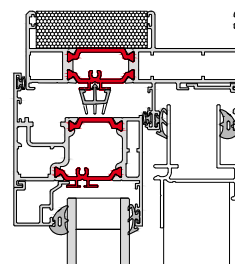

STUDENT ACCOMMODATION WINDOW JAMB

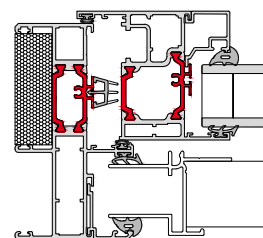

STUDENT ACCOMMODATION WINDOW CILL

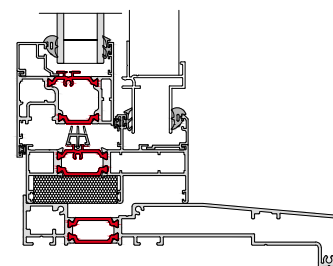

Sectional information shows external louvre panel to opening vent locations. Other options are available

CONFIGURATIONS

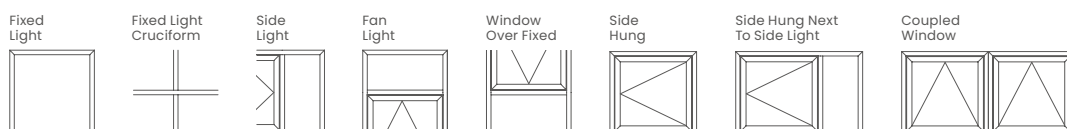

Doors and Ground Floor Treatments

For over six decades we have worked across the UK and around the globe to deliver performance-driven aluminium solutions. Our wealth of experience means we understand the challenges of modern building construction, and that every project demands a unique solution.

Our commitment to delivering innovative, bespoke systems has seen us recognised as an industry leader in the design and manufacture of aluminium doors.

AluK systems are widely used across a range of sector applications including: healthcare, education, accommodation, multi-residential, leisure and retail. Our aluminium doors are inherently strong and offer exceptional flexibility, reliability and security. They are also near maintenance-free and can last up to six times longer than other building materials, helping you meet ever-tightening building and environmental legislation.

Each and every one of our systems is certified under the Secured By Design scheme managed by the UK Association of Chief Police Officers. All feature high quality multi-point locking mechanisms in addition to a wealth of other leading security features for added peace of mind. This, coupled with the natural strength of aluminium itself, ensures our doors are among the most robust and secure available on the market today.

A wide variety of configurations, functions and design features are available when specifying, guaranteed to both enhance and complement your designs. Our dedicated project team will also work closely with you to provide a bespoke specification that meets your unique performance requirements.

**THIS ENSURES YOU HAVE THE
FREEDOM TO BRING COMMERCIAL
AND RESIDENTIAL DESIGNS TO LIFE
WITHOUT EVER COMPROMISING
PERFORMANCE FOR STYLE, OR
AESTHETICS FOR EFFICIENCY.**

Vis
Entr
Ymwl
!
Entr



GT55 TB

Commercial Door

An effective choice for shop fronts, entrances and ground floor treatments, the GT55 TB provides exceptional security and performance. Delivering high levels of energy efficiency thanks to its thermally broken profiles, the system has been designed to provide a flexible solution for low-rise glazing applications.

The system offers PAS 24 rating and is Secured By Design-accredited across a suite of configurations including single and double doors, screening, and side and fan lights. It also features a range of PAS 24 hardware including panic, mechanical and electro-mechanical locking for both single and double doors. Easily integrated with other AluK systems, the GT55 TB includes an integrated range of high traffic, anti-finger trap doors.



DESIGN FEATURES

- › Pocket or bead glazed for ease of site glazing
- › Slim 55mm profile width for increased glazing and light transmission
- › Fully compatible with other AluK systems
- › The most comprehensive PAS 24 and Secured By Design certified system on the market today
- › Robust mechanical connection detail for ultimate strength in high traffic environments
- › GT55 TB can be used to create louvred and panelled doors with a variation of inserts

OPTIONS

- › Wide range of hardware available offering full customisation
- › Available in single or dual colour polyester powder coating, texture and anodised finishes
- › Ability to accommodate various architectural pull handles from other manufacturers

Secured by Design



Police Preferred Specification



SPECIFICATIONS

| Performance and accreditations | Single | Double | GT55 TB Screening |
|---|---------------|---------------|-----------------------|
| U-Value (Double Glazing) (Ug: 1.0 W/m²K) | 1.7 W/m²K | 1.8 W/m²K | 1.4 W/m²K |
| U-Value (Triple Glazing) (Ug: 0.7 W/m²K) | 1.5 W/m²K | 1.6 W/m²K | 1.1 W/m²K |
| Air Permeability | - | - | Class 4 (600 Pa) |
| Water Tightness | - | - | Class E1200 (1200 Pa) |
| Wind Resistance | - | - | Class B4 (1600 Pa) |
| Security | PAS 24 & SBD | PAS 24 & SBD | PAS 24 & SBD |
| 3rd Party Certification Q-Mark | ✓ | ✓ | ✓ |
| System | | | |
| Depth | 110mm | 110mm | 110mm |
| Size and weight limits | | | |
| Maximum Door Leaf Size (mm) | 1200w x 2400h | 1200w x 2400h | - |
| Maximum Door Leaf Weight | 110kg | 110kg | - |
| Glazing | | | |
| Glazing Thickness (Single Glazing) | - | - | 6mm - 12mm |
| Glazing Thickness (Double Glazing) | 24mm - 40mm | 24mm - 40mm | 26mm - 30mm |
| System Features | | | |
| Single Colour | ✓ | ✓ | ✓ |
| Dual Colour | ✓ | ✓ | ✓ |
| Textured Finish | ✓ | ✓ | ✓ |
| Anodised Finish | ✓ | ✓ | ✓ |
| Thermally Broken | ✓ | ✓ | ✓ |
| Fire Exit option | ✓ | ✓ | ✓ |
| Part M compliant low threshold | ✓ | ✓ | - |
| Part M compliant closer | ✓ | ✓ | ✓ |
| Anti-Finger Trap | ✓ | ✓ | - |
| Sightlines | 145mm | 176mm | 55mm |
| Mid-Rail and Lay Bar | ✓ | ✓ | ✓ |
| Panel Door | ✓ | ✓ | - |
| Multi-Point Locking | ✓ | ✓ | - |
| Single Point Locking | ✓ | ✓ | - |
| Concealed Hinges | ✓ | ✓ | - |
| Electro Mechanical Locking | ✓ | ✓ | - |

SBD CONFIGURATIONS

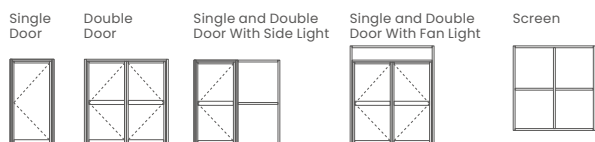

PAS 24 SECURITY RATED

| Accessibility options | Single Door | | Double Door | |
|---------------------------------------|-------------|---------|-------------|---------|
| | Max (w) | Max (h) | Max (w) | Max (h) |
| Electronic access locking | 1200 | 2400 | 1200 | 2400 |
| Panic Doors | 1200 | 2400 | 1200 | 2400 |
| Electronic access panic doors (Dorma) | 1200 | 2400 | 1200 | 2400 |
| Manual locking | 1000 | 2400 | 1000 | 2400 |

CAD CROSS SECTIONS

Additional details are available on request.

GT55 TB JAMB WITH MULTI POINT LOCK

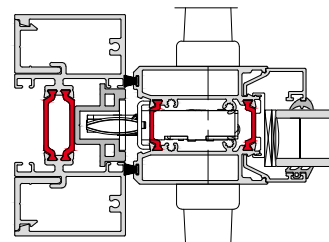

GT55 TB LOW THRESHOLD

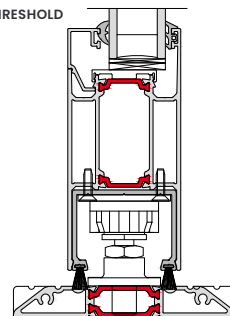

GT55 TB JAMB WITH ANTI FINGER TRAP

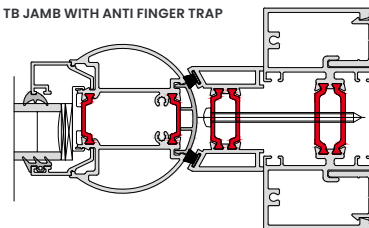

GT55 TB MEETING STILE

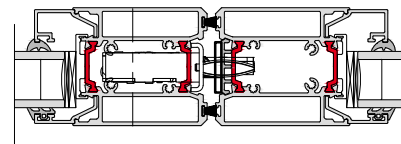

GT55 TB SCREEN CILL

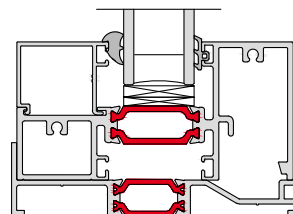

GT55 TB SCREEN MULLION

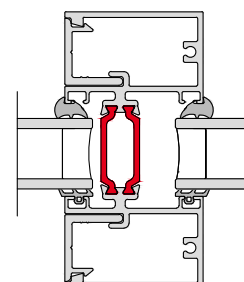



GT55 NI Commercial Door

One of the most secure swing doors available on the market today, the GT55 NI has been specifically designed for high traffic environments where no insulation is required. This makes it a very robust and highly cost-effective choice when specifying applications such as shopping complexes and retail centres that require significant partitioning without the need for thermal insulation.

The GT55 NI can be easily integrated with our ground floor treatment system and is available in single colour options, with a choice of polyester powder coating and anodised finishes. A full range of security and customisable hardware is also available to suit the specific demands of your design.

DESIGN FEATURES

- › Pocket or bead glazed for ease of site glazing
- › Slim 55mm frame profile for increased glass appearance
- › Ladder frame construction to enable easy on-site installation
- › Fully compatible with other AluK systems
- › Mullion drainage

OPTIONS

- › Can accommodate 6mm–28mm sealed units for acoustic performance
- › Wide range of hardware available offering full customisation
- › Available in single colour polyester powder coating, texture and anodised finishes
- › Internal and external screen application available



Secured by Design



Police Preferred Specification



SPECIFICATIONS

| Performance and accreditations | Single | Double | GT55 NI Screening |
|---|---------------|---------------|-------------------|
| U-Value (Double Glazing) (Ug: 1.0 W/m²K) | 3.6 W/m²K | 3.0 W/m²K | 2.0 W/m²K |
| Air Permeability | - | - | Class 4 (600 Pa) |
| Water Tightness | - | - | Class 8A (450 Pa) |
| Wind Resistance | - | - | Class 5 (2000 Pa) |
| Durability EN 1191 Category | 50,000 Cycles | 50,000 Cycles | - |
| Security | PAS 24 & SBD | PAS 24 & SBD | PAS 24 & SBD |
| System | | | |
| Depth | 110mm | 110mm | 110mm |
| Size and weight limits | | | |
| Maximum Door Leaf Size (mm) | 1250w x 2400h | 2500w x 2400h | - |
| Maximum Door Leaf Weight | 80kg | 80kg | - |
| Glazing | | | |
| Glazing Thickness (Single Glazing) | 6mm - 12mm | 6mm - 12mm | 6mm - 12mm |
| Glazing Thickness (Double Glazing) | 24mm - 28mm | 24mm - 28mm | 24mm - 28mm |
| System Features | | | |
| Single Colour | ✓ | ✓ | ✓ |
| Dual Colour | x | x | x |
| Textured Finish | ✓ | ✓ | ✓ |
| Anodised Finish | ✓ | ✓ | ✓ |
| Fire Exit option | ✓ | ✓ | ✓ |
| Part M compliant low threshold | ✓ | ✓ | - |
| Anti-Finger Trap | ✓ | ✓ | - |
| Sightlines | 144mm | 176mm | 55mm |
| Mid-Rail and Lay Bar | ✓ | ✓ | ✓ |
| Panel Door | ✓ | ✓ | - |
| Single Point Locking | ✓ | ✓ | - |
| Concealed Hinges | ✓ | ✓ | - |
| Barrel Hinges | ✓ | ✓ | - |
| Electro Mechanical Locking | ✓ | ✓ | - |
| Automatic Door | ✓ | ✓ | - |

SBD CONFIGURATIONS



CAD CROSS SECTIONS

Additional details are available on request.

GT55 NI JAMB LOCKING STILE

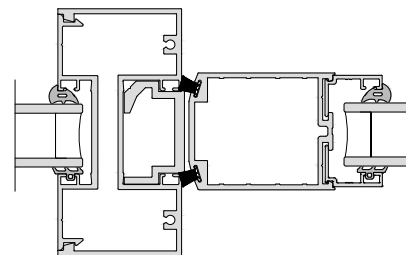

GT55 NI MEETING STILE

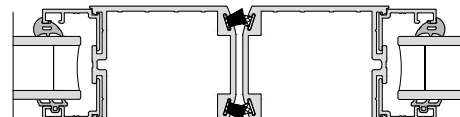

GT55 NI SCREEN CILL

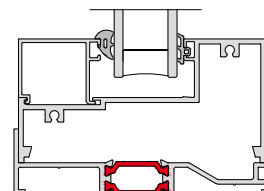

GT55 NI SCREEN MULLION

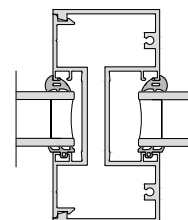

GT55 NI JAMB ANTI FINGER TRAP

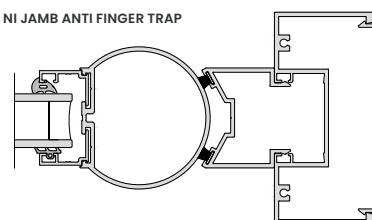

GT55 NI LOW THRESHOLD

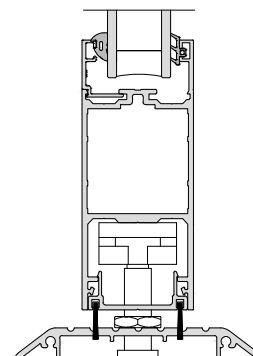

58BD HI Door System

Suitable for both new build and refurbishment projects, the 58BD is ideal for light and medium-duty use and is available in a wide range of styles and formats. Designed for optimal security and flexibility, every door in the range is available in single and double configurations.

Certified under Secured By Design and fully PAS 24 tested, the system includes glazing options of 24mm–40mm with two frame depths available: 58mm or 70mm. The 58BD is available in single or dual colour options, with a choice of anodised finishes also available.

DESIGN FEATURES

- › Certified under the Secured By Design scheme
- › Tested to PAS 24
- › Multi-point locking mechanism
- › Suites with window profile to give ultimate design flexibility
- › Slim profile design

OPTIONS

- › Glazing 24mm–40mm
- › Available in two frame depths, 58mm or 70mm, to accommodate varying types of applications
- › Available in single or dual colour polyester powder coating, texture and anodised finishes
- › Available for new build or refurbishment projects
- › Available in single or double door configuration
- › Available in open-in and open-out options



SPECIFICATIONS

| | Single Open-In | Single Open-Out | Double Open-In | Double Open-Out |
|---|-----------------------|---------------------------|-----------------------|-----------------------|
| Performance*and accreditations | | | | |
| U-Value (Double Glazing) (Ug: 1.0 W/m²K) | 1.3 W/m²K | 1.3 W/m²K | 1.3 W/m²K | 1.3 W/m²K |
| U-Value (Triple Glazing) (Ug: 0.7 W/m²K) | 1.1 W/m²K | 1.1 W/m²K | 1.1 W/m²K | 1.1 W/m²K |
| Air Permeability | Class 4 (600 Pa) | Class 4 (600 Pa) | Class 3 (600 Pa) | Class 3 (600 Pa) |
| Water Tightness | Class 3a (100 Pa) | Class 7a (300 Pa) | Class 7a (300 Pa) | Class 9a (600 Pa) |
| Wind Resistance | Class A3 (1200 Pa) | Class AE2400 (2400 Pa) | Class A3 (1200 Pa) | Class A4 (1600 Pa) |
| System | | | | |
| Depth | 58mm - 70mm | 58mm - 70mm | 58mm - 70mm | 58mm - 70mm |
| Size and weight limits | | | | |
| Max door size per leaf | 1200w x 2400h | 1200w x 2400h | 1200w x 2400h | 1200w x 2400h |
| Max door weight per leaf | 90kg | 90kg | 90kg | 90kg |
| Glazing | | | | |
| Glazing Thickness | 24mm-40mm | 24mm-40mm | 24mm-40mm | 24mm-40mm |
| System Features | | | | |
| Single Colour | ✓ | ✓ | ✓ | ✓ |
| Dual Colour | ✓ | ✓ | ✓ | ✓ |
| Textured Finish | ✓ | ✓ | ✓ | ✓ |
| Anodised Finish | ✓ | ✓ | ✓ | ✓ |
| Thermally Broken | ✓ | ✓ | ✓ | ✓ |
| Sightline (Head) | 129.5mm | 129.5mm | 129.5mm | 129.5mm |
| Sightline (Cill) low threshold | 111mm | 111mm | 111mm | 111mm |
| Sightline (Jamb) | 129.5mm | 129.5mm | 129.5mm | 129.5mm |
| Sightline (Meeting Stile) | n/a | n/a | 209.5mm | 209.5mm |
| Panel Door | ✓ | ✓ | ✓ | ✓ |
| Multi-Point Locking | ✓ | ✓ | ✓ | ✓ |
| Low Threshold | ✓ | ✓ | ✓ | ✓ |

CONFIGURATIONS

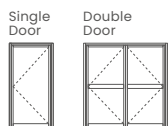

CAD CROSS SECTIONS

Additional details are available on request.

58BD HI CILL

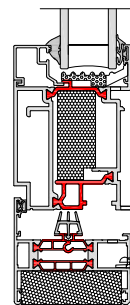

58BD HI JAMB

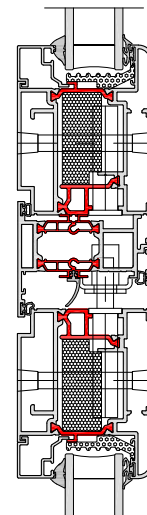

58BD HI HINGE JAMB

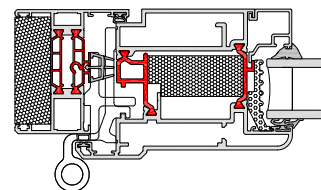

58BD HI LOCK JAMB

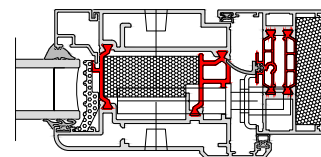

58BD HI LOW THRESHOLD

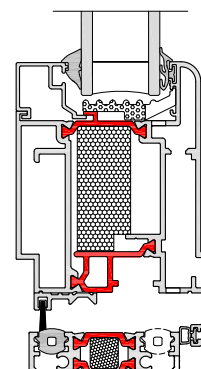

* Performance data based on CEN size for Building Regulations. For full test performance details please contact Technical Services.
AluK recommends checking all system performance for any scheme prior to use.

77ID Fully Rebated Door System

Our highest-performance door, the 77ID fully rebated door system is ideal for new build and refurbishment developments. This system integrates minimal sightlines into our 77 window systems and is suitable for use in both high and low-rise buildings. The system has been specifically designed to meet the most demanding UK performance requirements in terms of thermals, weathering and security.

Modern contemporary styling and a wide variety of configurations delivering 2025 future ready thermal performance through the latest industry technologies of high-performance polyamides, insulated centre seals, profile foam insertions and class leading weather performance via multiple seals including central gasket which also improves acoustic performance. The 77ID system also fully integrates into our curtain wall and 77 window systems.

For optimal design flexibility, the 77ID is available in single or dual colour options, including any RAL colour and anodised finishes.

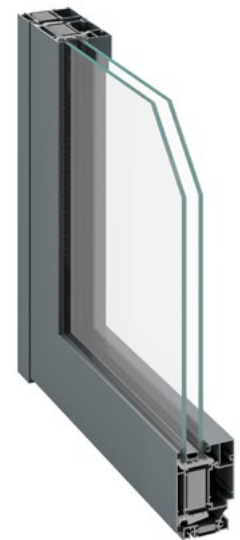

DESIGN FEATURES

- › Highest levels of thermal performance
- › Multi chamber low lambda polyamide thermal breaks insulated composite centre seals and profile foam inserts
- › Integrates with AluK curtain wall and 77 series window systems
- › Dedicated groove for factory mounting of membranes ensuring air, wind and water performance
- › 77mm minimal frame depth
- › High performance low threshold solution
- › Fully rebated flush sash profile design for uninterrupted sleek finish

OPTIONS

- › Wide variety of configurations
- › Three hinge methods to choose from face mounted, slim barrel and fully concealed
- › Modular locking arrangement both handle or key driven locks
- › Incorporates the AluK Novae handle design range for suited windows and doors
- › Customisable in almost every possible single or dual colour polyester powder coating, textured or anodised finish available
- › Enhanced PAS24 security tested solutions

Secured by Design



Police Preferred Specification



SPECIFICATIONS

| Performance and accreditations | 77ID |
|---------------------------------|--------------------------------------|
| U-Value (Double Glazing) 1.0 CP | 1.2 W/m²K |
| U-Value (Triple Glazing) 0.4 CP | 0.8 W/m²K |
| Air Permeability | Class 4 (600 Pa) |
| Water Tightness | 9A (600 Pa) |
| Wind Resistance | C5 (2000 Pa) |
| Security | PAS 24 & SBD |
| 3rd Party Certification Q-Mark | ✓ |
| System | |
| Depth | 77mm |
| Configurations | |
| Open In / Out | ✓ |
| Single / Double Doors | ✓ |
| Low Threshold | ✓ |
| Fully Rebated | ✓ |
| Weight limits | |
| Max Size (mm) | 1250w x 3100h (See Technical Manual) |
| Max Weight Per Sash | 160kg (See Technical Manual) |
| Glazing | |
| Glazing Thickness | 24mm – 50mm |
| System features | |
| Single Colour | ✓ |
| Dual Colour | ✓ |
| Textured Finish | ✓ |
| Anodised Finish | ✓ |
| Multi-Point / Single Locking | Multi-Point |
| Standard Hardware Groove | AluK IW Groove |
| EPDM Groove | ✓ |
| Locking Handles | ✓ |
| Concealed Hinges | ✓ |
| Flush Profiles | ✓ |
| Low Threshold | ✓ |

CONFIGURATIONS

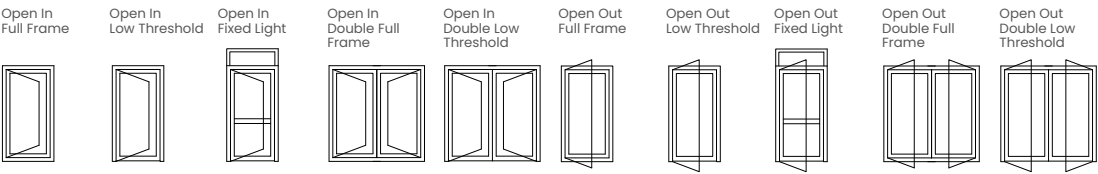

These elevations are PAS24 compliant.

CAD CROSS SECTIONS

Additional details are available on request.

➤ 77ID

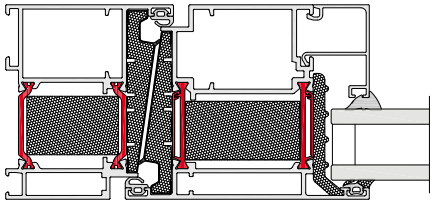

➤ 77ID LOW THRESHOLD

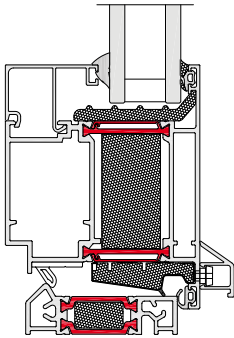

Heritage Entrance Door

Stylish and industrial, the Heritage Entrance Door allows you to create a seamless aesthetic across a wide range of door opening sizes and uses, from single doors to French doors with multiple fan lights.

Slim sightlines of just 51.7mm allows maximum light transmission, elegantly framing outside space. All complemented by market-leading U-Values of 1.4 w/m²K making it fully compliant with Part L Building Regulations for refurbishment projects.

Crafted to match the 58BW HI window range, its shared profiles, beads, and ancillaries offer new and existing fabricators a full heritage range of windows and doors with less stock-holding and simple fabrication.

DESIGN FEATURES

- › Suited to existing 58BW ST HI range of profiles, beads and ancillaries
- › 45 degree mitre and crimped sash
- › Slim sightlines: 51.7mm sash / 112.5mm sash to mullion
- › New Heritage door 28mm QUIK CLIP™ bead for door sash
- › Open Out/In 90 degree door restrictor

OPTIONS

- › Suited Heritage door hardware and handles in four colours/textures
- › Option to add multiple horizontal and vertical profiles to door sash using plant-on bars or 46.5mm door transom profile
- › Configurations of single / double / open-in / open-out with options for side and fan lights



Secured by Design



Police Preferred Specification



SPECIFICATIONS

| Performance and accreditations | SINGLE OPEN OUT | DOUBLE OPEN IN |
|--------------------------------------|-------------------|--------------------|
| U-value (Double glazing 1.0 CP Unit) | 1.4 W/m²K | 1.4 W/m²K |
| Air Permeability | 600 Pa (Class 4)* | 600 Pa (Class 4)* |
| Water Tightness | 750 (Class E750)* | 200 Pa (Class 5A)* |
| Wind Resistance | TBC | TBC |
| System | | |
| Depth | 58-70 mm | 58-70 mm |
| Size and weight limits | | |
| Max Door Size (WxH) | 1000mm x 2300mm | 2000mm x 2300mm |
| Min Door Size (WxH) | 600mm x 1800mm | 1200mm x 1800mm |
| Max Vent Weight | 65 kg | 65 kg |
| Glazing | | |
| Glazing Thickness | 24 - 28 mm | 24 - 28 mm |
| Glazing Options | Double Glazed | Double Glazed |
| System Features | | |
| Dual Colour Option | ✓ | ✓ |
| Multi-Point Locking | ✓ | ✓ |
| Barrell Hinges | ✓ | ✓ |
| Thermally Broken | Low Lambda PA | Low Lambda PA |

CONFIGURATIONS



Single Door
Open In & Open Out



Single / Double Door
+ Side Lights



Double Door
Open In & Open Out



Single / Double Door
+ Fan Lights

CAD CROSS SECTIONS

Additional details are available on request.

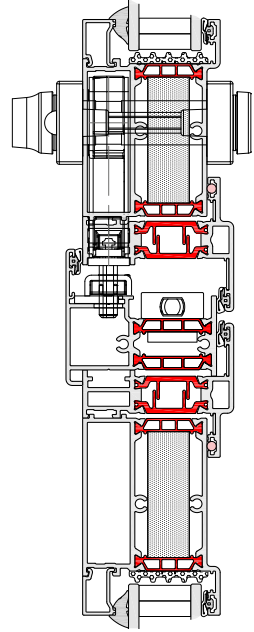

➤ 58BWST HI DOUBLE DOOR MEETING STILE

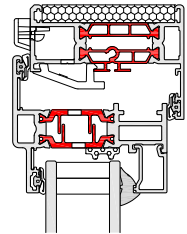

➤ 58BWST HI OPEN OUT CIL

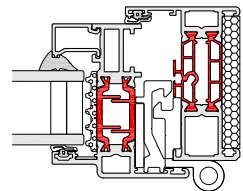

➤ 58BWST HI OPEN OUT HINGE JAMB

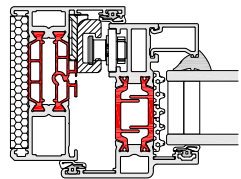

➤ 58BWST HI OPEN OUT LOCK JAMB

*Internal tests only. UKAS testing TBC

Sliding Door Systems

Our sliding aluminium door systems provide a highly versatile way of bringing together indoor and outdoor spaces.

Combining narrow profiles and high thermal efficiency, all of our systems create wide expanses that flood spaces with natural light. This ensures you have the freedom to bring your designs to life without ever compromising performance for style, or aesthetics for efficiency.

As with our other products, security and reliability remains a key driver in every one of our designs. Concealed mechanisms, burglary-resistant locks and class-leading water tightness are just some of the features available that will ensure your designs surpass industry standards.

COMBINING NARROW PROFILES
AND HIGH THERMAL EFFICIENCY,
ALL OF OUR SYSTEMS CREATE
WIDE EXPANSES THAT FLOOD
SPACES WITH NATURAL LIGHT,
WHILE MAINTAINING INTERNAL
TEMPERATURES AT ALL TIMES.



INFINIUM Sliding Door System

Ideally suited to high-end designs, the Infinium Sliding Door offers you the opportunity to flood spaces with natural light thanks to its unique completely concealed outer frame, and large glazing panels with exceptionally slim sightlines.

The fully concealed system seamlessly integrates floor-to-ceiling glazing and features a slim interlock of just 21mm. This results in uninterrupted panoramic landscapes that cleverly brings together indoor and outdoor living to create a single-minded space.

The Infinium is available in a range of configurations, including a floating corner option, enabling you to deliver the most appropriate design solution for each project. Bespoke aluminium rollers have also been designed to ensure even the heaviest Infinium door is easy to open and close. Further architectural standout is provided by the system's highly discrete integrated handles.

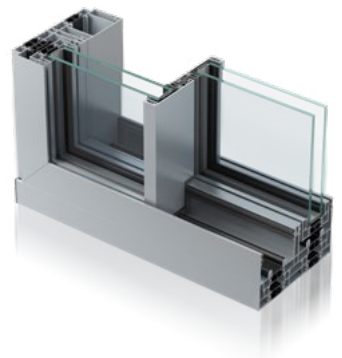

DESIGN FEATURES

- › Fully concealed outer frame
- › 21mm central interlock
- › One or more opening panels with large width dimensions up to 3000mm, and height dimensions up to 3500mm
- › Holds up to 400kg panel weight

OPTIONS

- › Available in double or triple track
- › Glazing options of 38mm–52mm
- › Floating corner post option for larger opening space
- › Available in single colour polyester powder coating, textured and anodised finishes
- › Available in a range of configurations
- › Double or triple glazing solutions available on the same outer frame
- › Manual or concealed motorised opening options

SPECIFICATIONS

| Performance and accreditations | INFINIUM |
|--------------------------------|-----------------------------------|
| U-Value (Double Glazing) | 1.3 W/m²K |
| U-Value (Triple Glazing) | < 1.0 W/m²K |
| Air Permeability | Class 4 (600 Pa) |
| Water Tightness | Class 8A (450 Pa) |
| Wind Resistance | Class C3 (1200 Pa up to 160 km/h) |
| Cycle Testing | 25,000 |
| System depth | |
| Double Track | 175mm |
| Triple Track | 267mm |
| Configurations | |
| Opening | Inline Sliding |
| Double Track | ✓ |
| Triple Track | ✓ |
| Size and weight limits | |
| Max Sash Height | 3500mm |
| Max Sash Width | 3000mm |
| Max Sash Weight | 400kg |
| Glazing | |
| Glazing Thickness | 38mm - 52mm |
| System Features | |
| Single Colour | ✓ |
| Textured Finish | ✓ |
| Anodised Finish | ✓ |
| Multi-Point Locking | ✓ |
| Interlock Sightline | 21mm |

CONFIGURATIONS

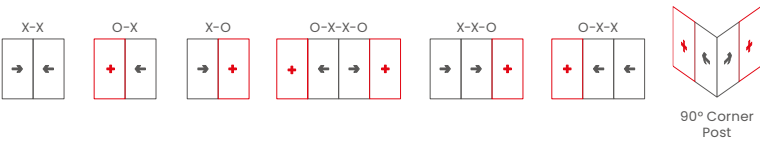

KEY



CAD CROSS SECTIONS

Additional details are available on request.

INFINIUM INTERLOCK

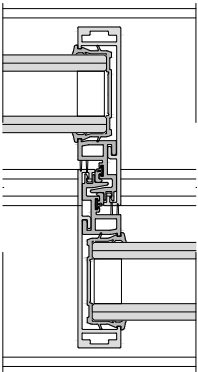

INFINIUM JAMB DETAIL

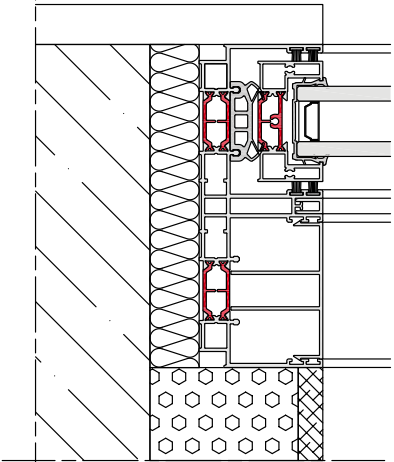

INFINIUM CILL DETAIL

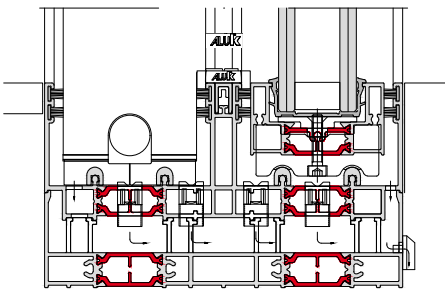

SCI56 Lift and Slide Door System

The premium SCI56 Door has been designed to meet the demands of projects that require the highest levels of thermal and weathering performance. Delivering a U-Value of $1.0\text{W/m}^2\text{K}$ (triple glazed), alongside superior water tightness of (1500 Pa), this highly sought-after system delivers enhanced capability without sacrificing style.

The elegant design features a slim interlock of 50mm and have been specifically created to provide greater design flexibility by enabling larger glazing areas to be achieved. The system's Lift and Slide technology uses high quality fittings that both ensure ease of operation and enables panel weights of up to 400kg to be incorporated into designs. The SCI56 is PAS 24-accredited and available in a range of configurations and options.

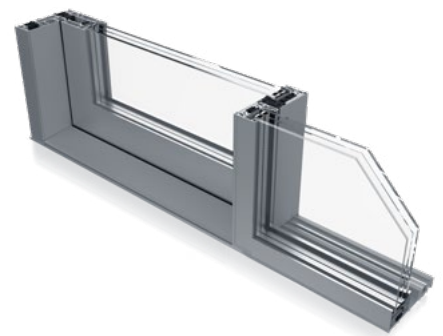

DESIGN FEATURES

- › Lift and Slide for smooth operation
- › PAS 24 Accredited
- › Exceptional AWW ratings
- › Low threshold of 23mm
- › Max 400kg panel weight

OPTIONS

- › Slimmer sightline of 50mm interlock
- › Accepts 24mm – 50mm double or triple glazing
- › Multiple sliding configurations
- › Single or Double Track options
- › Range of hardware and security features
- › Available in a range of single and dual colours, textured and anodised finishes

Secured by Design



Police Preferred Specification



SPECIFICATIONS

| Performance and accreditations | SC156 |
|---|---|
| U-value (Double Glazing) ($U_g = 1.0 \text{ W/m}^2\text{K}$) (Single Track) | 1.4 $\text{W/m}^2\text{K}$ |
| U-value (Triple Glazing) ($U_g = 0.6 \text{ W/m}^2\text{K}$) (Single Track) | 1.0 $\text{W/m}^2\text{K}$ |
| U-value (Double Glazing) ($U_g = 1.0 \text{ W/m}^2\text{K}$) (Double Track) | 1.5 $\text{W/m}^2\text{K}$ |
| U-value (Triple Glazing) ($U_g = 0.6 \text{ W/m}^2\text{K}$) (Double Track) | 1.2 $\text{W/m}^2\text{K}$ |
| Air Permeability | Class 4 (600 Pa) |
| Water Tightness | Class EI500 (1500Pa) |
| Wind Resistance | Class 4 (1600 Pa) |
| Acoustic Performance | $R_w(\text{Ct};\text{Ctr}) = 44 \text{ (-2;-6) dB}$ |
| Security | PAS 24 |
| System | |
| Depth | 156mm |
| Configurations | |
| Opening | Lift & Slide |
| Single Track | ✓ |
| Double Track | ✓ |
| Size and weight limits | |
| Max Frame Height | 3100mm |
| Max Sash Height | 3100mm |
| Max Sash Width | 2700mm |
| Max Sash Weight* | 300kg |
| Glazing | |
| Glazing Options | Internal |
| Glazing Thickness | 24mm – 50mm |
| System Features | |
| Single Colour | ✓ |
| Dual Colour | ✓ |
| Textured Finish | ✓ |
| Anodised Finish | ✓ |
| Multi-Point Locking | ✓ |
| Threshold | 23mm |
| Sightlines | 95mm |

* 300kg on standard roller sets, 400kg with additional roller set

CONFIGURATIONS

SINGLE TRACK



DOUBLE TRACK



KEY



CAD CROSS SECTIONS

Additional details are available on request.

SC156 INTERLOCK

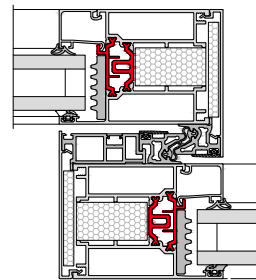

SC156 INTERLOCK SLIM

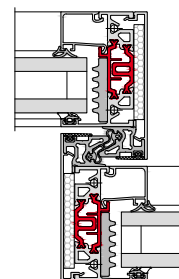

SC156 HEAD

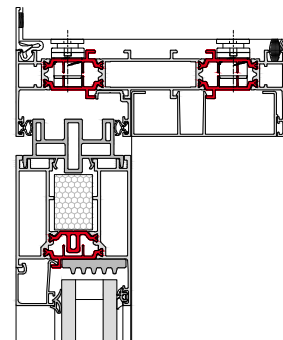

SC156 CILL

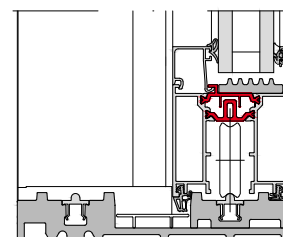

SC156 JAMB

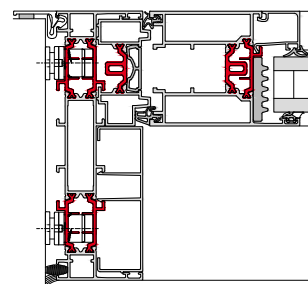

S140

Lift and Slide Door

Modern, versatile and customisable, the S140 Lift and Slide Door combines high performance with contemporary design to provide a reliable aluminium door system for almost any project. Manufactured to the highest UK standards, this multi-configuration system can achieve Thermal U-Values of $0.8\text{W/m}^2\text{K}$ (Triple glazed) and $1.2\text{W/m}^2\text{K}$ (Double glazed).

In addition to double and triple track options, a comprehensive range of colours and anodised finishes are available for the system.

DESIGN FEATURES

- › Doc L compliant U-values for refurbishment and new build properties
- › Slimline outer frame with flush frame-sash sight line
- › 2-part triple track profile for ease of fabrication and installation
- › Accepts 46 mm - 48mm glazing
- › Max 420kg panel weight

OPTIONS

- › Multiple sliding configurations
- › Double and Triple Track options
- › Available in single, dual colour and anodised finishes
- › Range of hardware and security features
- › Quik Clip
- › Dedicated Cill
- › Full Threshold Available



SPECIFICATIONS

| Performance* and accreditations | S140 |
|--|--------------------|
| U-Value Double Track 2500x2725mm (Double Glazing) 1.0 Ug | 1.3 W/m²K |
| U-Value Double Track 2500x2725mm (Triple Glazing) 0.5 Ug | 0.9 W/m²K |
| U-Value Double Track 4982x3100mm (Double Glazing) 1.0 Ug | 1.2 W/m²K |
| U-Value Double Track 4982x3100mm (Triple Glazing) 0.5 Ug | 0.8 W/m²K |
| Doorset Energy Ratings (DSER) – Double Glazing | C |
| Doorset Energy Ratings (DSER) – Triple Glazing | A+ |
| Air Permeability (Pa) | Class 4 (600 Pa) |
| Watertightness (Pa) | Class 8A (450 Pa) |
| Wind Resistance (Pa) | Class 4C (1600 Pa) |
| System | |
| Depth | 140 – 217.5mm |
| Configurations | |
| Double Track | ✓ |
| Triple Track | ✓ |
| Size and weight limits | |
| Max Outer Frame W x H: Double Track | 4982mm x 3100mm* |
| Max Outer Frame W x H: Triple Track | 6600mm x 3100mm* |
| Max Sash W x H: Double Track | 2500mm x 3029mm* |
| Max Sash W x H: Triple Track | 2257mm x 3029mm* |
| Max Sash Weight | 420kg |
| Glazing | |
| Glazing Options | Internal |
| Glazing Thickness | 46 – 48mm |
| Options | |
| Quik Clip | ✓ |
| Dedicated Cill | ✓ |
| System Features | |
| Single Colour | ✓ |
| Dual Colour | ✓ |
| Textured Finish | ✓ |
| Anodised Finish | ✓ |
| Multi-Point Locking | ✓ |
| Sightline (interlock) | 89mm |
| Sightline (Cill) | 117.6mm |
| Sightline (Head) | 117.6mm |
| Sightline (Jamb) | 117.6mm |
| Slim Interlock | 44mm |

*Note: All maximum sizes should be checked against wind load and glass weights. Please contact AluK's technical department for further assistance on sizes and limitations.

CONFIGURATIONS

DOUBLE TRACK



TRIPLE TRACK



KEY

| | | | | | | | |
|---|-------------------------|---|--------------------------|---|---------------------------|---|-------------|
| ← | Door slides to the left | → | Door slides to the right | ↔ | Door can slide either way | + | Fixed panel |
|---|-------------------------|---|--------------------------|---|---------------------------|---|-------------|

* Performance data based on extended CEN size for Building Regulations. For full test performance details please contact Technical Services. AluK recommends checking all system performance for any scheme prior to use. The maximum height of 3136mm, DOES NOT consider wind loading or glass weights which would need to be checked on each door setup of this size. i.e., if the glass weight is greater than 420 Kg's or the wind load above the interlock inertia values required, the height of the door would need to be reduced to accommodate these limits.

CAD CROSS SECTIONS

Additional details are available on request.

► S140 HEAD DETAIL

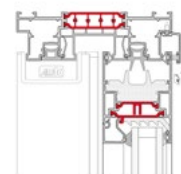

► S140 STANDARD THRESHOLD

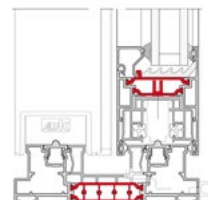

► S140 LOCKING JAMB

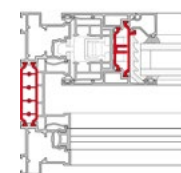

► S140 STANDARD INTERLOCK

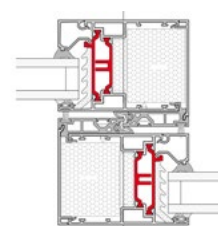

► S140 TRIPLE TRACK CILL

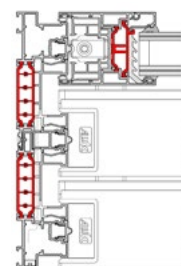

► S140 SLIM INTERLOCK

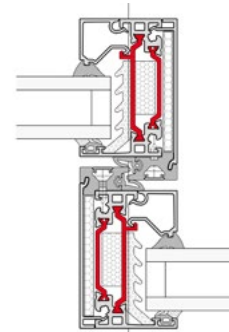

BSC94 HI

Inline Sliding Door

Modern, versatile and customisable, the BSC94 HI Inline Sliding Door combines high performance with contemporary design to provide a reliable aluminium door system for almost any architectural project. Manufactured to the highest UK standards, this multi-configuration system can achieve DSER of 'C' rating (double glazed) and sightlines of as little as 45mm.

In addition to dual colour options, a comprehensive range of colours and anodised finishes are available for the system. The BSC94 HI also features an anti bimetal low lambda strip to allow for varying expansion rates, ensuring the continued integrity of your design.



DESIGN FEATURES

- › Accepts 20mm – 31mm double glazing
- › Max 400kg panel weight
- › Certified under the Secured By Design scheme
- › Tested to PAS 24
- › Anti bimetal low lambda strip to allow for varying expansion rates

OPTIONS

- › Slimmer sightline of 45mm available
- › Multiple sliding configurations
- › Double track options
- › Available in single and dual colour
- › Anodised finishes also available
- › Range of hardware and security features

Secured by Design



Police Preferred Specification



SPECIFICATIONS

| Performance* and accreditations | BSC94 HI | BSC94 SLIM HI |
|--|----------------------------|-------------------|
| U-Value (Double Glazing) (Ug = 1.0 W/m²K) (Double Track) | 1.7 W/m²K | 1.7 W/m²K |
| DSER | 'C' Rating | 'C' Rating |
| BRE Green Guide Rating | C Rated | C Rated |
| Air Permeability | Class 4 (600 Pa) | Class 3 (600 Pa) |
| Water Tightness | Class 6a (250 Pa) | Class 4a (150 Pa) |
| Wind Resistance | C3 (1200 Pa) | C3 (1200 Pa) |
| Acoustic Performance | Rw (C;Ctr) 36 (-1;-3) dB** | - |
| Security | PAS 24 & SBD | x |
| System | | |
| Depth | 94mm-155mm | 94mm-155mm |
| Configurations | | |
| Opening | Inline Sliding | Inline Sliding |
| Double Track | ✓ | ✓ |
| Size and weight limits | | |
| Max Frame Height | 3000mm | 3000mm |
| Max Sash Width | 2000mm | 2000mm |
| Max Frame Height With Security Features | 2600mm | x |
| Max Vent Weight | 400kg | 400kg |
| Glazing | | |
| Glazing Options | Internal | Internal |
| Glazing Thickness | 20mm-31mm | 20mm-31mm |
| System Features | | |
| Single Colour | ✓ | ✓ |
| Dual Colour | ✓ | ✓ |
| Textured Finish | ✓ | ✓ |
| Anodised Finish | ✓ | ✓ |
| Multi-Point Locking | ✓ | ✓ |
| Sightlines (Interlock) | 85mm | 45mm |
| Sightlines (Cill) | 115.5mm | 115.5mm |
| Sightlines (Head) | 115.5mm | 115.5mm |
| Sightlines (Jamb) | 115.5mm | 115.5mm |

CONFIGURATIONS

DOUBLE TRACK

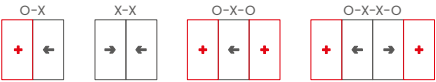

KEY



CAD CROSS SECTIONS

Additional details are available on request.

BSC94 HI DOUBLE TRACK STANDARD INTERLOCK

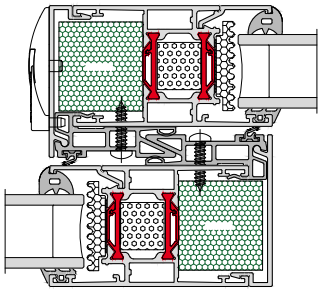

BSC94 HI DOUBLE TRACK CILL

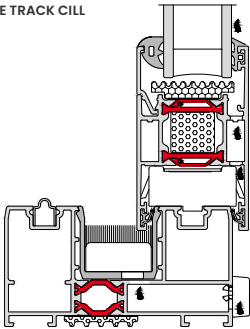

BSC94 HI DOUBLE TRACK STANDARD SLIMLINE INTERLOCK

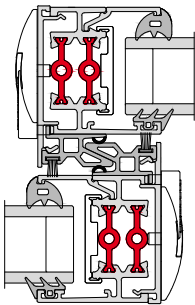

* Performance data based on CEN size for Building Regulations. For full test performance details please contact Technical Services. AluK recommends checking all system performance for any scheme prior to use.

Sliding Folding Door Systems

We have developed a series of strong, lightweight and thermally broken folding door systems that enable the opening of large expanses and consequently brings together indoor and outdoor living spaces. This allows specifiers to design spaces that truly engage with their surroundings.

We also believe aesthetics should never compromise performance, which is why all our folding door systems have been designed to create living and working environments that are comfortable and efficient in equal measure.

As with all AluK products, security and reliability remains a key driver in our folding door systems. All have been rigorously tried and tested to exceed industry standards in terms of weather and water tightness, and are certified under the Secured By Design scheme.

OUR FOLDING DOOR SYSTEMS
BOAST THE HIGHEST STANDARDS
OF BOTH FORM AND FUNCTION,
DELIVERING LIVING AND WORKING
ENVIRONMENTS THAT ARE
COMFORTABLE AND EFFICIENT
IN EQUAL MEASURE.



F82 PLUS

Sliding Folding Door

The F82 Plus Bifold Door System puts high performance and security front of mind, offering a wide range of configurations to support the bespoke requirements of your project. Multiple doors can be combined with open-in or open-out options in a variety of styles to create a wide expanse of opening.

The system is fully PAS 24 and Secured By Design-accredited, making it Document Q compliant. The full frame and cill have been designed to create a slimmer, symmetrical frame of 97mm combined with a reduced interlock sightline of 122mm, providing larger glazing areas without compromising performance. Thermal U-Values of 1.2 W/m²K (double glazed) and 0.9 W/m²K (triple glazed) assist with meeting the latest energy efficiency requirements.

Other key design features include a flush pop-out handle and contemporary traffic door handles. A new floating corner offers a true inside-out design, while the 110mm mid rail allows the creation of transoms in the door or solid panels in single and double doors for a uniform aesthetic.

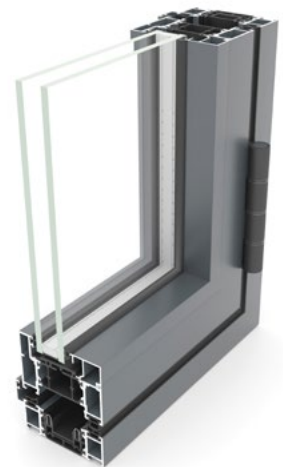

DESIGN FEATURES

- › Unique pop-up handle, cycle tested to 25,000 operations for up to 80 years of reliable use
- › Integrated cill profile clips onto the outer frame sides, reducing sightlines
- › Heavy-duty stainless steel compact rollers as standard
- › Full symmetrical frame sightline of 97mm
- › 122mm slimline interlock
- › Larger glazing area

OPTIONS

- › Square bead
- › Glazing sizing range of 28mm–44mm
- › Available in a range of opening configurations, including a floating corner
- › Available in single or dual colour polyester powder coating, texture and anodised finishes
- › All configurations available open-in and open-out
- › 110mm midrail - make single or double doors using transoms or solid panels
- › New sub cill range - position onto varying widths of construction using the 225mm, 150mm or 95mm options

Secured by Design



Police Preferred Specification



SPECIFICATIONS

| Performance and accreditations | OPEN-IN | OPEN-OUT |
|--|----------------------|----------------------|
| U-Value (Double Glazing) (Ug: 1.0 W/m²K) | 1.2 W/m²K | 1.2 W/m²K |
| U-Value (Triple Glazing) (Ug: 0.7 W/m²K) | 0.9 W/m²K | 0.9 W/m²K |
| Air Permeability (Standard Threshold) | Class 3 (600 Pa) | Class 4 (600 Pa) |
| Water Tightness (Standard Threshold) | Class 5a (200Pa) | Class E900 (900 Pa) |
| Wind Resistance | Class B3 (1200Pa) | B3 (1200 Pa) |
| Security | PAS 24 & SBD | PAS 24 & SBD |
| System | | |
| Depth | 82MM | 82mm |
| Configurations | | |
| Opening | Open-In & Open-Out | Open-In & Open-Out |
| Size and weight limits | | |
| Max Leaf Height | 2500mm std/ 3000 mm* | 2500mm std/ 3000 mm* |
| Max Leaf Width | 1200mm | 1200mm |
| Max Vent Weight | 150kg | 150kg |
| Glazing | | |
| Glazing Options | Internal Bead | Internal Bead |
| Glazing Thickness | 28mm-44mm | 28mm-44mm |
| System Features | | |
| Single Colour | ✓ | ✓ |
| Dual Colour | ✓ | ✓ |
| Textured Finish | ✓ | ✓ |
| Anodised Finish | ✓ | ✓ |
| Multi-Point Locking | ✓ | ✓ |
| Sightline (Head) | 97mm | 97mm |
| Sightline (Cill) | 97mm | 97mm |
| Sightline (Jamb) | 97mm | 97mm |
| Sightline (Meeting Stile) | 122mm | 122mm |

CONFIGURATIONS

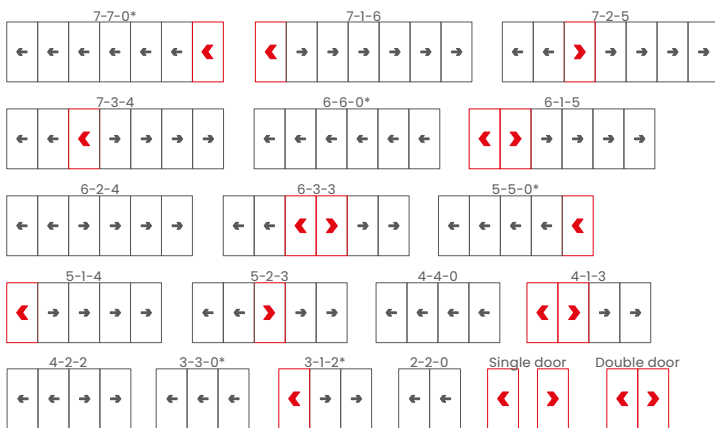

*Opposite handling available on all configurations. For more options, refer to the Technical Manual.

KEY



OTHER OPTIONS AVAILABLE



*The maximum height and panel width for the F82 Folding Sliding Door System are co-dependent and also dictated by the design wind load where the doors are being installed. Based on the site design wind load that the doors are subjected to this will influence the maximum height and width [per panel] to which the doors can be manufactured.

CAD CROSS SECTIONS

Additional details are available on request.

F82 PLUS HEAD

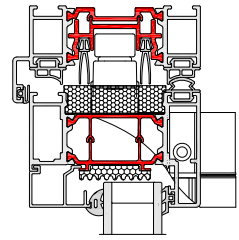

F82 PLUS INTERLOCK

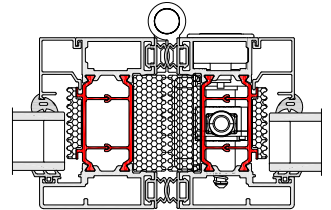

F82 PLUS LOCKING JAMB

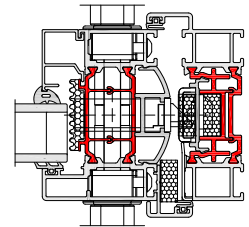

F82 PLUS FLOATING CORNER POST

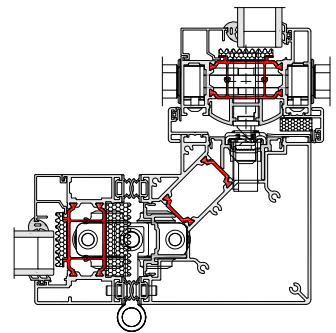

F82 PLUS CILL

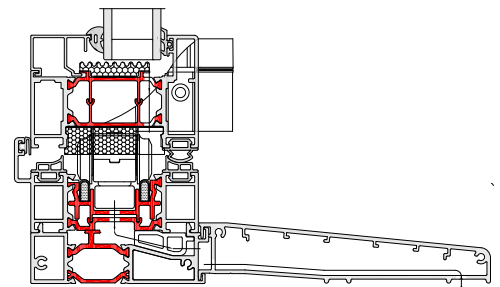

BSF70 HI Sliding Folding Door System

The BSF70 Folding Door System gives maximum control over the style and operation of the doors. Multiple panels can be added to accommodate the unique design specifications of the building, with the option to open-in or out as required. The system's narrow profile ensures that maximum glazing is achieved, flooding spaces with natural light.

In addition to the inherent strength of aluminium, the BSF70 combines security hinges and locking mechanisms with a unique heavy-duty roller design to provide the security and reliability demanded in high traffic applications.

DESIGN FEATURES

- › Internally beaded with a softline or square detail to all external doors and panels
- › Four stainless steel wheels ensures smooth and consistent operation
- › Unique, flush line pop-out handle that allows maximum door opening and square stacking of panels
- › Tested to PAS 24 and certified under the Secured by Design scheme

OPTIONS

- › Heavy-duty roller options
- › Low threshold option that can be configured to achieve DDA and Part M compliance
- › Doors and panels can be used in a variety of configurations, style and design
- › All configurations are available in both open-in and open-out options
- › Full range of bespoke hardware available
- › Glazing sizing range of 24mm–40mm
- › Available in single or dual colour polyester powder coating, texture and anodised finishes
- › **QUICKCLIP™** bead available with 28mm glazing



Secured by Design



Police Preferred Specification



SPECIFICATIONS

| Performance and accreditations | OPEN-IN | OPEN-OUT |
|--|------------------------|------------------------|
| U-Value (Double Glazing) (Ug: 1.0 W/m²K) | 1.4 W/m²K | 1.4 W/m²K |
| U-Value (Triple Glazing) (Ug: 0.7 W/m²K) | 1.1 W/m²K | 1.1 W/m²K |
| Air Permeability (Standard Threshold) | Class 4 (600 Pa) | Class 4 (600 Pa) |
| Water Tightness (Standard Threshold) | Class 9a (600 Pa) | Class 9a (600 Pa) |
| Wind Resistance | Class AE2400 (2400 Pa) | Class AE2400 (2400 Pa) |
| Security | PAS 24 & SBD | PAS 24 & SBD |
| Cycle Testing | 50,000 | 50,000 |
| 3rd Party Certification Q-Mark | ✓ | ✓ |
| System | | |
| Depth | 70mm | 70mm |
| Configurations | | |
| Opening | Open-In & Open-Out | Open-In & Open-Out |
| Size and weight limits | | |
| Max Leaf Height | 2400mm std/3000**mm | 2400mm std/3000**mm |
| Max Leaf Width | 1200mm | 1200mm |
| Max Vent Weight | 100kg | 130kg |
| Glazing | | |
| Glazing Options | Internal Bead | Internal Bead |
| Glazing Thickness | 24mm-40mm | 24mm-40mm |
| System Features | | |
| Low Threshold | ✓ | ✓ |
| Single Colour | ✓ | ✓ |
| Dual Colour | ✓ | ✓ |
| Textured Finish | ✓ | ✓ |
| Anodised Finish | ✓ | ✓ |
| Multi-Point Locking | ✓ | ✓ |
| Sightline (Head) | 110mm | 110mm |
| Sightline (Cill) | 130mm | 130mm |
| Sightline (Jamb) | 110mm | 110mm |
| Sightline (Meeting Stile) | 140mm | 140mm |

CONFIGURATIONS

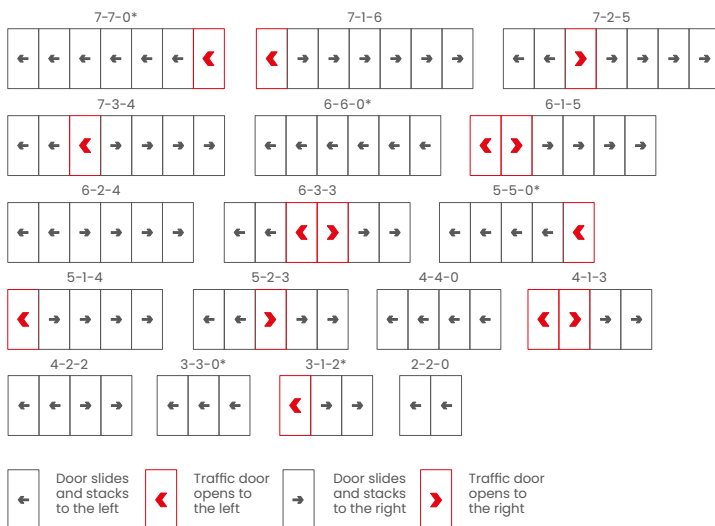

OTHER OPTIONS AVAILABLE



*Opposite handling available on all configurations. For more options, refer to the Technical Manual.

**The maximum height and panel width for the BSF70 HI Folding Sliding Door System are co-dependent and dictated by hardware limitation and the design wind load where the doors are being installed. Based on the site design wind load that the doors are subjected to this will influence the maximum height and width [per panel] to which the doors can be manufactured.

CAD CROSS SECTIONS

Additional details are available on request.

BSF70 HI HEAD

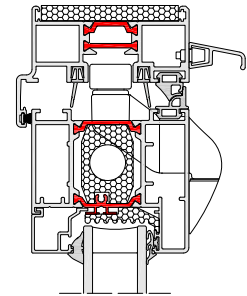

BSF70 HI INTERLOCK

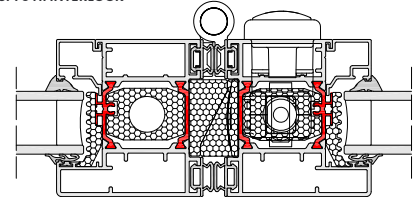

BSF70 HI LOCKING JAMB

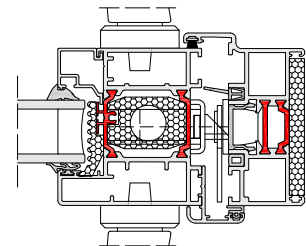

BSF70 HI CILL

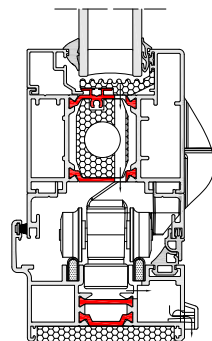

BSF70 HI SUBCILL

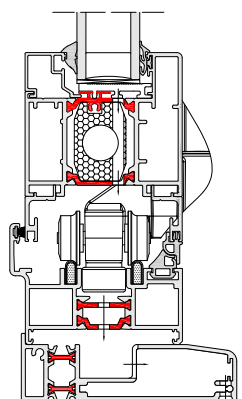

Case Study

Canada Street



Scan to view the full case study.

HG Construction's recently completed £77m Canada Street development in London's docklands is the first large scale installation of AluK's new C70S 70mm window system.

The mixed-use project includes modern student accommodation in blocks up to 10-storeys high, affordable housing, commercial and health space. It showcases the benefits of AluK's new, thermally efficient, slim sightline system and demonstrates just how easily it can be integrated in a scheme alongside AluK's **77ID** system residential doors, **SL52** capped curtain walling and **GT55TB** commercial entrance doors.

In total, there are almost 4600m² of glazing on the Canada Street development, all fabricated in AluK systems by Arkay Windows, and installed by NA Installations.

The **C70S** system was chosen by **HG Construction** in response to the specification from **Stephen Marshall Architects**. Sam Coley, a partner at Stephen Marshall, explained: "Our specification was for a high performing contemporary aluminium fenestration and façade system with slim sightlines and excellent U-Values - and the AluK systems were ideal for that.

"The fact that we could use two different window configurations, residential and commercial doors and curtain walling from one supplier right across this mixed-use development meant we got a satisfyingly uniform look

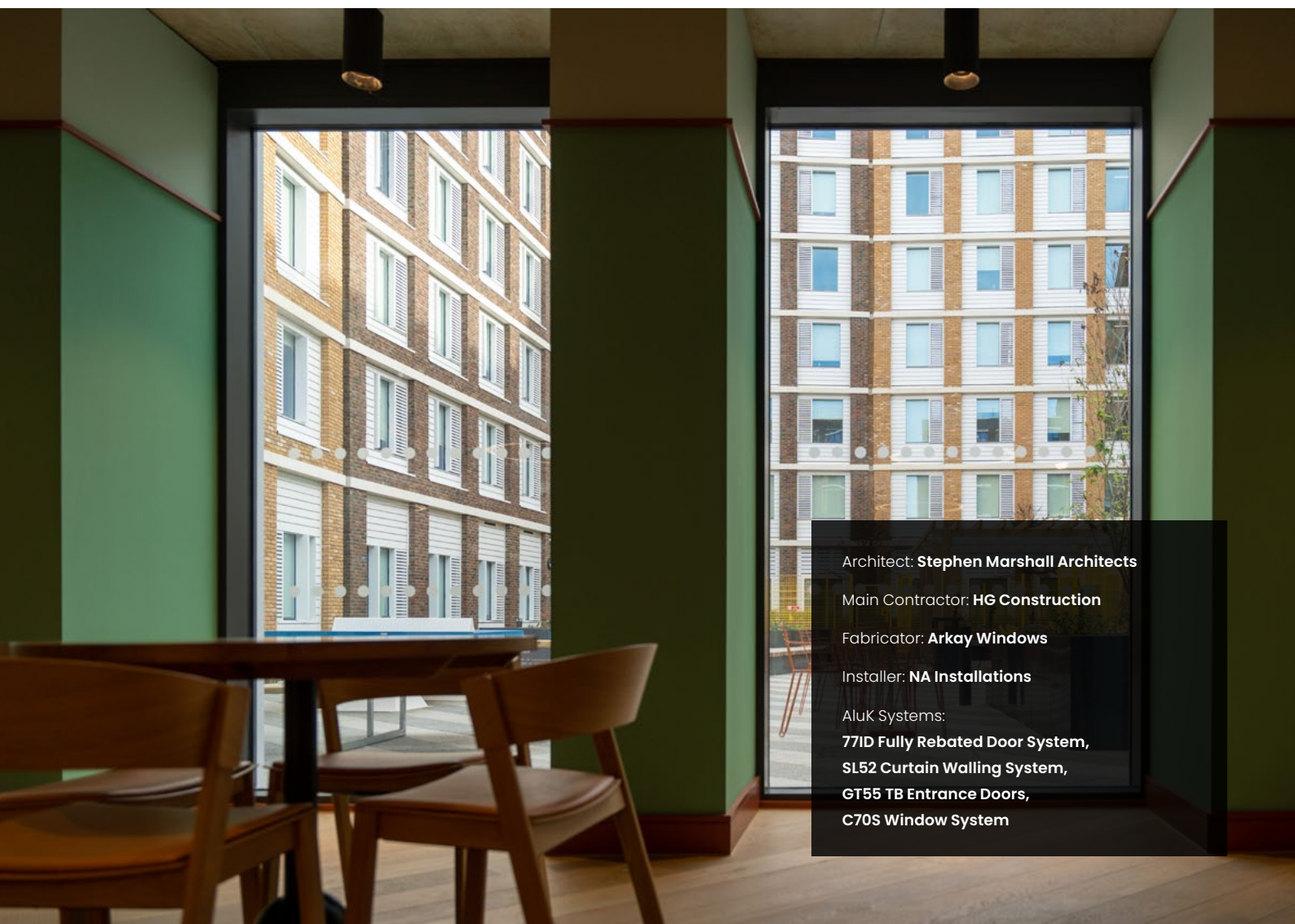

Architect: **Stephen Marshall Architects**

Main Contractor: **HG Construction**

Fabricator: **Arkay Windows**

Installer: **NA Installations**

AluK Systems:

77ID Fully Rebated Door System,
SL52 Curtain Walling System,
GT55 TB Entrance Doors,
C70S Window System

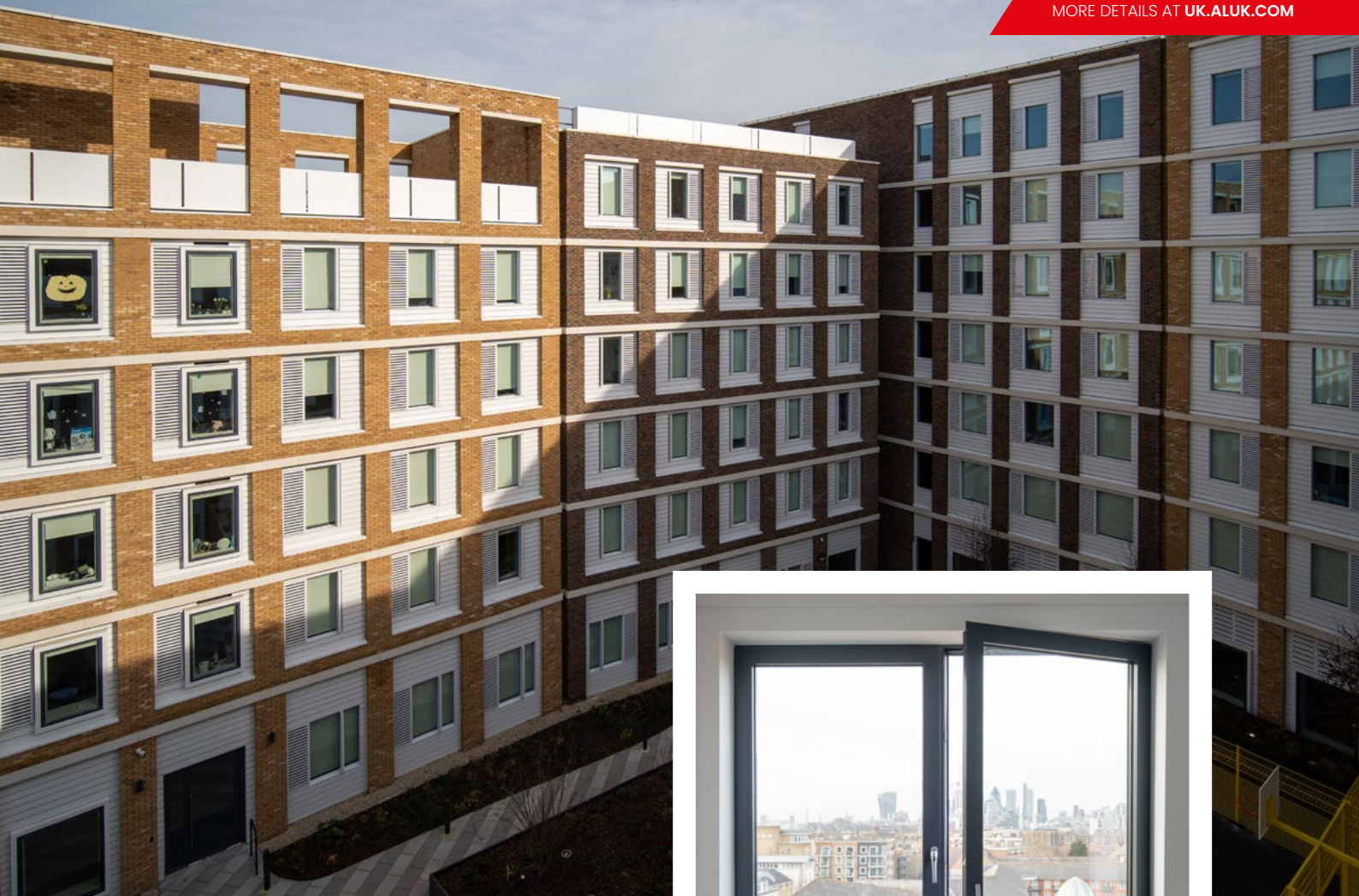

right across the project. For safety and optimal natural ventilation in the student accommodation, we were even able to specify a cost-effective fixed light in AluK alongside a vertical louvre.

“The design scheme at Canada Street included an innovative pre-cast banding façade solution which HG Construction were able to deliver very successfully in the AluK window system and we’re really pleased with finished look.”

For HG Construction, the project represented a significant construction challenge because it sits very close to Canada Water underground station and directly above the busy Jubilee Line. Logistically, there were also tight timescales to meet because the student accommodation blocks needed to be finished in time for the start of the academic term.

AluK, Arkay and NA Installations worked closely together to meet the timescale and to accommodate the fact that the installation method had to be changed from traditional scaffolding to working off mast climbers. This meant the installation sequence switched to elevation by elevation and there had to be multiple installation teams working on different blocks at the same time in order to meet the completion dates.



Sony Atwal, Arkay’s Technical and Operations Director, commented: “This project required a well-engineered, cost-effective window system and the **C70S** fitted the bill perfectly. It met all the performance and aesthetic requirements and was quick and easy to fabricate and install. Because it shares some components with the AluK **58BW** system which is one of our most popular products and has a similar fabrication method, we were easily able to integrate it into our factory and deliver the same level of quality and precision.”

The 70mm **C70S** system has the same slim 89mm sightlines as the **58BW** window system, but also boasts class-leading wind (600Pa) and water tightness (1500Pa). It has been Secured by Design accredited and can accommodate 50mm acoustic glazing, making it a good choice for this type of noisy urban environments.

T: 01291 639 739
E: info.uk@aluk.com

Registered Office:
AluK (GB) Ltd
Newhouse Farm Ind Est
Chepstow
NP16 6UD

London Office:
AluK Design Studio
5-11 Worship Street
London
EC2A 2BH

Registered Number:
02881320