

Sash Frame

Insulated DPC

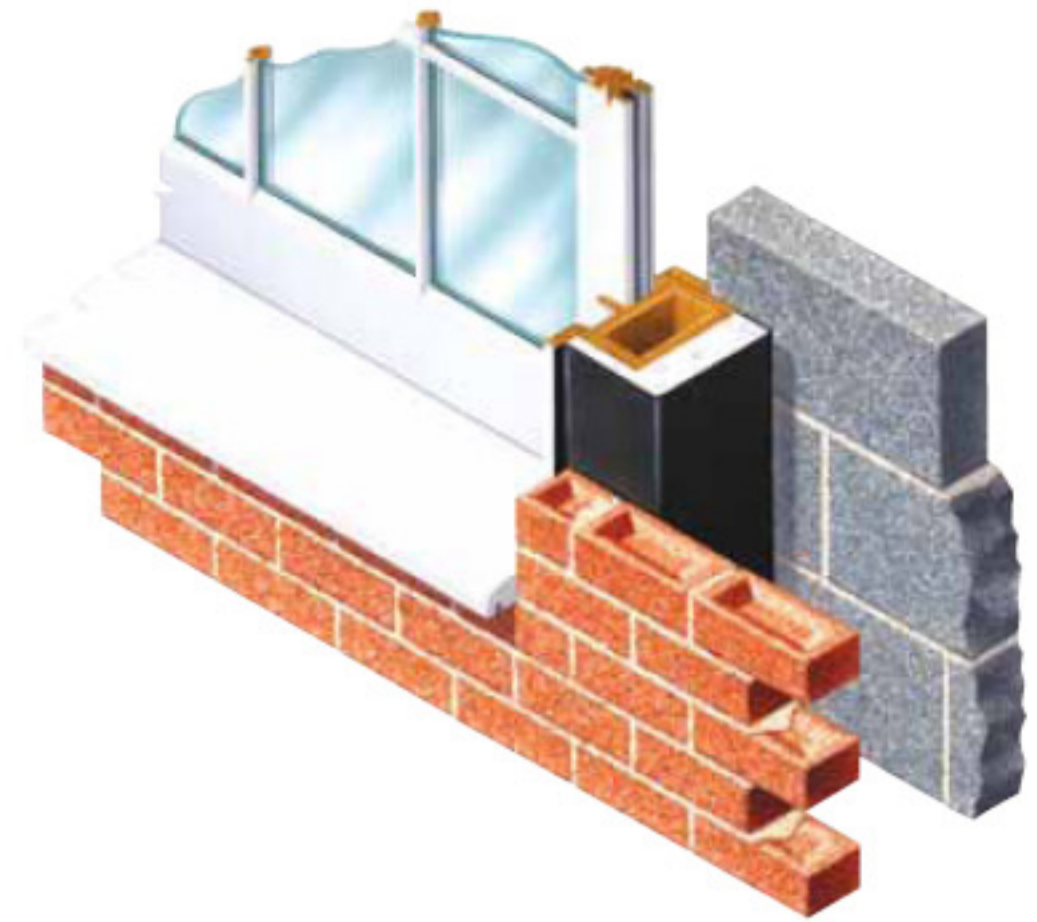

- Acts as a DPC
- Thermally insulates
- Assured preformed detail
- Permits upgrading of opening

Introduction

Specifically manufactured for use with sash window frames. DPC integrity is introduced along the line of the masonry check and cavity, promoting thermal enhancement of the reveal. Sash Frame DPC's are available for both traditional counterweight box style and balance style frames. The specifier is able to select the extent of thermal enhancement to suit the frame and structural opening dimensions. In the case of balanced sash frames replacing counterweight sash frame, the opportunity also exists to fully insulate the resultant void. Modified versions are also available for use in solid wall construction where envelopment of the frame is desired.

References

- Building Regulations Document C L1 & L2.
- British Standard 5628-3
- BRE Thermal Insulation Avoiding Risks
- Cavity Trays Ltd main manual
- Website: cavitytraystandards.co.uk
- Robust Details
- Scottish Tech Standards Part D

Specify

Sash Frame Insulated DPC by Cavity Trays of Yeovil Somerset BA22 8HU to interface with Sash frame and close cavity wall reveal. Sash Frame Insulated DPC profile as agreed drawing to suit ____mm cavity. (enter appropriate cavity width dimensions).

Construction Advantage

In new work applications an enhanced level of dpc and insulation can be introduced. In existing work advantage can be taken when introducing new frames to provide a level of upgrading that was not previously available.

Sash Frame Insulated DPC	New and existing applications
Exposure rating / frame relationship	Very severe
Cavity - standard sizes accommodated	All popular sizes
Special cavity widths accommodated	Yes bespoke closer service offered
Straight reveals	N/A
Checked + typical sash frame reveals	Yes - build in profile as supplied
Product lengths	2.4m
Acts as vertical dpc	Yes
Acts as insulator	Yes
Permits different frame positions	N/A
Frames fitted as work proceeds or later	Yes - first and second fix options pending design
Timber frame / traditional construction	Not affected by inner skin type
Masonry skin styles	All popular flat faced masonry
Undulating masonry face finishes	Seek advice providing details of material
Acoustic insulator	No - but available as option
Fire rated	No (see Cavi prefixed range for fire rated)
Vertical and horizontal applications	Yes - see examples
Compatible with other cavity wall elements	No identified restrictions
Securing ties supplied	Not required - secure to frame
Pack sizes	Individual lengths
Weight per pack	Varies pending style of profile selected.
Material	Pethylene + Inskorfoam or rock wool insulator
Colour	Black
Manufacturing standard	BS EN ISO 9001:2000
Building Regulations	Yes regulations can be satisfied
NHBC / Zurich / Premier requirements	Yes requirements can be satisfied
'k' value of insulation	0.033W/mK / 0.038W/mK
Possible composite thermal resistance path	Varies pending frame/design option
CFC free	Yes + zero ODP
CAD drawing downloads available	Bespoke downloads offered

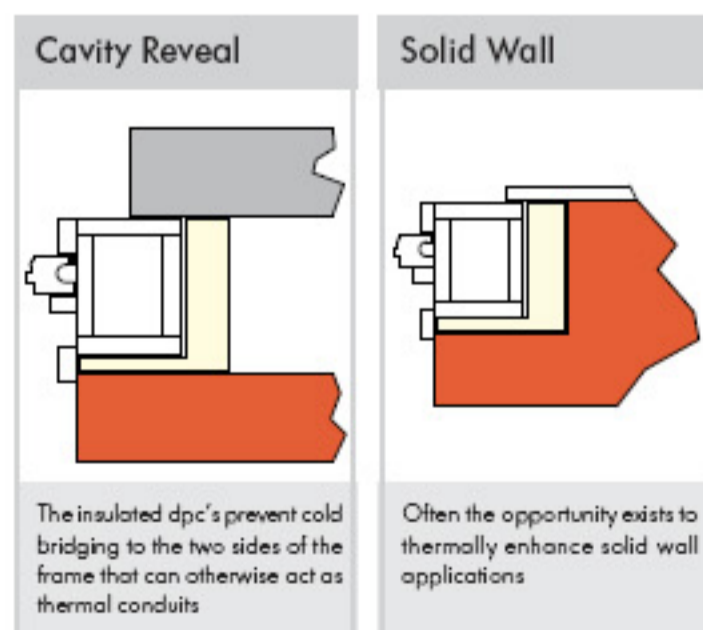

COMPUTER REFERENCE CODES:
SFC BESPOKE

