

Design & installation details - PCT refurbishment treatments

The acoustic performance of the floor structure will be compromised if the acoustic treatment is not completely isolated from the timber joists, sub-floor, services, door frames, surrounding walls and their treatments. To address this risk, each potential problem area needs to be detailed accordingly.

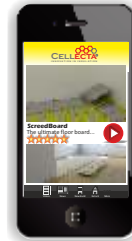
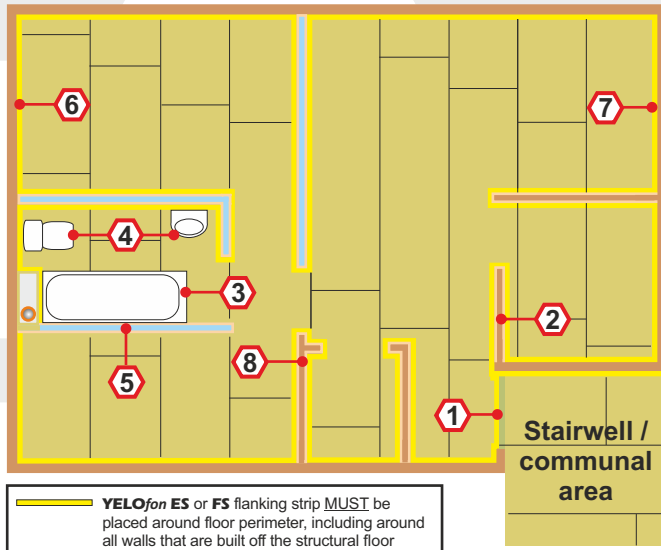

Installation video on the **CELLECTA** app

1a Door thresholds

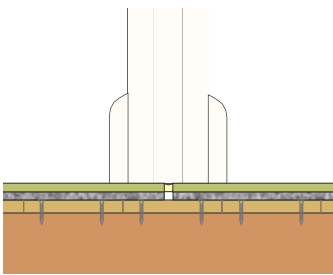

Leave a 5-10mm expansion gap between the habitable area floor treatment and the communal area floor treatment.

1b Door thresholds

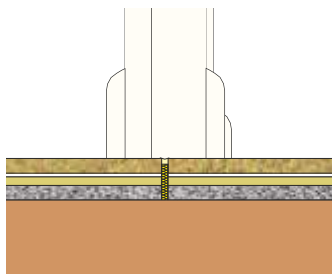

2 Timber stud partition

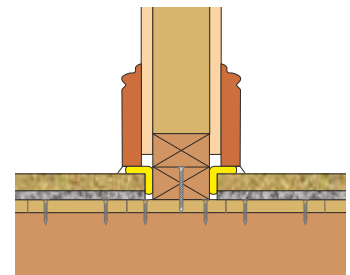

Lightweight internal walls should be built off the structural floor deck and **MUST** be isolated from the acoustic floor treatment with **YELOfon ES** or **FS strip**.

3 Bath and shower trays

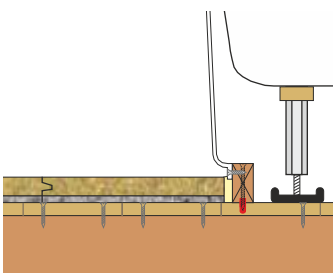

Baths and shower trays should be built off a structural floor and **MUST** be isolated from the acoustic floor treatment and any floor finished. Any gaps should be sealed with a suitable mastic.

4 Sanitary ware

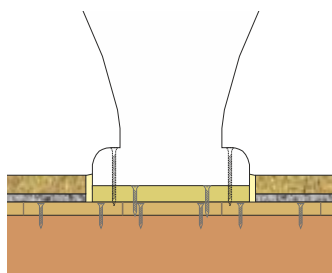

Sanitary ware should be built off a structural floor and **MUST** be isolated from the acoustic floor treatment and any floor finished. Any gaps should be sealed with a suitable mastic.

5 Metal frame partition built off the structural floor

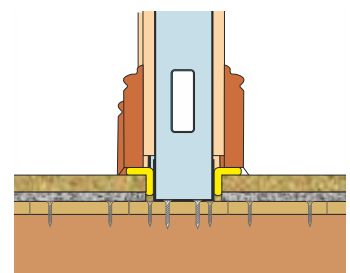

Lightweight internal walls built off the structural floor must be isolated from the acoustic floor treatment with **YELOfon ES** or **FS strip**.

6 Wall treatment installed before the floor treatment

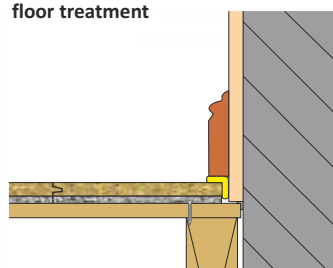

Wall treatments **MUST** be isolated from the acoustic floor treatment with **YELOfon ES** or **FS strip**, and all gaps sealed with a suitable mastic.

7 Wall treatment installed after the floor treatment

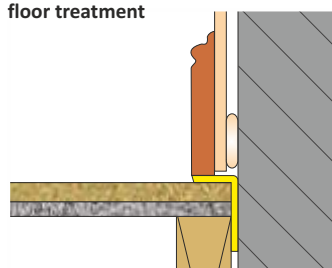

Wall treatments **MUST** be isolated from the acoustic floor treatment with **YELOfon ES** or **FS strip**, and all gaps sealed with a suitable mastic.

8 Lightweight partitions built off the floor joists

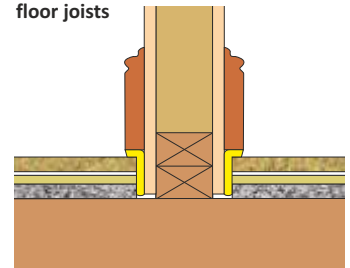

Lightweight internal walls built off the floor joists **MUST** be isolated from the acoustic treatment with **YELOfon ES** or **FS strip**.