

# SYSTEM DATA SHEET

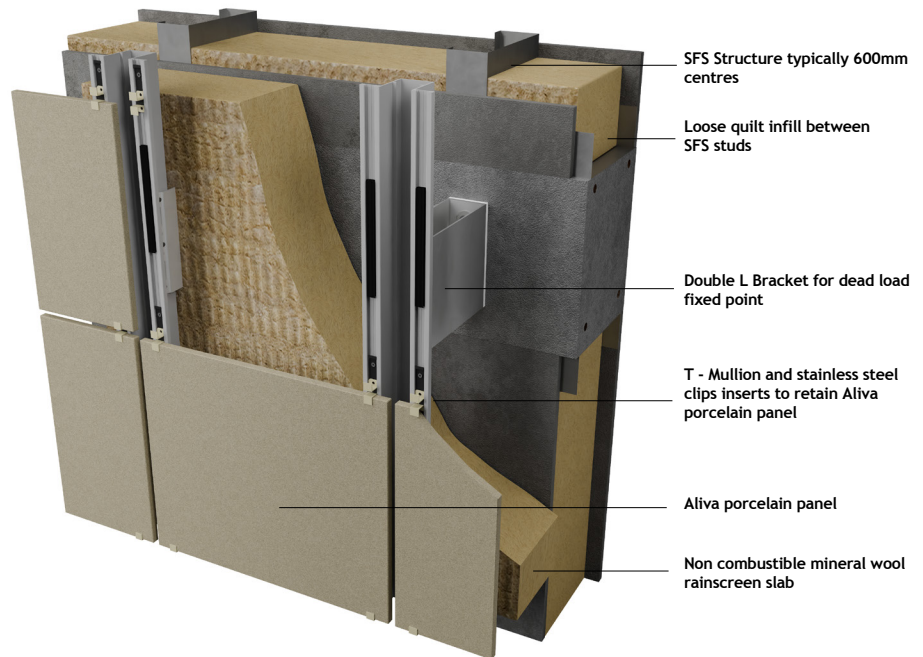

## DESCRIPTION

Aliva Ceramic.covering retaining clip is an Aliva facade and substructure system for porcelain tiles. The substructure, in aluminium alloy, is composed of brackets and vertical mullions, with slots into which stainless steel clips, coloured to match the tiles, are used for securing the tiles or panels, with joints of 6 or 8 mm.

## TECHNICAL PROPERTIES



### Fixing Method:

Typically fixed to Lightweight Steel Frame through the weathering Cement Particle Board, alternatively concrete structures using specified Mechanical fixings. For fixing into concrete and similar substrates pull out tests should be undertaken.

Main mullion extrusions are connected back to deadload and sliding brackets to form a substrate to enable tight and accurate installation tolerances, to allow inward and outward adjustment to support the porcelain facade panels.

A support extrusion is fixed to the face of the main mullion extrusions to carry clips that lock into the back of the panel via undercut anchors.

Insulation is incorporated to provide the required thermal performance and this dictates the depth of the deadload and sliding brackets.



### Design Life:

The system when installed to Specification will achieve a Design Life of in excess of 30 years.



### Fire Classification:

A1 to BS EN 13501-1;2019  
Surface Spread of Flame.