

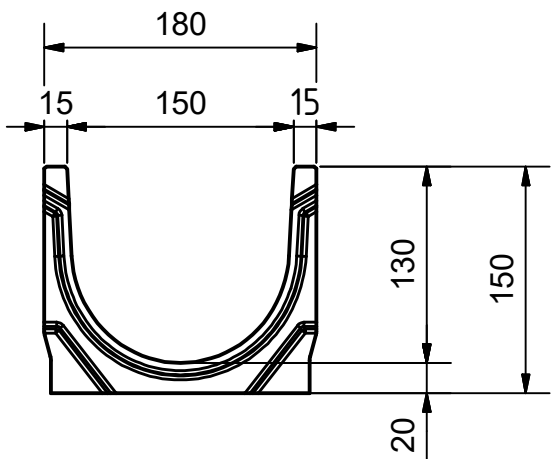

Rinne / channel:

FILCOTEN light: NW150, C250
BG code: 10315000 (10315050); 20,6 kg (10,3 kg):

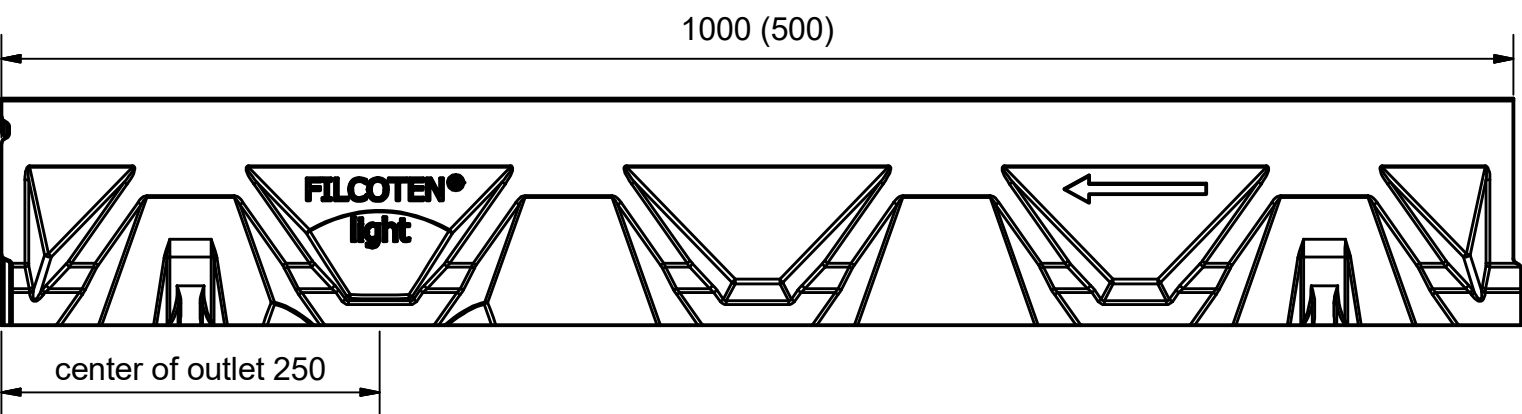

Legende / explanation:	
FCT:	FILCOTEN HPC
V:	verzinkter Stahl / galvanized steel
E:	Edelstahl / stainless steel
G:	Gußeisen / ductil iron
H:	Holz / wood

Roste, Abdeckungen / grates, covers:

Stegrost / Slotted grating: SW 8/130, A15
BG code: V 17015200 (17015201); 2,9 kg (1,5 kg):

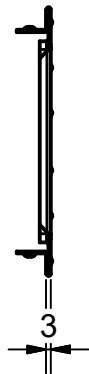
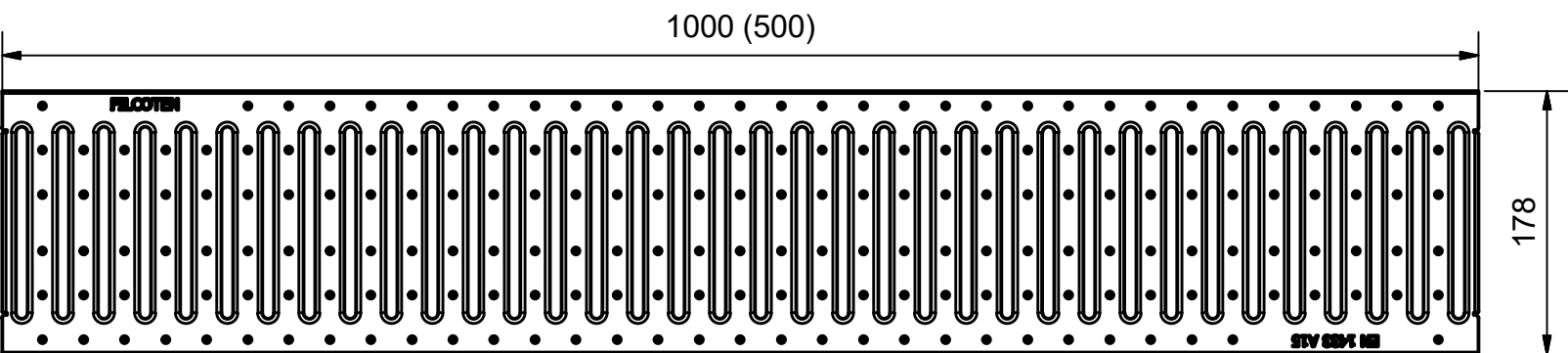

Gitterrost / Mesh grating: MW 30/10, B125
BG code: V 17015210 (17015211); 4,6 kg (2,3 kg):

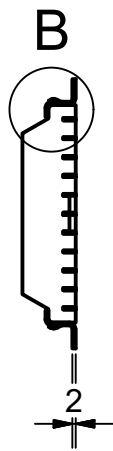
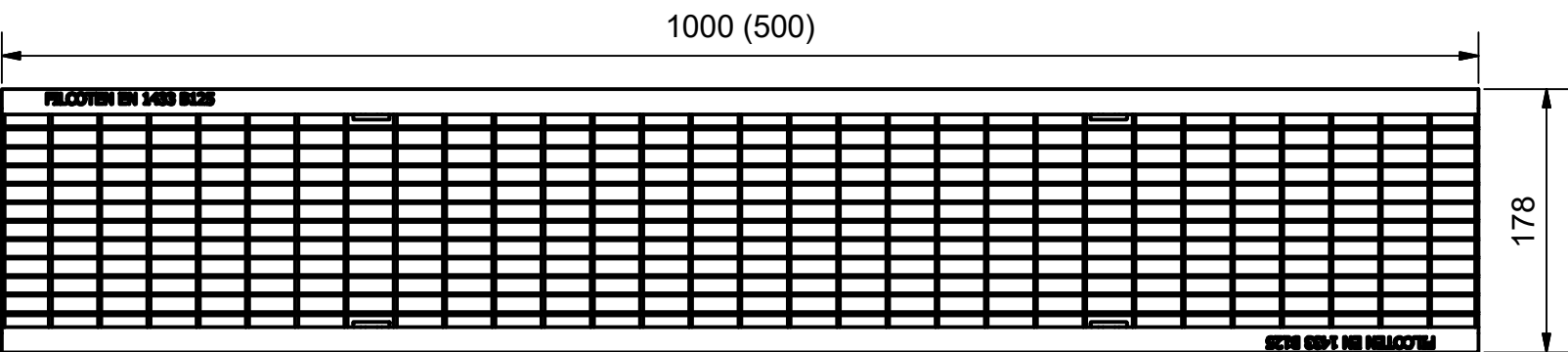

B (1 : 2)

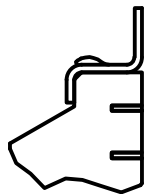

Gussrost / Ductile iron grating: MW 15/28, C250
BG code: GJS 17015100; 4,6 kg:

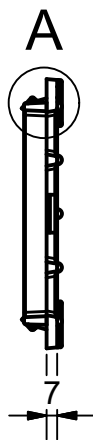
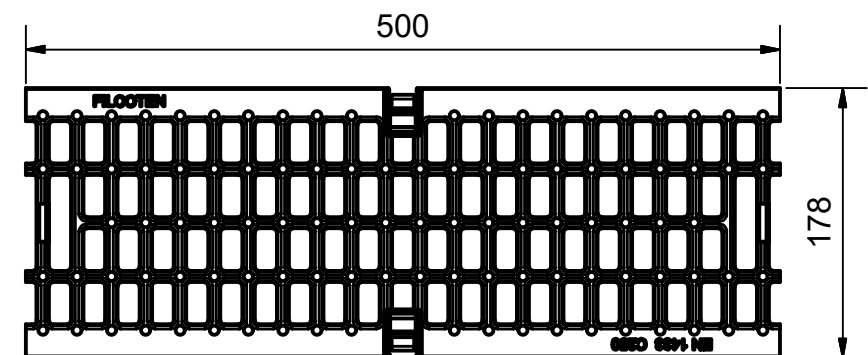

A (1 : 2)

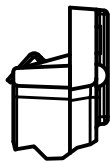

Schlitzaufsatz / slot top:

Schlitzaufsatz SW 12,5mm, SH 110, Kl. C250
BG code: V 17115243 (17115244), E 17115343 (17115344); 6,6 kg (3,3 kg):

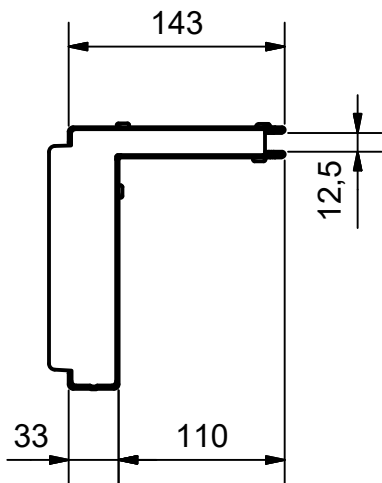
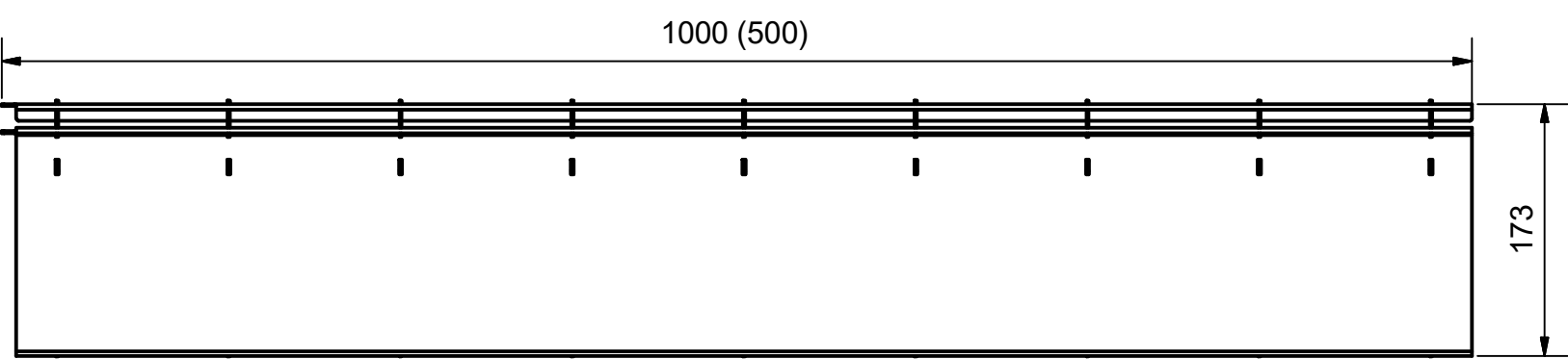

Revisionsschacht SW 12,5mm, SH 110, Kl. C250
BG code: V 17115281, E 17115381; 5,9 kg:

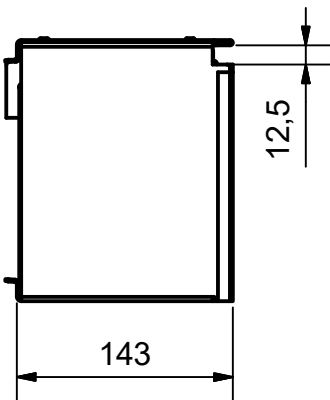
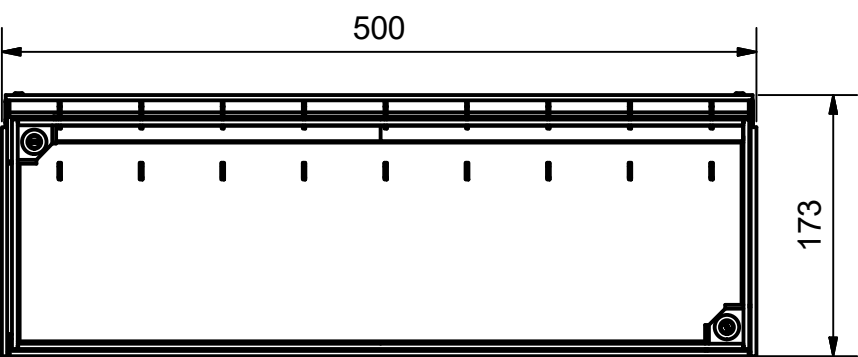

Schlitzaufsatz SW 2x6mm, SH 110, Kl. C250
BG code: V 17116204 (17116205), E 17116304 (17116305); 7,2 kg (3,6 kg):

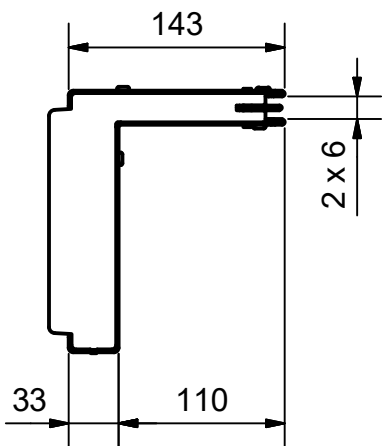
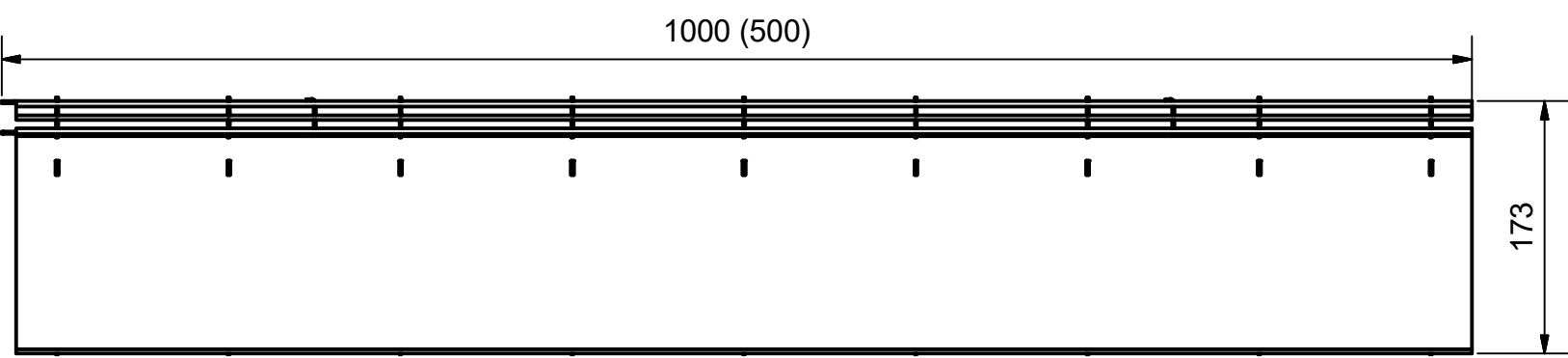

Revisionsschacht SW 2x6mm, SH 110, Kl. C250
BG code: V 17116206, E 17116306; 6,8 kg:

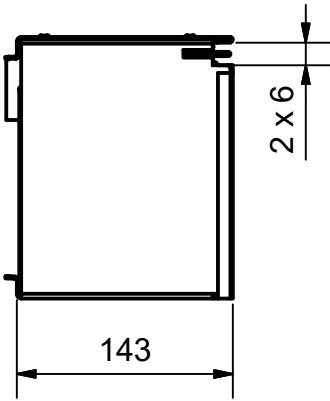
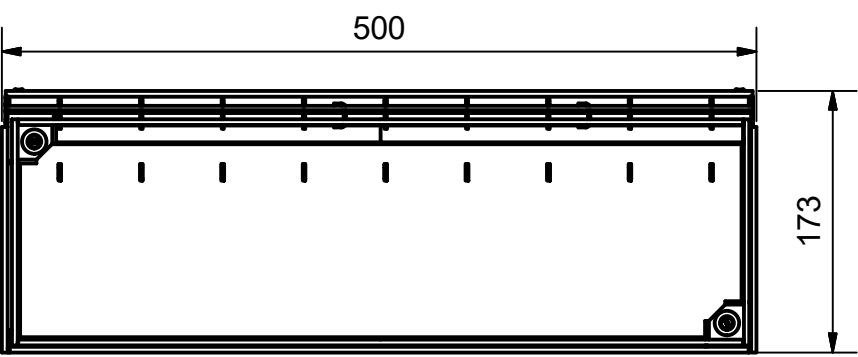

Bauzeitabdeckung / construction time barrier
BG code: H 37962; 0,1 kg:

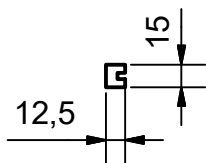
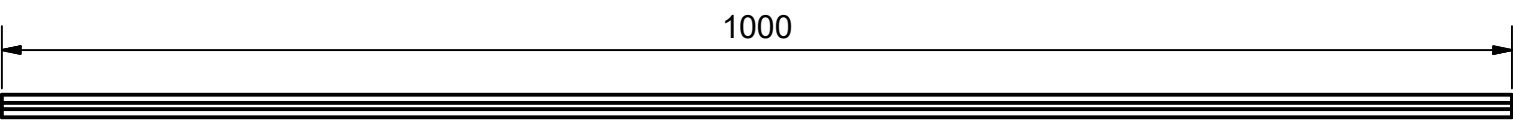

Abhebegriff / opening tool
BG code: V 13399; 0,1 kg:

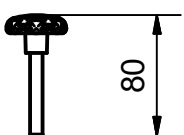

Legende / explanation:	
V:	verzinkter Stahl / galvanized steel
E:	Edelstahl / stainless steel
H:	Holz / wood

Sinkkasten / Sump unit:
inkl. Schlammmeimer / incl. silt bucket (22516; 0,3 kg)
BG code: FCT 10315092; 45,3 kg:

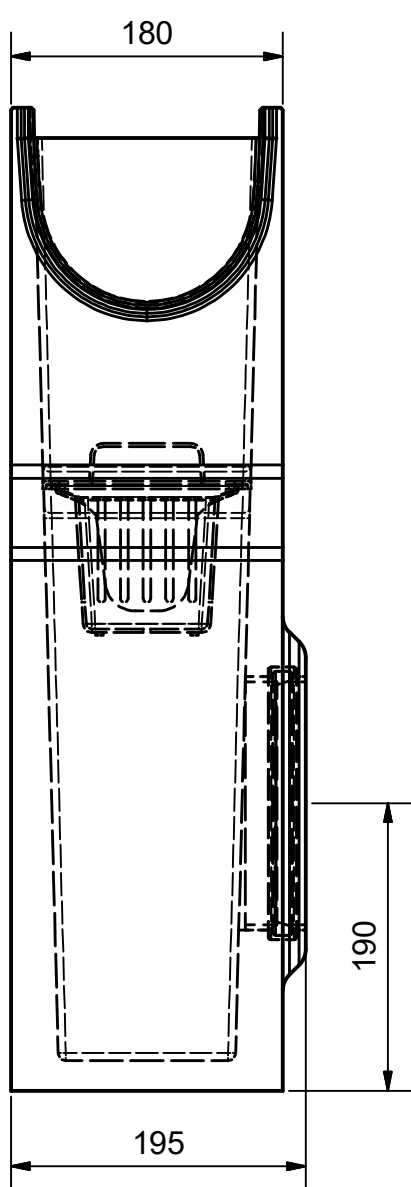
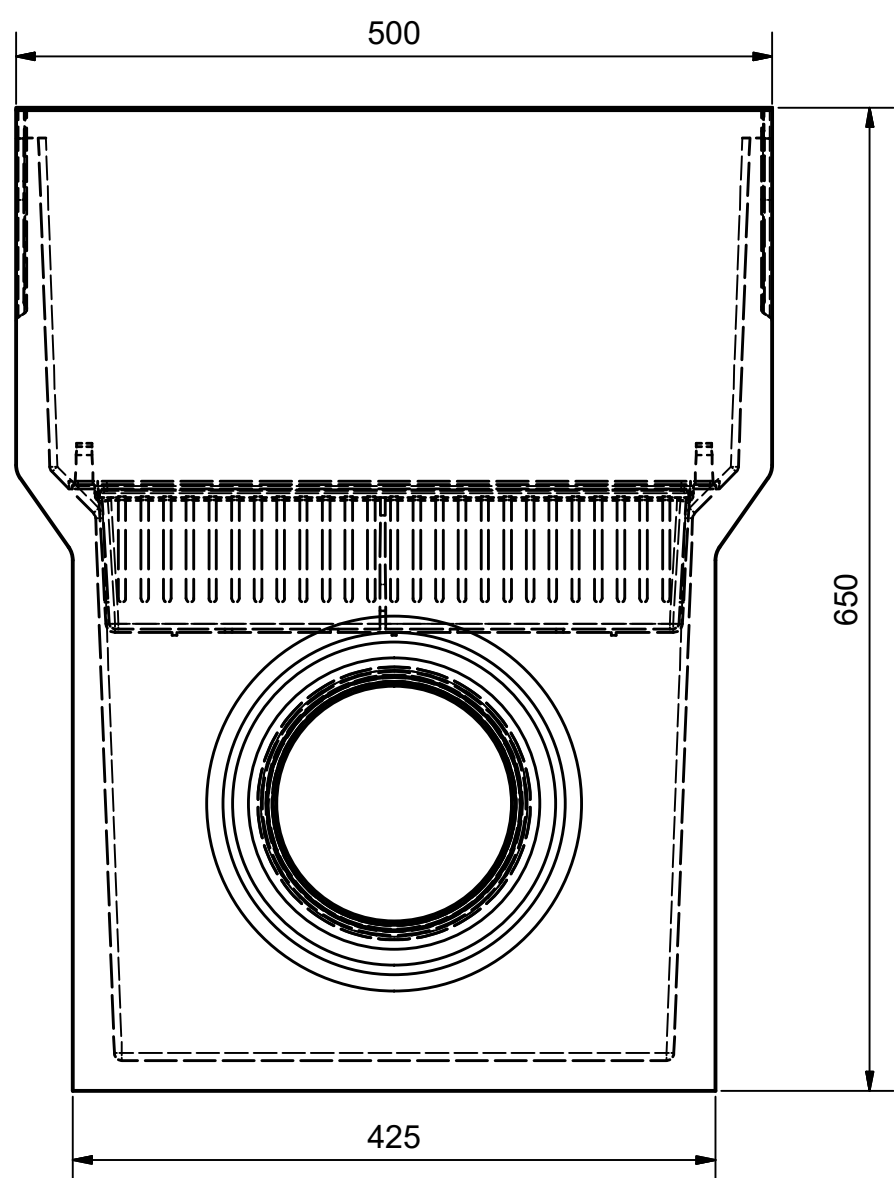

Endplatte / end cap:
BG code: V 19015230, E 19015330; 0,5 kg

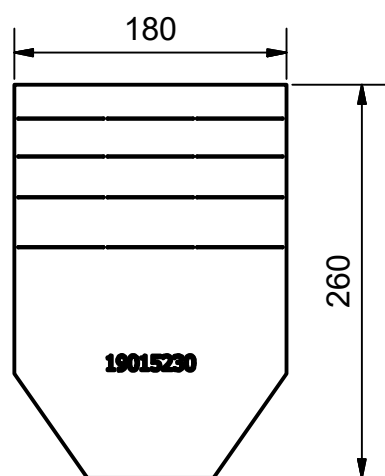

Stirnplatte mit Ablauf / end cap with outlet
BG code: V 19015232, E 19015332; 0,4 kg:

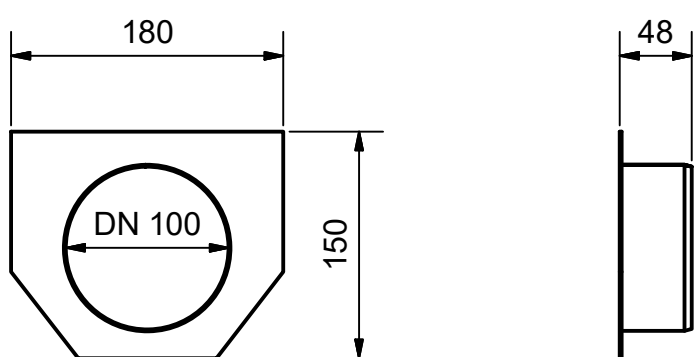

Patentklammer für Gitterrost /
locking clip for mesh grate
BG code: 32080; 0,1 kg:

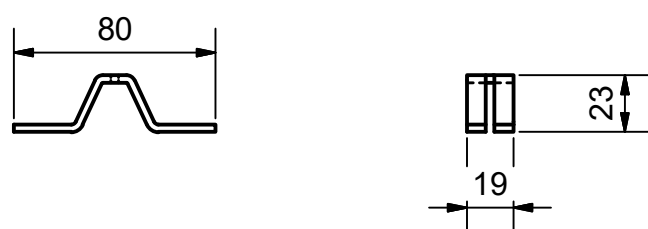

Patentklammer für Guss-Maschenrost /
locking clip for ductile iron mesh grate
BG code: 32067; 0,1 kg:



Halteklammer für Guss-Maschenrost /
fixing clip for ductile iron mesh grate
BG code: 32068; 0,1 kg:

