

ECOPHON COMBISON™ BARRIER

Ecophon Combison™ Barrier is an acoustic panel that is vertically installed above partitions in the plenum. Creates a sound barrier to improve the room to room sound insulation. Combison Barrier should be used together with other Ecophon systems for best acoustic performance.

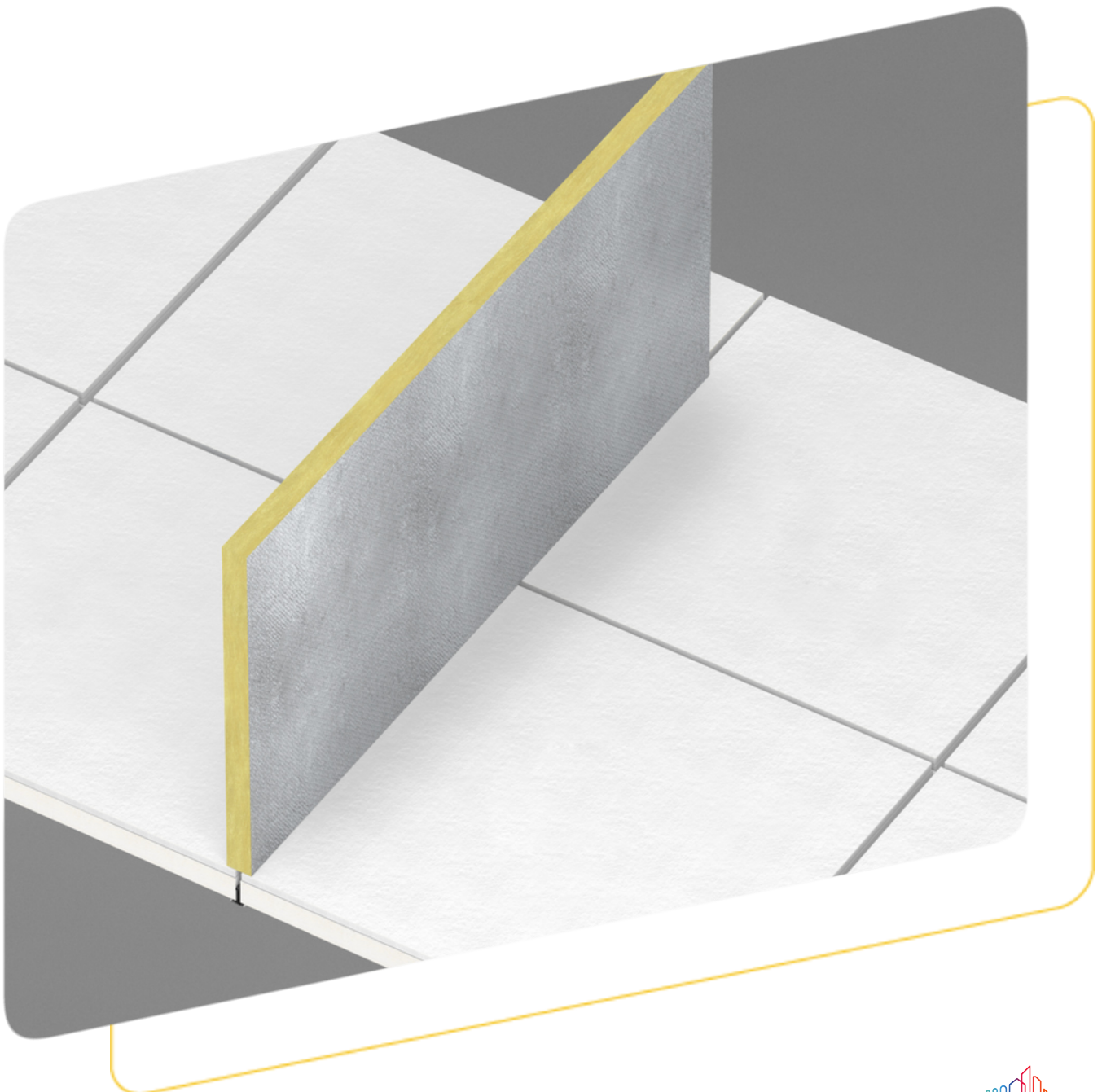

Ecophon Combison™ Barrier



SYSTEM RANGE

Size, mm	1200x600
Direct	•
Thickness	40
Inst. Diagr.	M160

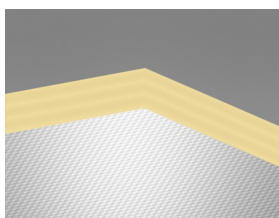

Combison Barrier tile



Combison Barrier system

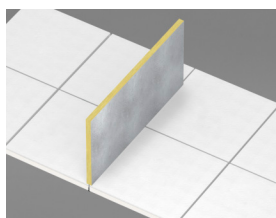

Technical image of acoustic panel Ecophon Combison Barrier vertically installed above partitions in the plenum

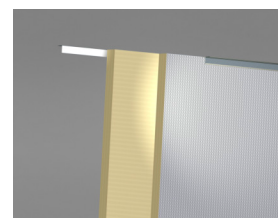

Section of Combison Barrier system

TYPE OF APPLICATION

- Healthcare
- Office



ACOUSTIC

For use as acoustic barrier above partitions in plenum to improve the room to room sound insulation. The Combison Barrier should be used together with other Ecophon systems.



CIRCULARITY

Fully recyclable.



FIRE SAFETY

The glass wool core of the tiles is tested and classified as non-combustible according to EN ISO 1182.

Country	Fire standard	Class
Europe	EN 13501-1	A2-s1,d0



HUMIDITY RESISTANCE

Class C, relative humidity 95% and 30°C, according to EN 13964:2014



VISUAL APPEARANCE

Not applicable. The panel has aluminium foil on one side.



CLEANABILITY

Not applicable.



ACCESSIBILITY

The tiles are demountable.



INSTALLATION

Installed according to installation diagrams, installation guides and drawing aid. For information regarding minimum overall depth of system see quantity specification.



PACKAGING INFORMATION

Information is indicative and subject to change.

	Edge	Panels / crt	m ² / crt
1200x600x40	Barrier	6	4.32



SYSTEM WEIGHT

Weight information is indicative and subject to variation.

	kg/m ²
Combison Barrier	3,3



MECHANICAL PROPERTIES

No additional live load is allowed.



CE

Ecophon ceiling systems are CE marked according to the European harmonized standard EN13964:2014. CE marked construction products are covered by a Declaration of Performance (DOP) which enables customers and users to easily compare performance of products available on the European market.

Barrier installation

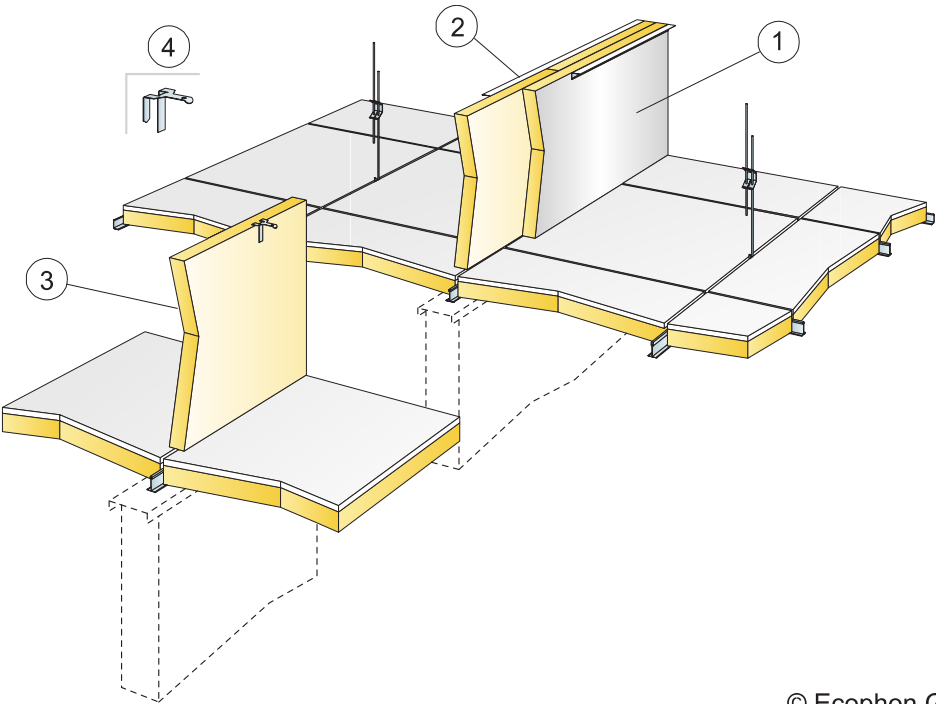

Installation diagram (M160) for Ecophon Combison Barrier

© Ecophon Group

Quantity specification (excl. wastage)

		Size, mm
		1200x600
1	Combison Barrier in double layers with displaced joints and exposed alu-foil side	as required
2	Connect Angle trims position upper part of Barrier panels	as required
3	Combison Barrier in single layer	as required
4	Connect Frieze bracket 0043 position upper part of Barrier panels	as required

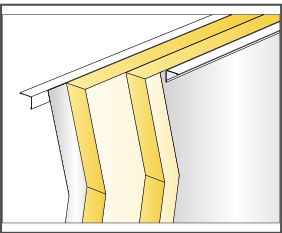

Double layers of Combison Barrier with Connect Angle trim

Size, mm	Max live load (N)	Min load bearing capacity (N)
1200x600x40	-	-

Live load/load bearing capacity