

Ecophon Fade™ Acoustic Plaster Albus

Direct to a suitable substrate installation: Install the acoustic board mechanically with special metal fixings from the manufacturer or install the acoustic board with approved adhesive on the suitable substrate.



Jalkasari School, Helsinki, Finland

SYSTEM RANGE

	Size, mm	1200x1200	1200x1200	1200x1200	1200x1200
		•	•	•	•
	Direct	•	•	•	•
	Suspended	•	•	•	•
	Thickness	15	20	25	40
	Inst. Diagr.	M549, M556, M551, M550, M557	M549, M556, M551, M550, M557	M549, M556, M551, M550, M557	M549, M556, M551, M550, M557



Acoustic

Sound Absorption:

Test results according to EN ISO 354. Classification according to EN ISO 11654, and the single value ratings for Noise Reduction Coefficient, NRC and Sound Absorption Average, SAA according to ASTM C 423.

α_p , Practical sound absorption coefficient

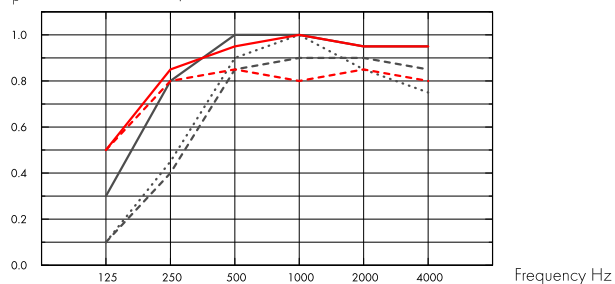

- Fade™ Albus, 20 mm, 23 mm o.d.s.
 - Fade™ Albus, 25 mm, 28 mm o.d.s.
 - Fade™ Albus, 40 mm, 43 mm o.d.s.
 - Fade™ Albus, 20 mm, 200 mm o.d.s.
 - Fade™ Albus, 40 mm, 200 mm o.d.s.
- o.d.s = overall depth of system

THK mm	o.d.s. mm	α_p , Practical sound absorption coefficient						α_w	Sound absorption class
		125 Hz	250 Hz	500 Hz	1000 Hz	2000 Hz	4000 Hz		
20	23	0.10	0.40	0.85	0.90	0.90	0.85	0.70	C
25	28	0.10	0.45	0.90	1.00	0.85	0.75	0.75	C
40	43	0.30	0.80	1.00	1.00	0.95	0.95	1.00	A
20	200	0.50	0.80	0.85	0.80	0.85	0.80	0.85	B
40	200	0.50	0.85	0.95	1.00	0.95	0.95	1.00	A

THK mm	o.d.s. mm	NRC	SAA
25	28	0.80	0.80
40	43	1.00	
40	200	1.00	



Indoor Air Quality

Certificate / Label	
French VOC	A+
Finnish M1	•





Environmental Footprint

	kg CO ₂ equiv/m ²		kg CO ₂ equiv/kg	Life-cycle stages A1 to A3 from EPD, in conformity with ISO 14025 / EN 15804
Acoustic boards for Fade™ 15 mm	2,79	Fade™ Albus - Acoustic Plaster	0,45	
Acoustic boards for Fade™ 20 mm	3,65			
Acoustic boards for Fade™ 25 mm	4,51			
Acoustic boards for Fade™ 40 mm	6,01			



Fire safety

Country		Class	The glass wool core of the tiles is tested and classified as non-combustible according to EN ISO 1182. Fire test, E 84-11a.
Europe	EN 13501-1	A2-s1,d0	



Humidity Resistance

Resistance to Humidity (RH 100%, 40°C) - ISO DS/EN 6270-2



Visual appearance

White NCS S 0500-N, CIE Y=79% light reflectance. Gloss < 1. Colours may vary slightly between different production batches.



Cleanability

Surface dust and dirt can be vacuumed off using a soft brush attachment or blown off using pressurised air.



Accessibility

The system supports installation of inspection hatch according to installation diagrams.



Installation

Installed according to installation diagrams, installation guides and drawing aid. For information regarding minimum overall depth of system see quantity specification. When installing direct-to-grid the installer must ensure that the building is airtight to prevent dust deposits from airflow through the open-pored acoustic plaster system.



System weight

The weight of the system (including suspension grid) should be approximately M549/M558 ≈ 2,5 - 5,2 kg/m², M550/M559 ≈ 14,3 - 17 kg/m², M551/M560 ≈ 5,3 - 8 kg/m².



Mechanical properties

Additional load (lighting, ventilation, etc.) should be supported by the suspension system according to the manufacturers recommendation or be hung directly from the soffit.



CE

Fade™ ceiling systems are CE marked according to the European harmonized standard EN 13964:2014. CE marked construction products are covered by a Declaration of Performance (DOP) which enables customers and users to easily compare performance of products available on the European market.

INSTALLATION DIAGRAM (M549) FOR FADE™ ACOUSTIC ALBUS DIRECT INSTALLATION

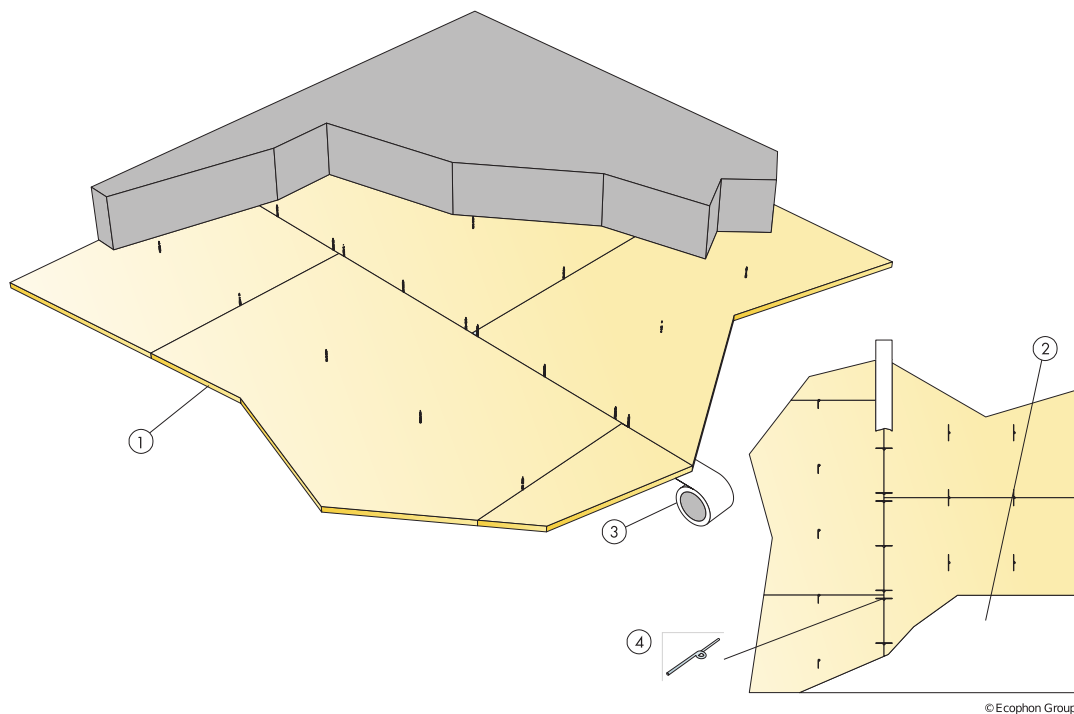

QUANTITY SPECIFICATION (EXCL. WASTAGE)

		Size, mm
		1200x1200
1	Ecophon Acoustic board for Fade™	0,7/m²
2	Fade™ Acoustic Plaster Albus (valid for standard white)	3,7kg/m²
3	EU Fade™ Special joint tape (every seem on tiles)	1,7m/m²
4	Fade™ Special washer (fixed with appliable screw)	8pcs/m²
Δ Min. overall depth of system: 23 mm		-
δ Min. demounting depth: The system is non-demountable		-

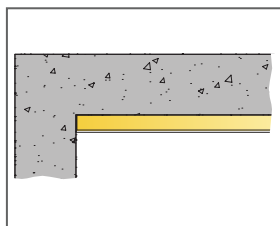

Size, mm	Max live load (N)	Min load bearing capacity (N)
1200x1200x15	0	0
1200x1200x20	0	0
1200x1200x25	0	0
1200x1200x40	0	0

Live load/load bearing capacity

INSTALLATION DIAGRAM (M556) FOR FADE™ ACOUSTIC ALBUS DIRECT INSTALLATION WITH GLUE

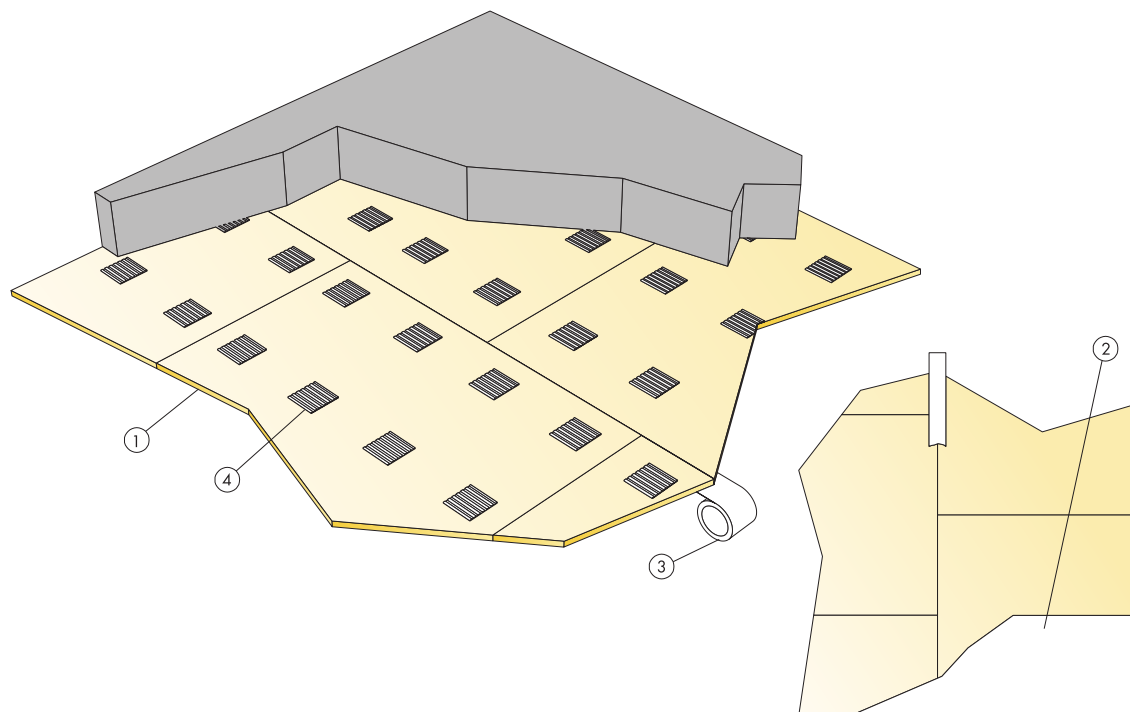

QUANTITY SPECIFICATION (EXCL. WASTAGE)

		Size, mm
		1200x1200
1	Ecophon Acoustic board for Fade™	0,7/m²
2	Fade™ Acoustic Plaster Albus (valid for standard white)	3,7kg/m²
3	EU Fade™ Special joint tape (every seem on tiles)	1,7m/m²
4	Fade™ Special Adhesive 10kg	0,83kg/m²
Δ Min. overall depth of system: 23 mm		-
δ Min. demounting depth: The system is non-demountable		-

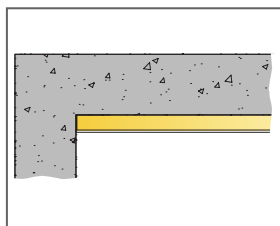

Size, mm	Max live load (N)	Min load bearing capacity (N)
1200x1200x15	0	0
1200x1200x20	0	0
1200x1200x25	0	0
1200x1200x40	0	0

Live load/load bearing capacity

INSTALLATION DIAGRAM (M551) FOR FADE™ ACOUSTIC ALBUS DIRECT GRID

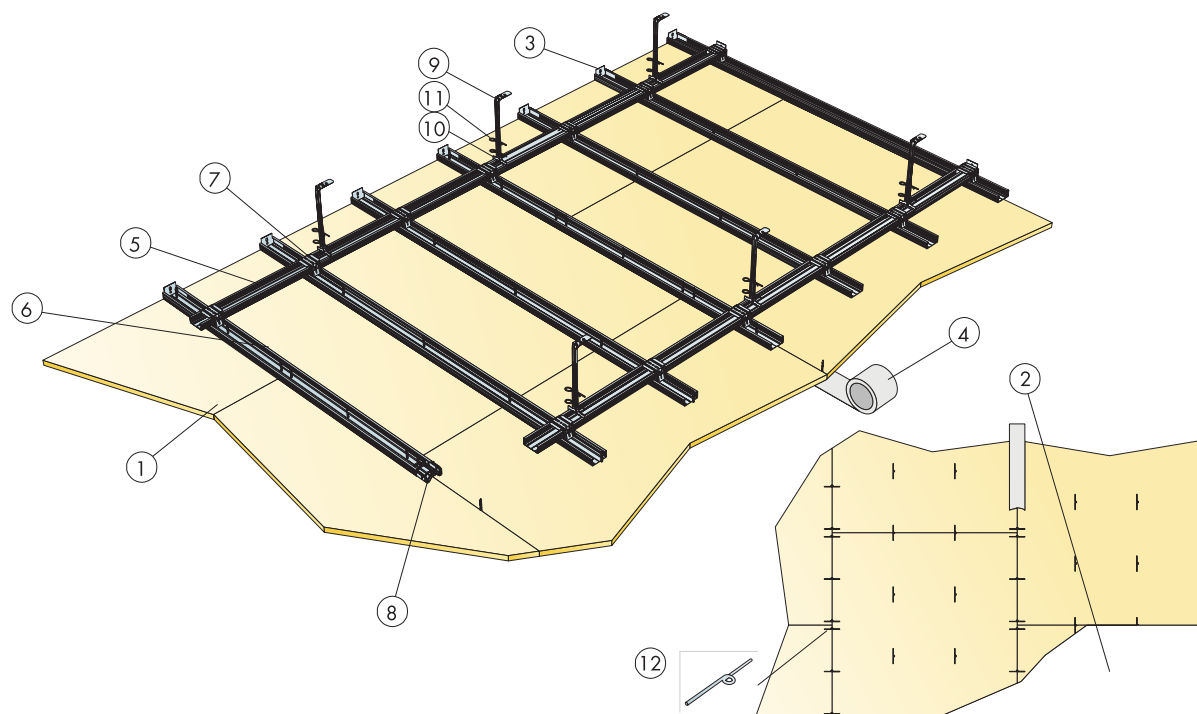

QUANTITY SPECIFICATION (EXCL. WASTAGE)

		Size, mm
		1200x1200
1	Ecophon Acoustic board for Fade™	0,7/m²
2	Fade™ Acoustic Plaster Albus (valid for standard white)	3,7kg/m²
3	Connect Wall bracket Plus	as required
4	EU Fade™ Special joint tape (every seem on tiles)	1,7m/m²
5	Connect C-profile Plus, L=3100 mm, installed 1200 mm centres	0,9m/m²
6	Connect C-profile Plus, L=3100 mm, installed 400 mm centres	2,5m/m²
7	Connect X-connector Plus	3,2/m²
8	Connect Splice connector Plus	1,2/m²
9	Connect Nonius hanger upper, installed at 800 mm centres	1,6/m²
10	Connect Nonius hanger lower, installed at 800 mm centres	1,6/m²
11	Connect Split pin (2/hanger)	3,2/m²
12	Fade™ Special washer (fixed with applicable screw)	8pcs/m²
Δ Min. overall depth of system: 310 mm		-
δ Min. demounting depth: The system is non-demountable		-

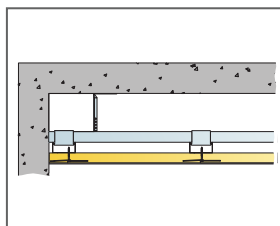

Size, mm	Max live load (N)	Min load bearing capacity (N)
1200x1200x15	50	220
1200x1200x20	50	220
1200x1200x25	50	220
1200x1200x40	50	220

Live load/load bearing capacity

INSTALLATION DIAGRAM (M550) FOR FADE™ ACOUSTIC ALBUS DIRECT SUSPENDED

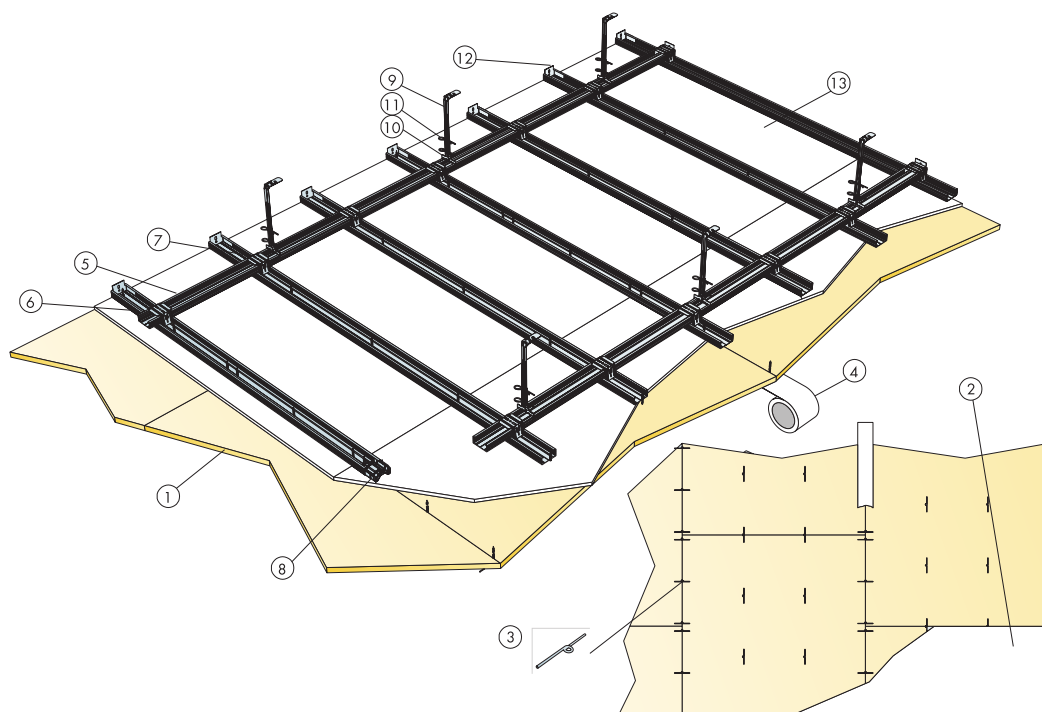

QUANTITY SPECIFICATION (EXCL. WASTAGE)

		Size, mm
		1200x1200
1	Ecophon Acoustic board for Fade™	0,7/m²
2	Fade™ Acoustic Plaster Albus (valid for standard white)	3,7kg/m²
3	Fade™ Special washer (fixed with applicable screw)	8pcs/m²
4	EU Fade™ Special joint tape (every seem on tiles)	1,7m/m²
5	Connect C-profile Plus, L=3100 mm, installed 1200 mm centres	0,9m/m²
6	Connect C-profile Plus, L=3100 mm, installed 400 mm centres	2,5m/m²
7	Connect X-connector Plus	3,2/m²
8	Connect Splice connector Plus	1,2/m²
9	Connect Nonius hanger upper, installed at 800 mm centres	1,6/m²
10	Connect Nonius hanger lower, installed at 800 mm centres	1,6/m²
11	Connect Split pin (2/hanger)	3,2/m²
12	Connect Wall bracket Plus	as required
13	Plasterboard (not supplied by Ecophon)	-
Δ Min. overall depth of system: 310 mm		-
δ Min. demounting depth: The system is non-demountable		-

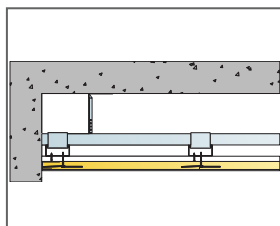

Size, mm	Max live load (N)	Min load bearing capacity (N)
1200x1200x15	50	220
1200x1200x20	50	220
1200x1200x25	50	220
1200x1200x40	50	220

Live load/load bearing capacity

INSTALLATION DIAGRAM (M557) FOR FADE™ ACOUSTIC ALBUS DIRECT SUSPENDED WITH GLUE

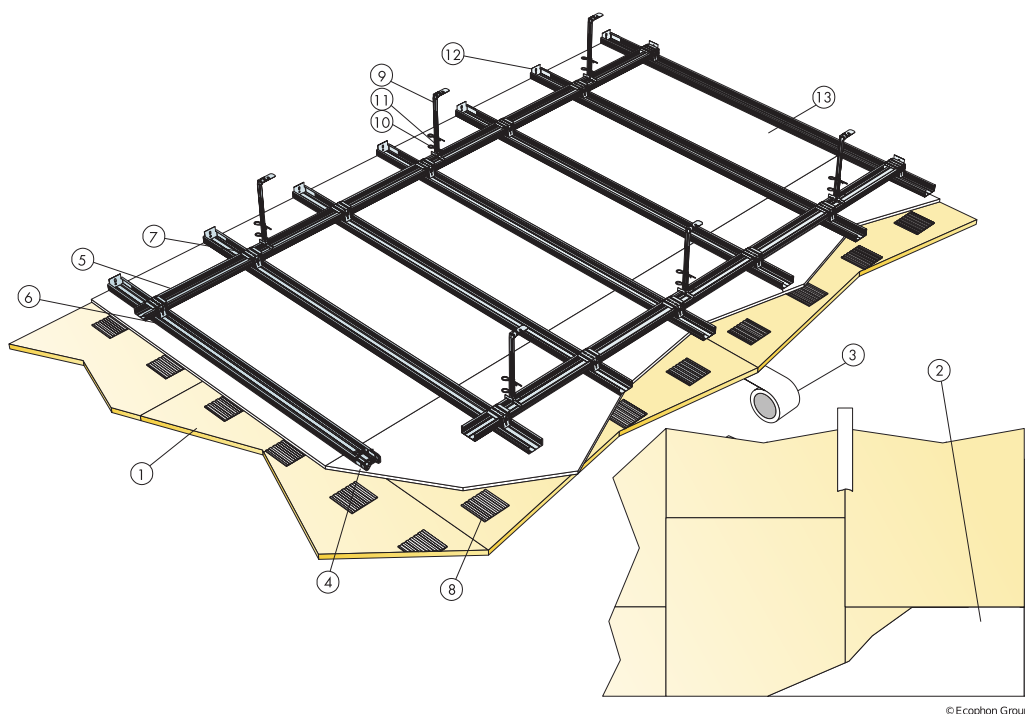

QUANTITY SPECIFICATION (EXCL. WASTAGE)

		Size, mm
		1200x1200
1	Ecophon Acoustic board for Fade™	0,7/m²
2	Fade™ Acoustic Plaster Albus (valid for standard white)	3,7kg/m²
3	EU Fade™ Special joint tape (every seem on tiles)	1,7m/m²
4	Connect Splice connector Plus	1,2/m²
5	Connect C-profile Plus, L=3100 mm, installed 1200 mm centres	0,9m/m²
6	Connect C-profile Plus, L=3100 mm, installed 400 mm centres	2,5m/m²
7	Connect X-connector Plus	3,2/m²
8	Fade™ Special Adhesive 10kg	0,83kg/m²
9	Connect Nonius hanger upper, installed at 800 mm centres	1,6/m²
10	Connect Nonius hanger lower, installed at 800 mm centres	1,6/m²
11	Connect Split pin (2/hanger)	3,2/m²
12	Connect Wall bracket Plus	as required
13	Plasterboard (not supplied by Ecophon)	-
Δ Min. overall depth of system: 310 mm		-
δ Min. demounting depth: The system is non-demountable		-

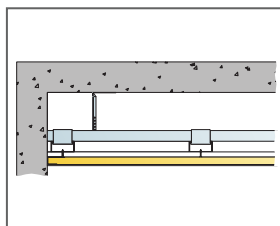

Size, mm	Max live load (N)	Min load bearing capacity (N)
1200x1200x15	50	220
1200x1200x20	50	220
1200x1200x25	50	220
1200x1200x40	50	220

Live load/load bearing capacity