

PRODUCT RANGE - COMPOSITE DOOR

FEATURES

FRAME OFFERING

- Dedicated composite door outerframe height of 68mm with matching sidelight frame.
- 88mm mullion for intergrated side and top light options.
- Choice of 2 sidelight transom/midrail heights of 72mm and 116mm.
- Aluminium disability low threshold with centre flipper seal.
- All sections available fully featured.

WEATHERSEALS

- Outerframes incorporate a triple sealing system which includes the Q-Lon flipper gasket for improved compression and weathering.
- Aluminium low threshold incorporating double sealing system.

REINFORCEMENT

- Dedicated galvanised steel and aluminium reinforcements.

FINISHES

- Framing predominantly white, for use with solid coloured slabs. Available in woodgrain finishes to match woodgrain effect door slabs.

GLAZING

- Fixed lights can be glazed with 24mm and 28mm unit widths, dedicated beads for glazing 44m slabs.

ANCILLARIES

- A comprehensive range of ancillaries, including add-ons, corner posts and couplers.



HARDWARE

- Designed to accept multi-point locks and various hinge types to achieved desired security levels.
- Handles, hinges and letterplates available in white, black, gold and chrome.

VENTILATION

- Proprietary ventilation devices can be used on all designs.
- A range of head details available including head extensions and one piece head vent with facility of recessed outer grill.

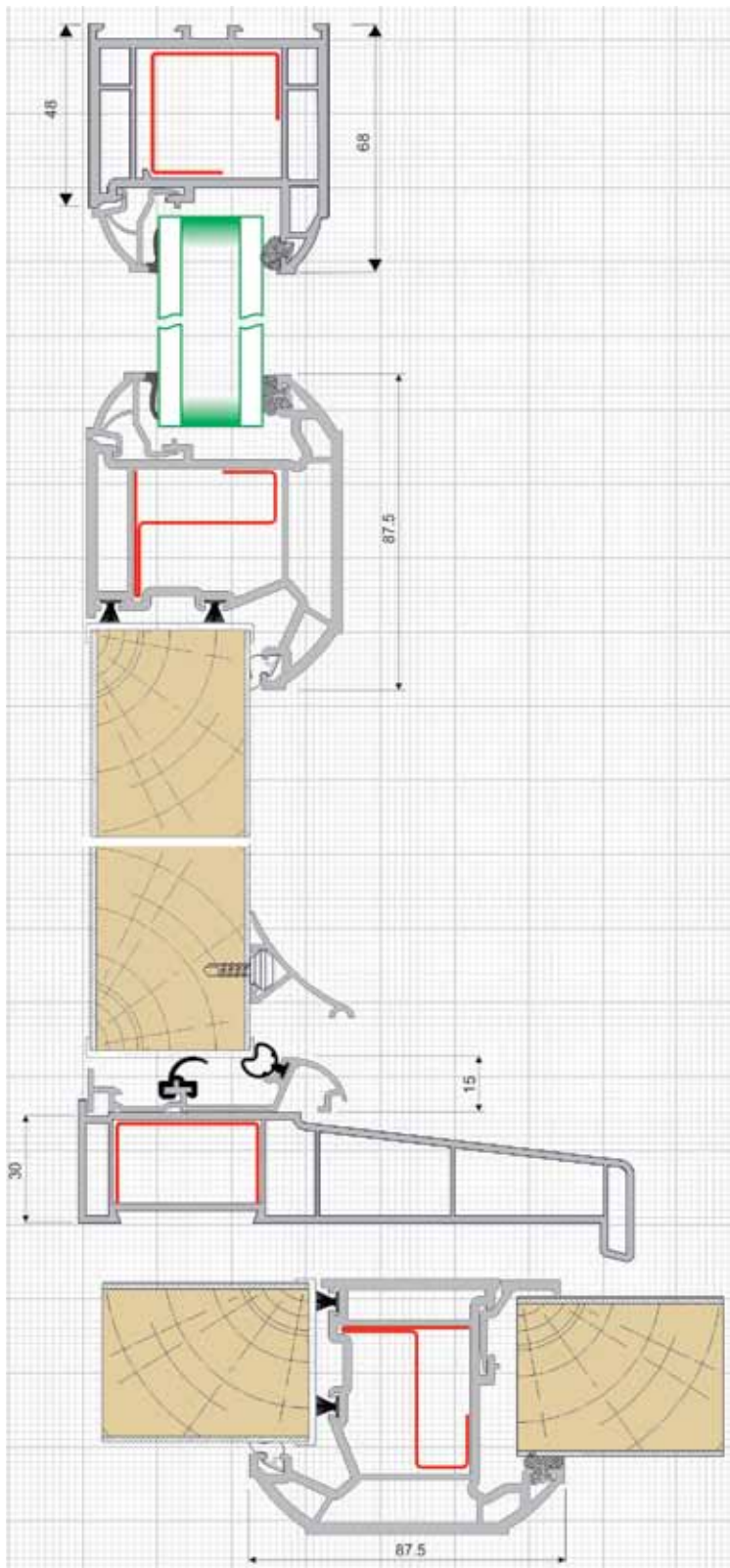

Scale 1:2

PERFORMANCE

SECURITY

- Multi-point high security locks available with hook and deadbolt locking to achieve Secured By Design status.

THERMAL/ACOUSTIC

- No Energy Rating system exists currently for doors (April 2011) although a scheme is expected to be introduced during summer 2011.
- 'U' value simulations have been carried out to ensure the revised Building Regulations of October 1st 2010 are met. Further detailed simulations are being carried out and added to our already comprehensive portfolio.



GENERAL FEATURES

