

PRODUCT RANGE - PIVOT WINDOW



FEATURES

FRAME OFFERING

- Choice of 2 outerframe heights - 56mm and 68mm.
- Choice of 3 transom heights - 63mm with dedicated half frame.
- Dedicated sash.
- All sections available fully featured and bevelled.

WEATHERSEALS

- High performance Q-Lon gasket supplied in all mainframe sections.

REINFORCING

- Galvanised steel range to suit topography requirements.
- Aluminium range for mechanical joint requirements.
- Range of thermal reinforcements for higher 'U' value and ERP requirements.
- All reinforcements are designed to achieve required security and weathering requirements.

FINISHES

- Warm white and brilliant white, on non lead PVC-u.
- Range of solid colour and woodgrain foils.

GLAZING

- Choice of 3 glazing thicknesses - 24mm, 28mm double glazed units and 36mm triple glazed.
- Astrical, Georgian bars in 20mm and 28mm widths.

ANCILLARIES

- Comprehensive range of add-ons, couplers, corner posts, bay poles available to suit any installation.

HARDWARE

- Full depth eurogroove, accept espagnolette, shootbolt and perimeter locking with shootbolts.

VENTILATION

- Proprietary ventilation devices can be used on all designs.
- A range of head details available including large outerframe, head extension and dedicated one piece head vent (see cavity closer for further details).

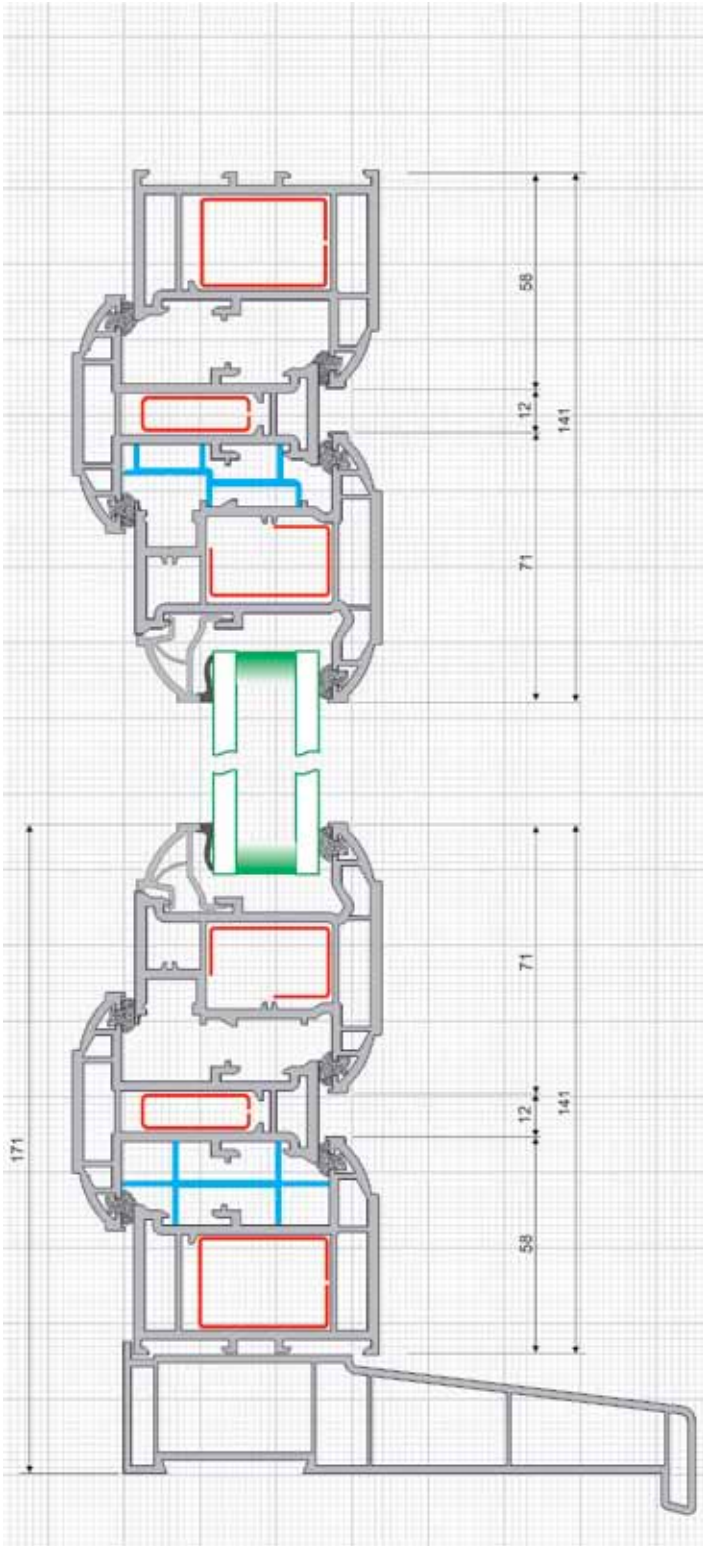

Scale 1:2

PERFORMANCE

SECURITY

- Range of hardware with full perimeter locking options. 180° pivot hinges with 22° and 180° restriction.



GENERAL FEATURES

