

MATERIAL FEATURES

GLASS FIBER COMPOSITE	Glass-fibre reinforced, with mineral fillers, additive (UP-GF)
TENSILE STRENGTH	65 N/mm ² (ISO 527)
BENDING STRENGTH	120 N/mm ² (ISO 14125)
ELASTICITY MODULE	10.000 N/mm ² (ISO 14125)
DENSITY	2,0 g/cm ³ (ISO 1172)
LINEAR EXPANSION COEFFICIENT	1,5 - 2,0 x 10 ⁻⁵ 1/K
HEAT RESISTANCE	100°C permanent exposure, short-term exposure (5 min.) to 200° C
FROST RESISTANCE	-35°C
WATER PENETRATION DEPTH	0 mm
WATER ABSORBITION	0,078 % (DIN EN ISO 62:2008-05 procedure 1)
MATERIAL STRUCTURE	Capillary free

PURPOSE

Component for the line drainage of surfaces in order to collect, transport and discharge rainwater from adjacent fixed surfaces

**MEAHOME PLUS
DRAINAGE CHANNEL INCLUDING COVERS**

Car-passable drainage channel body without fall made of glass-fibre-reinforced composite material, including slotted grating made of galvanised steel or TSC Topslot. Clear width 95 mm, total width 131 mm. Suitable for all channel covers **MEA 100 CLIPFIX**, **MEA 100 TOPFIX**, **Topslots TSL 100** and **TSC 100**. Loading classes A 15 to B 125 according to EN 1433.

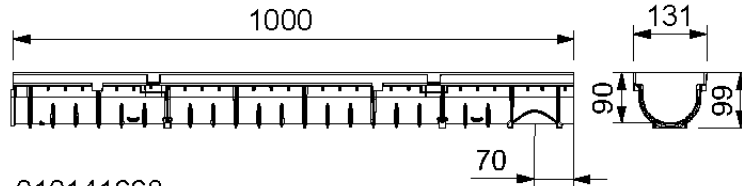

010141668

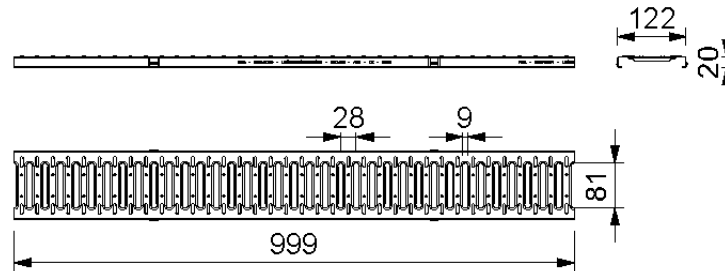

010141704

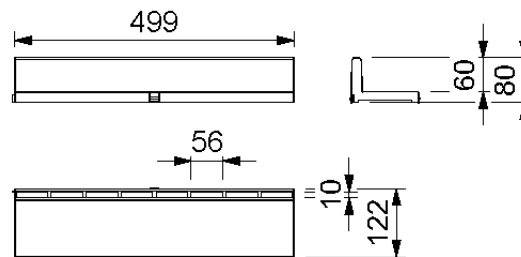

010152860

MEAHOME PLUS - COMPLETE DRAINAGE CHANNEL SUITABLE FOR PASSENGER CARS

Designation	Ord. No.	Length [mm]	Height [mm]	kg/unit
MEAHOME PLUS complete drainage channel with galvanised slotted grating TX 1) 22)	010141690	1000	100	2,50
MEAHOME PLUS BLACK complete drainage channel with galvanised slotted grating TX * 1) 22)	010141694	1000	100	2,50
MEAHOME PLUS BLACK complete channel with TSC TOPSLOT-1 m 1)	010141671	1000	99	2,10

*) Delivery time on demand.

1) Connection option for vertical drain Ø 110 mm.

22) Grating/grates loading class A 15 according to EN 1433.

MEAHOME PLUS BLACK/GREY DRAINAGE CHANNEL WITH GRP EDGE

Car-passable drainage channel body without fall made of glass-fibre-reinforced composite material. Clear width 95 mm, total width 131 mm. Suitable for all channel covers **MEA 100 CLIPFIX**, **MEA 100 TOPFIX**, **Topslots TSL 100** and **TSC 100**. Loading classes A 15 to B 125 according to EN 1433.

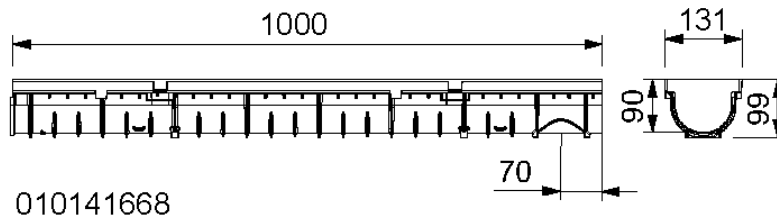

MEAHOME PLUS BLACK/GREY DRAINAGE CHANNEL, LOADING CLASS B 125 ACCORDING TO EN 1433

Designation	Ord. No.	Length [mm]	Height [mm]	kg/unit
MEAHOME PLUS BLACK drainage channel body -1 m 1)	010141668	1000	100	1,20
MEAHOME PLUS GREY drainage channel body -1 m 1)	010141683	1000	100	1,20

1) Connection option for vertical drain Ø 110 mm.

MEAHOME PLUS ACCESSORIES

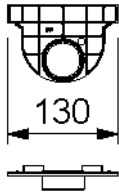

010141724

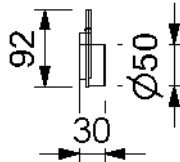

010141697

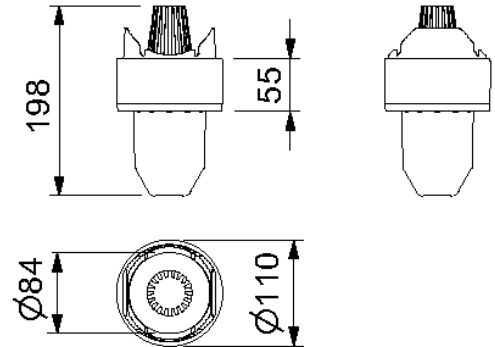

MEAHOME PLUS ACCESSORIES

Designation	Ord. No.	Height [mm]	Material	kg/unit
MEAHOME Drainage kit, contains vertical drainage connector Ø 110 mm with odour trap and sediment bucket	010141697	-	PP	0,17
MEAHOME PLUS.SE GREY End cap for channel start/end with possible connector Ø 50 mm	010141724	92	PP	0,05
MEAHOME PLUS.SE BLACK End cap for channel start/end with possible connector Ø 50 mm	010141729	92	PP	0,03
MEAHOME vertical drainage connection Ø 110 mm	010141695	-	PP	0,08

This edition of the technical data sheet shall be valid from May 2022 until a revised version is published, and replaces any previous publications. The respectively current version is available for download at www.mea-group.com.

MEA Bautechnik GmbH
 Business unit MEA Water Management
 Sudetenstraße 1
 86551 Aichach
 Tel.: +49 (0) 82 51. 91 0
 Fax: +49 (0) 82 51. 91 13 06
 E-Mail: info@mea-group.com
www.mea-group.com