



# Ecophon Akusto™ Wall Edge

## A

Ecophon Akusto™ Wall A has an exposed profile system with a variety of surface options. This wall absorber pairs with a sound absorbing ceiling to achieve excellent acoustic properties in the room.



P20 Office & Business, Poland

### SYSTEM RANGE

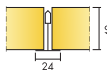

Size, mm	2700x1200
Channeltrim	•
Thinline	•
WP	•
Thickness	40
Inst. Diag.	M353, M504, M509

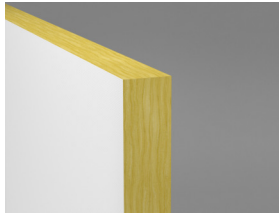

Akusto Wall A

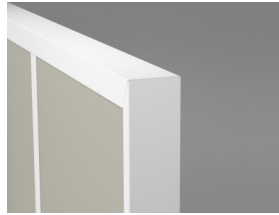

Akusto Wall A system with Connect Channel trim and Connect T24 Main runner

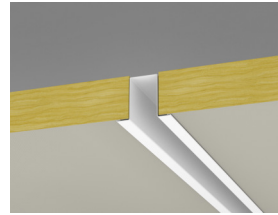

Akusto Wall A system with Connect Channel trim and Connect Recessed profile



Akusto Wall system with Connect Thinline profiles



## Acoustic

### Sound Absorption:

Test results according to EN ISO 354. Classification according to EN ISO 11654, and the single value ratings for Noise Reduction Coefficient, NRC and Sound Absorption Average, SAA according to ASTM C 423.

$\alpha_p$ , Practical sound absorption coefficient

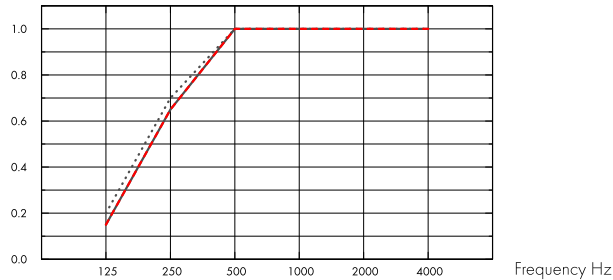

- ..... Akusto Wall A Akutex FT 40 mm, 43 mm o.d.s.
- Akusto Wall A Texona 40 mm, 43 mm o.d.s.
- Akusto Wall A Super G 40 mm, 43 mm o.d.s.

	THK mm	o.d.s. mm	$\alpha_p$ , Practical sound absorption coefficient						$\alpha_w$	Sound absorption class
			125 Hz	250 Hz	500 Hz	1000 Hz	2000 Hz	4000 Hz		
Akutex FT	40	43	0.20	0.70	1.00	1.00	1.00	1.00	1.00	A
Texona	40	43	0.15	0.65	1.00	1.00	1.00	1.00	1.00	A
Super G	40	43	0.15	0.65	1.00	1.00	1.00	1.00	0.95	A

THK mm	AC(1.5)
40	Articulation Class, ASTM E1111, ASTM E1110 230



## Indoor Air Quality

Certificate / Label	Standard	Plant
Eurofins Indoor Air Comfort®	IAC	IAC Gold
French VOC	A	A+
Finnish M1	•	•



## Environmental Footprint

	Kg CO <sub>2</sub> equiv/m <sup>2</sup>
Akusto Wall A	6,2 (Akusto Wall A EPD in conformity with ISO 14025 / EN 15804)
Akusto Wall A/Plant	7,33 (Akusto Wall/Plant family EPD in conformity with ISO 14025 / EN 15804)



### Circularity

Minimum post-consumer recycled content	53%
Recyclability	Fully recyclable



### Fire safety

Country	Standard	Class
Europe	EN 13501-1	A2-s1,d0

The glass wool core of the tiles is tested and classified as non-combustible according to EN ISO 1182.



### Humidity Resistance

Product	
Standard	Class C, RH 95% and 30°C
Plant	Class A, RH 70% and 25°C

According to EN 13964:2014



### Visual appearance

Akusto Wall in white has high light reflectance. Light reflectance and nearest NCS colour sample for all the different colours: See Ecophon Colours and surfaces.



### Cleanability

Daily dusting, vacuum cleaning and weekly wet wiping (Super G and Akutex FT surfaces). Weekly dusting and vacuum cleaning (Texona surface) as required.



### Accessibility

The tiles are not demountable except in selected installation diagrams. See quantity specification for more information.



### Installation

Installed according to installation diagrams, installation guides and drawing aid. For information regarding minimum overall depth of system see quantity specification. The systems should not be placed behind goals or similar areas where they are likely to be hit regularly. In such cases a protective net in front of the system is recommended.



### System weight

The weight of the system (including profile system) should be approximately 4 kg/m<sup>2</sup>.



### Mechanical properties

No additional live load is allowed.



### Impact Resistance

Surface	M-sketch
Super G	M353 Fulfills

Tested and classified according to EN 13964 annex D and fulfills the demands corresponding to DIN 18032 part 3. Texona surface has moderate impact resistance. Please note: Where the panels are subjected to frequent blows and impacts e.g. behind goal mouths, protection in form of e.g. restraining nets or wooden slats is required.

**CE**

---

Ecophon ceiling systems are CE marked according to the European harmonized standard EN 13964:2014. CE marked construction products are covered by a Declaration of Performance (DOP) which enables customers and users to easily compare performance of products available on the European market.

## INSTALLATION DIAGRAM (M353) FOR ECOPHON AKUSTO WALL A

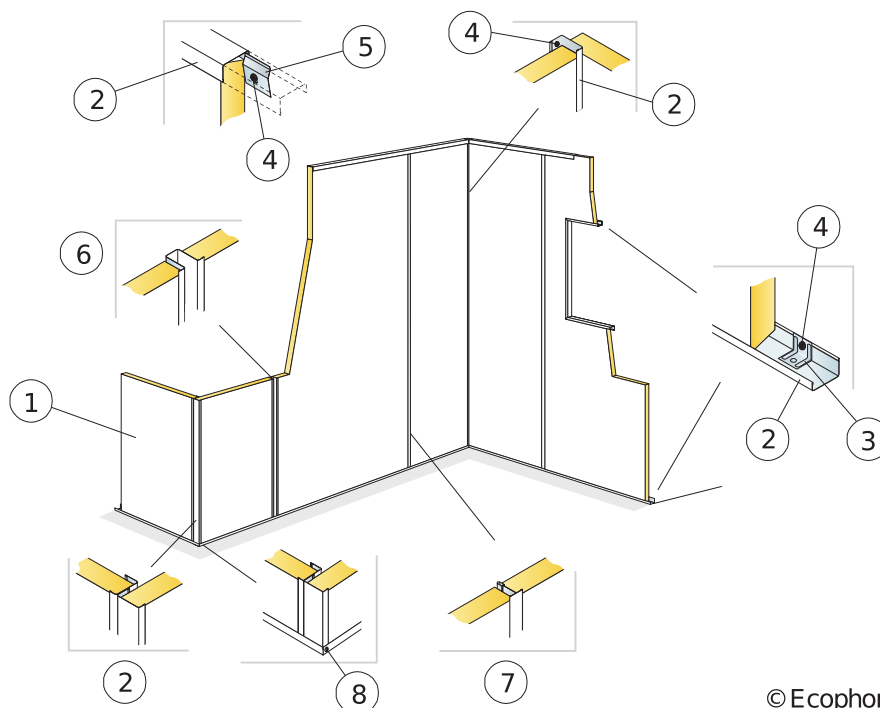

© Ecophon Group

### QUANTITY SPECIFICATION (EXCL. WASTAGE)

	Size, mm
	2700x1200
1 Ecophon Akusto Wall A	0,31/m <sup>2</sup>
2 Connect Channel trim, fixed at 300 mm centres. Connect Direct fixing plate is placed inside at each fixing point if the panel is not supported by the floor.	as required
3 Connect Direct fixing plate	as required
4 Connect Installation screw MVL (for use in plasterboard or timber)	as required
5 Connect Fixing bracket, fixed at 400 mm centres.	as required
6 Alt.1 Connect Recessed profile, (Installation: kept in position with the Channel trims)	as required
7 Alt.2 Connect T24 Main runner, not used in a impact resistant installation, (Installation: kept in position with the Channel trims)	as required
8 Connect Installation screw BR (2000 pcs)	as required
Δ Min. overall depth of system: 44 mm	-
For impact resistant installations: Use HD profiles and secure with additional Connect Installation screw BR where needed.	-

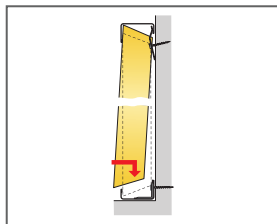
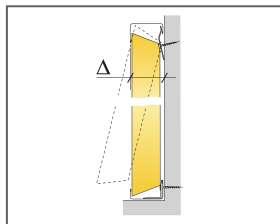

Detail of installation

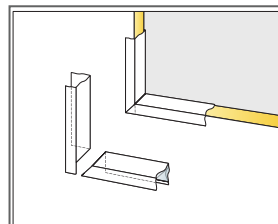

Cutting of channel trim for internal corner

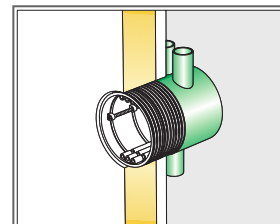

Accessories for adjusting electrical installations are available in electricity retail stores

## INSTALLATION DIAGRAM (M504) FOR ECOPHON AKUSTO WALL A

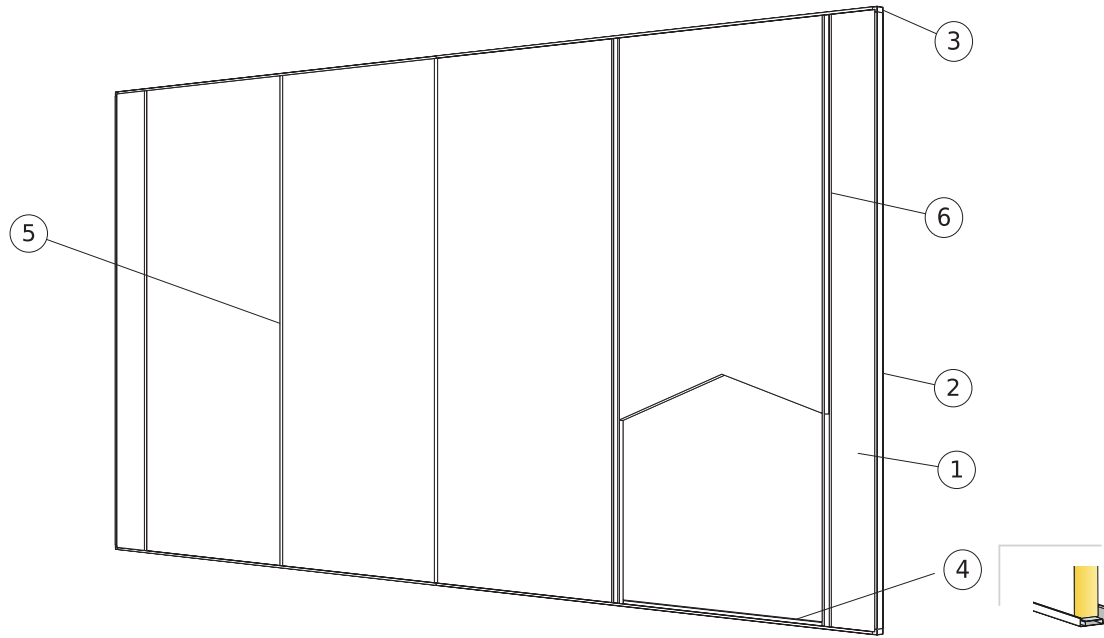

© Ecophon Group

### QUANTITY SPECIFICATION (EXCL. WASTAGE)

		Size, mm
		<b>2700x1200</b>
1	Ecophon Akusto Wall A	0,31/m <sup>2</sup>
2	Connect Channel trim, fixed at 300 mm centres	as required
3	Connect Channel trim corner	as required
4	Connect WP Space bar, L=2400 mm	as required
5	Connect T24 Main runner, (Installation: kept in position with the Channel trims)	as required
6	Alt.1 Connect Recessed profile, (Installation: kept in position with the Channel trims)	as required
Δ Min. overall depth of system: 44 mm		-
Connect Installation screw MVL (for use in plasterboard or timber)		as required

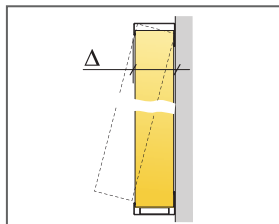

See Quantity specification

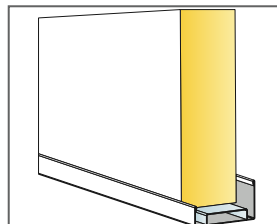

Installation with Channel trim and WP Space bar

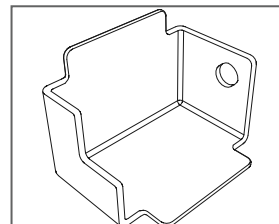

Connect Channel trim corner for 44mm profile

## INSTALLATION DIAGRAM (M509) FOR ECOPHON AKUSTO WALL A WITH CONNECT THINLINE PROFILES.

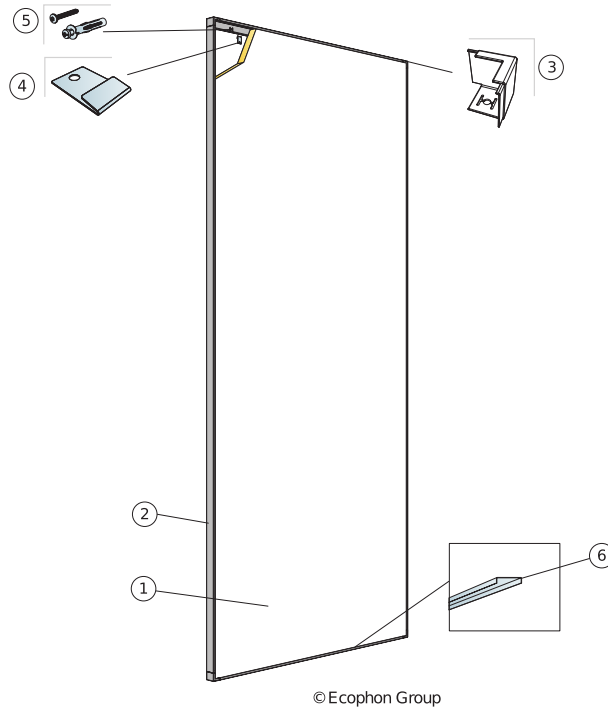

### QUANTITY SPECIFICATION (EXCL. WASTAGE)

		<b>Size, mm</b>
		<b>2700x1200</b>
1	Ecophon Akusto Wall A	0,31/m <sup>2</sup>
2	Connect Thinline Profile, L=2644 mm	as required
3	Connect Thinline Corner	as required
4	Connect Thinline Locking Clip	as required
5	Installation screw, installed at 400 mm centres (select fastener according to wall material)	as required
6	Connect Thinline Space Bar	as required
Δ Overall depth of system: 45 mm		-

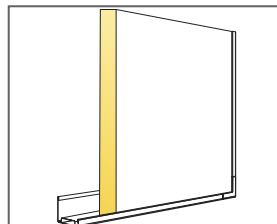
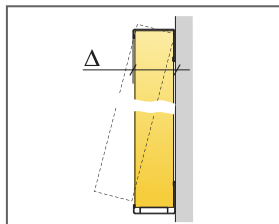

Detail of panel with Thinline frame

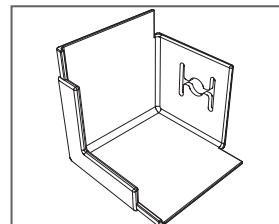

Detail of Thinline corner



# Ecophon Akusto™ Wall Edge C

Ecophon Akusto™ Wall C has a concealed grid and bevelled edge to create a narrow groove between each panel. Available in a variety of surface options. Excellent room acoustic properties are achieved when this wall absorber is paired with a sound absorbing ceiling.



Family image, Sweden

## SYSTEM RANGE

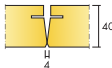

Size, mm	2700x600
Thinline	•
WP	•
Thickness	40
Inst. Diagr.	M497, M354, M355, M508



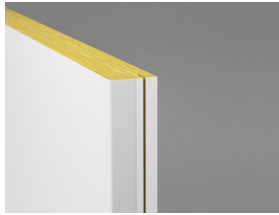

Akusto Wall C

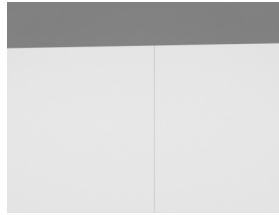

Section of Akusto Wall C System



Akusto Wall C system with Connect WP profile and external corner



Wall Panel C system with Connect WP profile and external corner



## Acoustic

### Sound Absorption:

Test results according to EN ISO 354. Classification according to EN ISO 11654, and the single value ratings for Noise Reduction Coefficient, NRC and Sound Absorption Average, SAA according to ASTM C 423.

$\alpha_p$ , Practical sound absorption coefficient

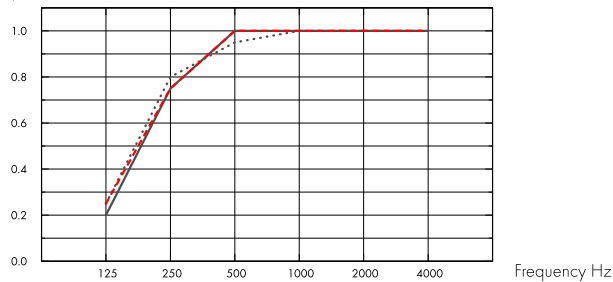

- ..... Akusto Wall C Akutex FT 40 mm, 43 mm o.d.s.
- Akusto Wall C Texona 40 mm, 43 mm o.d.s.
- Akusto Wall C Super G 40 mm, 43 mm o.d.s.

	THK mm	o.d.s. mm	$\alpha_p$ , Practical sound absorption coefficient						$\alpha_w$	Sound absorption class
			125 Hz	250 Hz	500 Hz	1000 Hz	2000 Hz	4000 Hz		
Akutex FT	40	43	0.25	0.80	0.95	1.00	1.00	1.00	1.00	A
Texona	40	43	0.20	0.75	1.00	1.00	1.00	1.00	1.00	A
Super G	40	43	0.25	0.75	1.00	1.00	1.00	1.00	1.00	A

THK mm	AC(1.5)
40	Articulation Class, ASTM E1111, ASTM E1110 240



## Indoor Air Quality

Certificate / Label	Standard	Plant
Eurofins Indoor Air Comfort®	IAC	IAC Gold
French VOC	A	A+
Finnish M1	•	•



## Environmental Footprint

	Kg CO <sub>2</sub> equiv/m <sup>2</sup>
Akusto Wall	4,88 (Akusto Wall family EPD in conformity with ISO 14025 / EN 15804)
Akusto Wall/Plant	7,33 (Akusto Wall/Plant family EPD in conformity with ISO 14025 / EN 15804)



### Circularity

Minimum post-consumer recycled content	60%
Recyclability	Fully recyclable



### Fire safety

Country	Standard	Class
Europe	EN 13501-1	A2-s1,d0

The glass wool core of the tiles is tested and classified as non-combustible according to EN ISO 1182.



### Humidity Resistance

Product	
Standard	Class C, RH 95% and 30°C
Plant	Class A, RH 70% and 25°C

According to EN 13964:2014



### Visual appearance

Akusto Wall in white has high light reflectance. Light reflectance and nearest NCS colour sample for all the different colours: See Ecophon Colours and surfaces.



### Cleanability

Daily dusting, vacuum cleaning and weekly wet wiping (Super G and Akutex FT surface). Weekly dusting and vacuum cleaning (Texona) as required.



### Accessibility

The tiles are not demountable except in selected installation diagrams. See quantity specification for more information.



### Installation

Installed according to installation diagrams, installation guides and drawing aid. For information regarding minimum overall depth of system see quantity specification. The systems should not be placed behind goals or similar areas where they are likely to be hit regularly. In such cases a protective net in front of the system is recommended.



### System weight

The weight of the system (including profile system) should be approximately 5 kg/m<sup>2</sup>.



### Mechanical properties

No additional live load is allowed.



### Impact Resistance

Surface	M-sketch
Super G	M354
	Fulfills

Tested and classified according to EN 13964 annex D and fulfills the demands corresponding to DIN 18032 part 3.



### CE

Ecophon ceiling systems are CE marked according to the European harmonized standard EN 13964:2014. CE marked construction products are covered by a Declaration of Performance (DOP) which enables customers and users to easily compare performance of products available on the European market.

## INSTALLATION DIAGRAM (M497) FOR ECOPHON AKUSTO WALL C VERTICAL INSTALLATION WITH CONNECT THINLINE PROFILES.

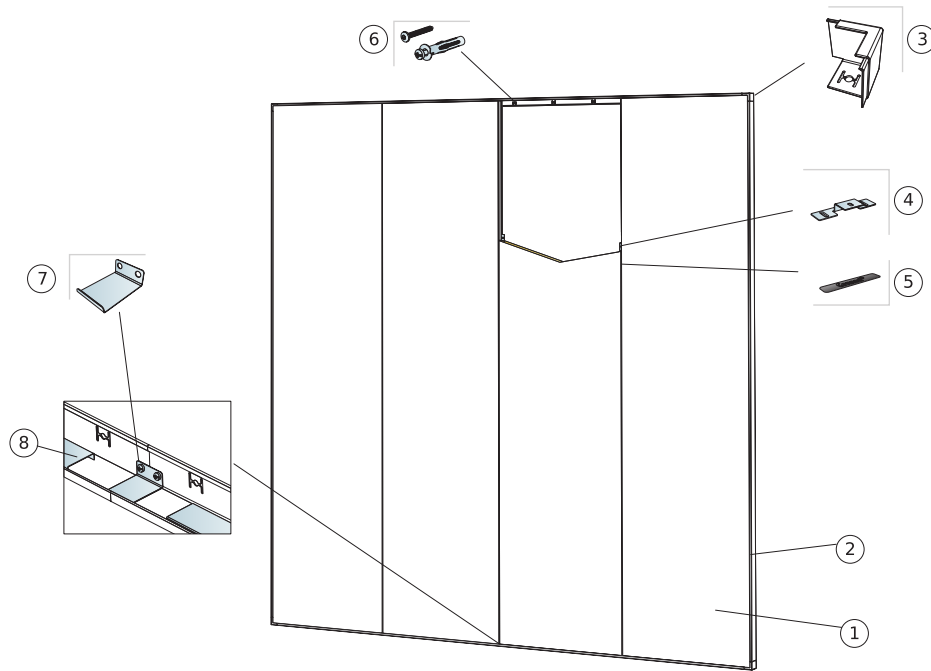

© Ecophon Group

### QUANTITY SPECIFICATION (EXCL. WASTAGE)

	<b>Size, mm</b>
	<b>2700x600</b>
1 Akusto Wall C	0,62/m <sup>2</sup>
2 Connect Thinline Profile, L=2644 mm	as required
3 Connect Thinline Corner	as required
4 Connect Fixing plate is mounted at 500 mm centres	as required
5 Connect Spline	as required
6 Installation screw, installed at 400 mm centres (select fastener according to wall material)	as required
7 Connect Thinline Splice. used to extend Thinline profiles where needed.	as required
8 Connect Thinline Space Bar	as required
Δ Overall depth of system: 45 mm	-

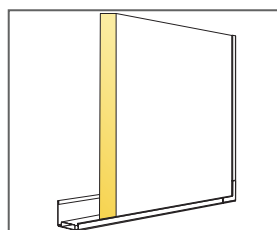
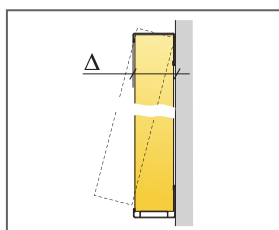

Detail of panel with Thinline frame

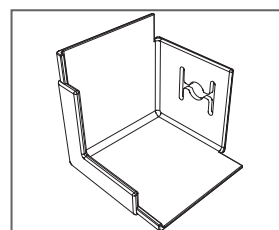

Detail of Thinline corner

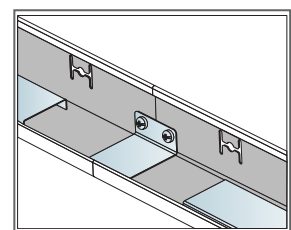

Detail of Thinline splice

## INSTALLATION DIAGRAM (M354) FOR ECOPHON AKUSTO WALL C VERTICAL INSTALLATION

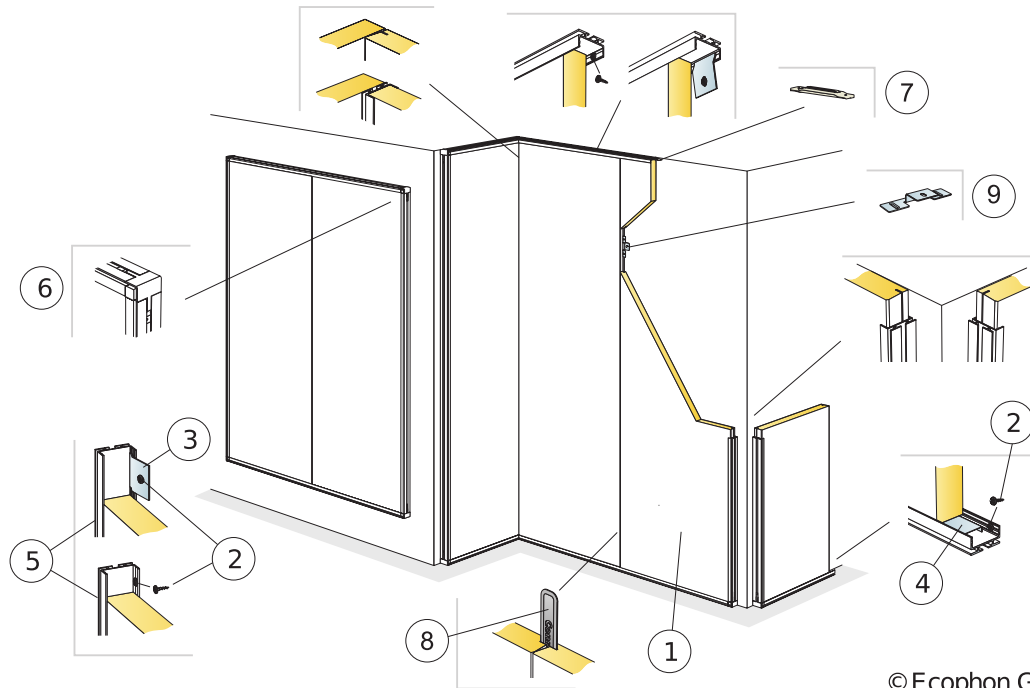

© Ecophon Group

### QUANTITY SPECIFICATION (EXCL. WASTAGE)

		Size, mm
		<b>2700x600</b>
1	Akusto Wall C	0,62/m <sup>2</sup>
2	Connect Installation screw MVL (for use in plasterboard or timber)	as required
3	Alt. Connect Fixing bracket, fixed at 400 mm centres.	as required
4	Connect WP Space bar, L=2400 mm	as required
5	Connect WP Profile, L=2687 mm, fixed at 400 mm centres	as required
6	Connect WP External corner mounted in Connect WP Profile	as required
7	Connect WP Profile splice, used to extend WP profiles where needed.	as required
8	Connect Spline	as required
9	Connect Fixing plate is mounted at 500 mm centres	as required
Δ Min. overall depth of system: 44 mm		-

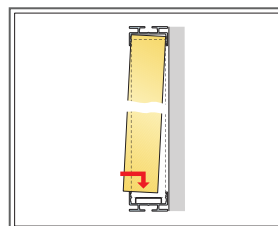
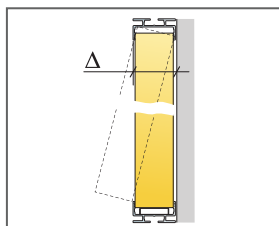

Detail of installation

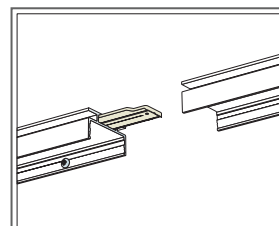

Detail of WP Profile splice

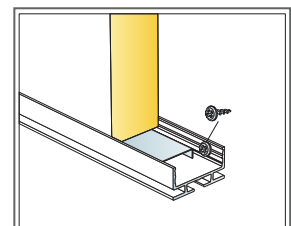

Detail of lower connection

## INSTALLATION DIAGRAM (M355) FOR ECOPHON AKUSTO WALL C HORIZONTAL INSTALLATION

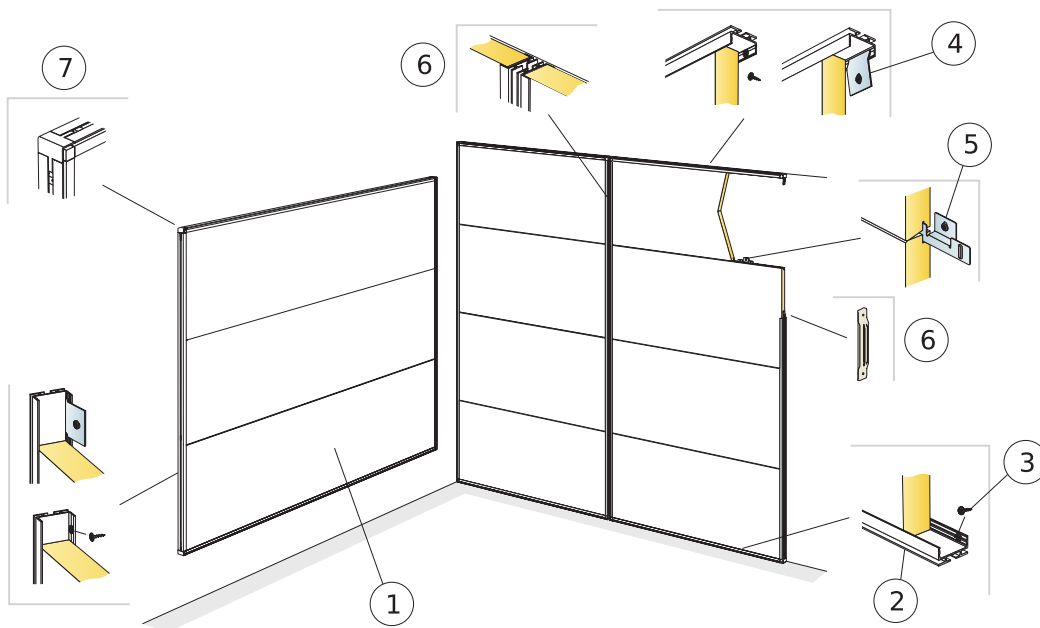

© Ecophon Group

### QUANTITY SPECIFICATION (EXCL. WASTAGE)

		Size, mm
		<b>2700x600</b>
1	Akusto Wall C	0,62/m <sup>2</sup>
2	Connect WP Profile, L=2687 mm, fixed at 400 mm centres	as required
3	Connect Installation screw MVL (for use in plasterboard or timber)	as required
4	Alt. Connect Fixing bracket, fixed at 400 mm centres.	as required
5	Connect Fixing plate is mounted at 500 mm centres	as required
6	Connect WP Profile splice, used to extend WP profiles where needed.	as required
7	Connect WP External corner mounted in Connect WP Profile	as required
Δ Min. overall depth of system: 44 mm		-

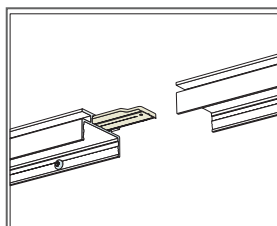
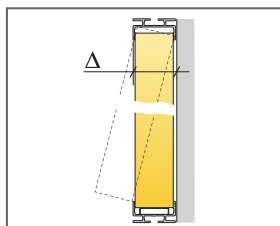

Detail of WP Profile splice

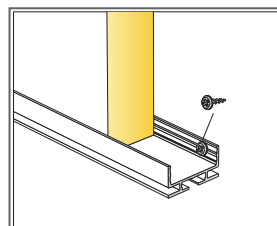

Detail of lower connection

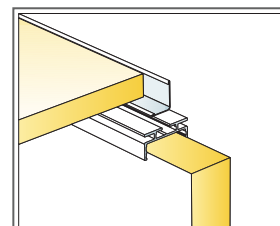

Detail of junction to acoustic ceiling

## INSTALLATION DIAGRAM (M508) FOR ECOPHON AKUSTO WALL C HORIZONTAL INSTALLATION

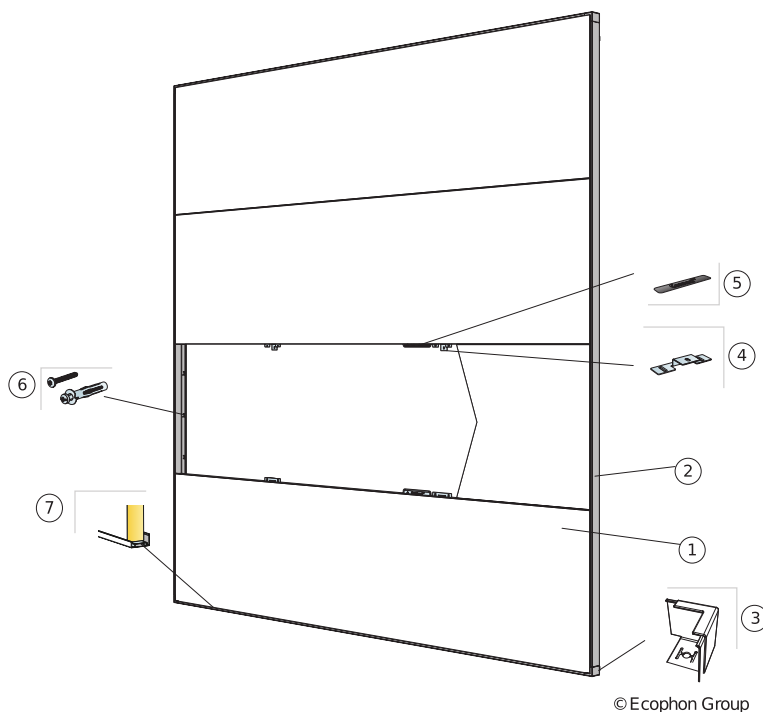

### QUANTITY SPECIFICATION (EXCL. WASTAGE)

	<b>Size, mm</b>
	<b>2700x600</b>
1 Akusto Wall C	0,62/m <sup>2</sup>
2 Connect Thinline Profile, L=2644 mm	as required
3 Connect Thinline Corner	as required
4 Connect Fixing plate is mounted at 500 mm centres	as required
5 Connect Spline	as required
6 Installation screw, installed at 400 mm centres (select fastener according to wall material)	as required
7 Connect Thinline Space Bar	as required
Δ Overall depth of system: 45 mm	-

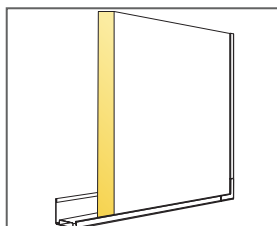
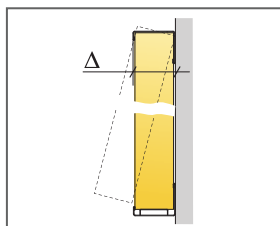

Detail of panel with Thinline frame

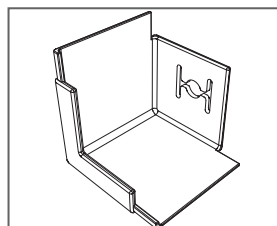

Detail of Thinline corner

# Ecophon Akusto™ One

Ecophon Akusto™ One is a panel for wall applications offered in square, rectangle or circle shapes. It offers a multitude of design possibilities thanks to the many different formats and colours.



Heisingborg, Sweden

## SYSTEM RANGE

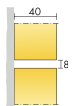

Size, mm	592x	592x592	792x	1192x	1192x292	1192x592
Special	•	•	•	•	•	•
Thickness	40	40	40	40	40	40
Inst. Diag.	M372	M371	M372	M372	M371	M371

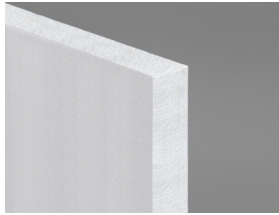

Akusto One panel

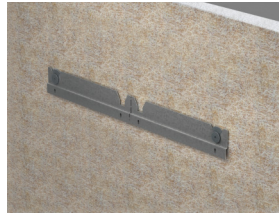

Installation with Connect™ One trim and Connect™ Absorber Anchor One

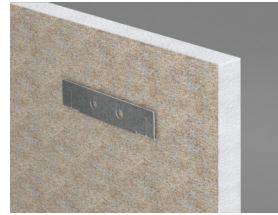

Installation with Connect™ One hook fixing



## Acoustic

The values in the diagram refer to a single unit. If the units are arranged in a cluster with distances between units less than 0,5 metres, the Aeq per unit will be slightly reduced.

### Sound Absorption:

Test results according to EN ISO 354.

A<sub>eq</sub>: Equivalent absorption area per unit (m<sup>2</sup> sabin)

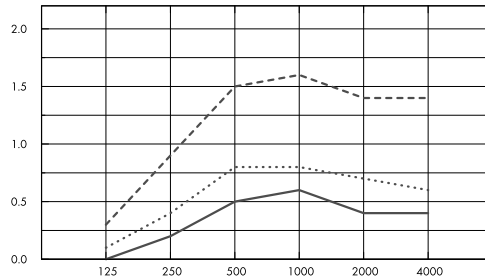

- Akusto One Ø592, 48 mm o.d.s.
- Akusto One Ø792, 48 mm o.d.s.
- Akusto One Ø1192, 48 mm o.d.s.

Frequency Hz

A<sub>eq</sub>: Equivalent absorption area per unit (m<sup>2</sup> sabin)

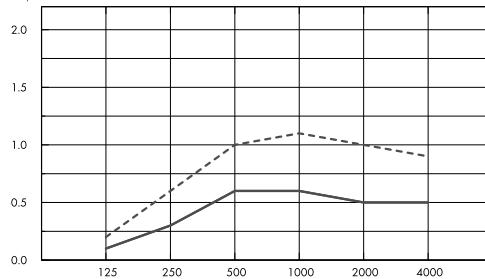

- Akusto One 592x592, 48 mm o.d.s.
- Akusto One 1192x292, 48 mm o.d.s.
- Akusto One 1192x592, 48 mm o.d.s.

Frequency Hz

	THK mm	o.d.s. mm	A <sub>eq</sub> : Equivalent absorption area per unit (m <sup>2</sup> sabin)					
			125 Hz	250 Hz	500 Hz	1000 Hz	2000 Hz	4000 Hz
Ø592	40	48	0.0	0.2	0.5	0.6	0.4	0.4
Ø792	40	48	0.1	0.4	0.8	0.8	0.7	0.6
Ø1192	40	48	0.3	0.9	1.5	1.6	1.4	1.4
592x592	40	48	0.1	0.3	0.6	0.6	0.5	0.5
1192x292	40	48	0.1	0.3	0.6	0.6	0.5	0.5
1192x592	40	48	0.2	0.6	1.0	1.1	1.0	0.9



## Indoor Air Quality

Certificate / Label

Eurofins Indoor Air Comfort®

IAC

French VOC

A

Finnish M1

•







## Circularity

Minimum post-consumer recycled content	61%
Recyclability	Fully recyclable



## Fire safety

Country	Standard	Class
Europe	EN 13501-1	A2-s1,d0

The glass wool core of the tiles is tested and classified as non-combustible according to EN ISO 1182.



## Humidity Resistance

Class C, relative humidity 95% and 30°C, according to EN 13964:2014



## Visual appearance

Akusto Wall in white has high light reflectance. Light reflectance and nearest NCS colour sample for all the different colours: See Ecophon Colours and surfaces.



## Cleanability

Daily dusting, vacuum cleaning and weekly wet wiping (Akutex FT surface). Weekly dusting and vacuum cleaning (Texona) as required.



## Accessibility

The tiles are easily demountable.



## Installation

Installed according to installation diagrams, installation guides and drawing aid. For information regarding minimum overall depth of system see quantity specification.



## System weight

The weight of the system (depending on size and including profile system) should be approximately 2,0 - 4,5 kg.



## Mechanical properties

No additional live load is allowed.



## CE

Ecophon ceiling systems are CE marked according to the European harmonized standard EN 13964:2014. CE marked construction products are covered by a Declaration of Performance (DOP) which enables customers and users to easily compare performance of products available on the European market.

## INSTALLATION DIAGRAM (M371) FOR ECOPHON AKUSTO ONE

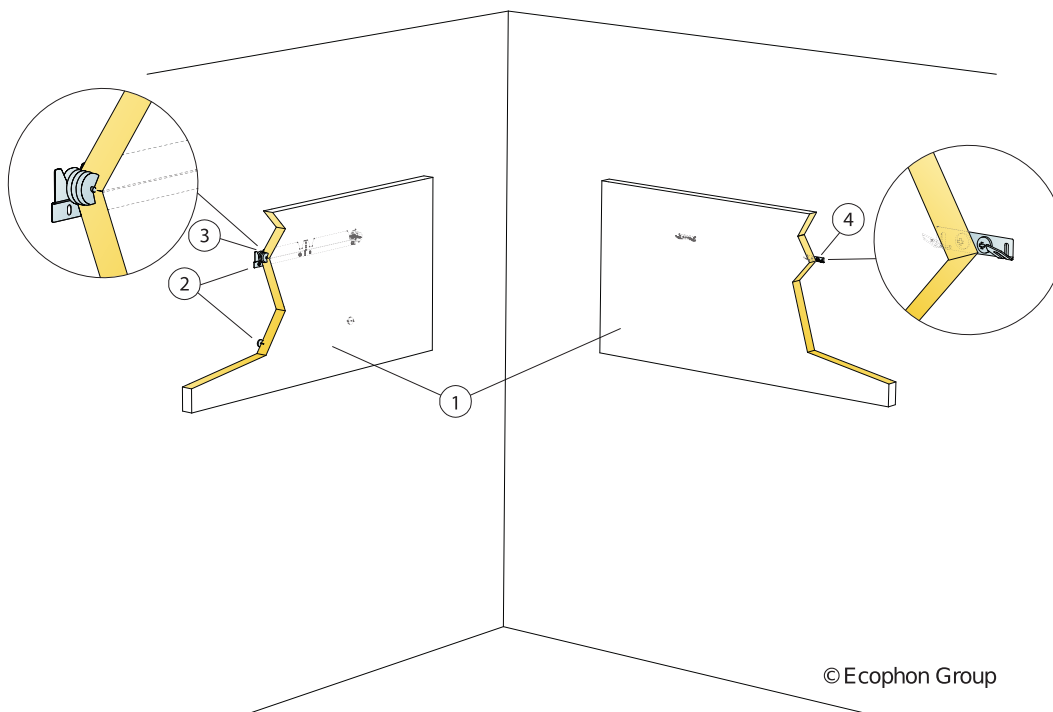

© Ecophon Group

### QUANTITY SPECIFICATION (EXCL. WASTAGE)

	Size, mm		
	592x592	1192x292	1192x592
1 Akusto One	2,8/m <sup>2</sup>	2,8/m <sup>2</sup>	1,4/m <sup>2</sup>
2 Alt. 1 Connect One trim (wall distance included)	1/panel	1/panel	1/panel
3 Alt. 1 Connect Absorber Anchor One	2/panel	2/panel	2/panel
4 Alt. 2 Connect One hook fixing	2/panel	2/panel	2/panel
Δ Min. overall depth of system: Δ1 48 mm / Δ2 44 mm	-	-	-

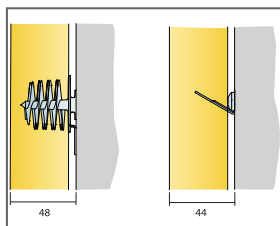

See Quantity specification

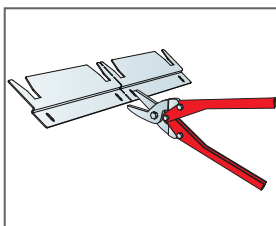

Connect One trim can be divided into two suspension trims

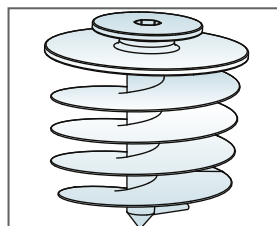

Connect Absorber Anchor One used together with Connect One trim

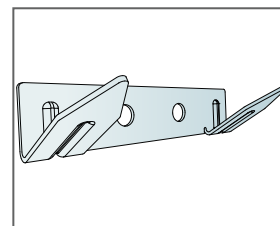

Connect One hook fixing

INSTALLATION DIAGRAM (M372) FOR ECOPHON AKUSTO ONE

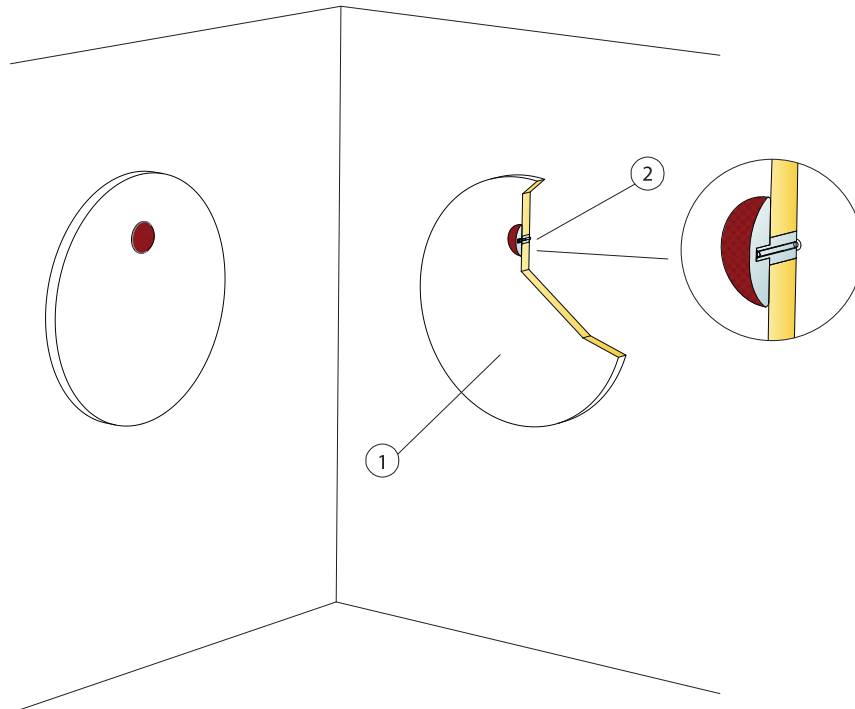

QUANTITY SPECIFICATION (EXCL. WASTAGE)

		Size, mm		
		592x	792x	1192x
1	Akusto One	3,5/m <sup>2</sup>	2/m <sup>2</sup>	0,9/m <sup>2</sup>
2	Connect One fixing	1/panel	1/panel	1/panel
Δ Min. overall depth of system: 40 mm		-	-	-

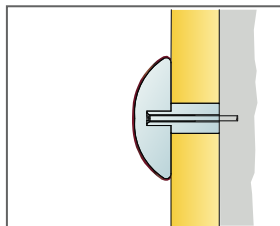

See Quantity specification

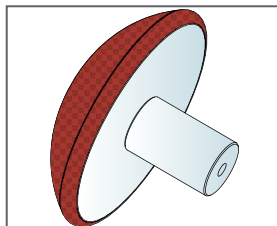

Connect One fixing available in 4 different colours

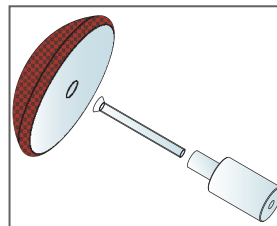

Installation with Connect One fixing



# Ecophon Akusto™ Wall C Akutex HS

*Ecophon Akusto™ Wall C Akutex HS has a concealed grid and bevelled edge to create a narrow groove between each panel. Suitable for swimming pool areas, it's compatible with high humidity, corrosivity and occasional direct water.*



## SYSTEM RANGE

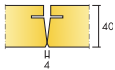

Size, mm	2700x600
Thinline	•
Thickness	40
Inst. Diag.	M505C4

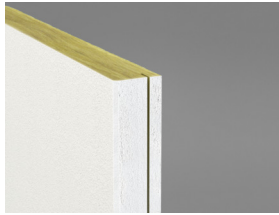

Akusto Wall C Akutex HS



Section of Akusto Wall C Akutex HS System



Akusto Wall Akutex HS system with Connect Thinline Profile and distance



## Acoustic

### Sound Absorption:

Test results according to EN ISO 354. Classification according to EN ISO 11654.

$\alpha_p$ , Practical sound absorption coefficient

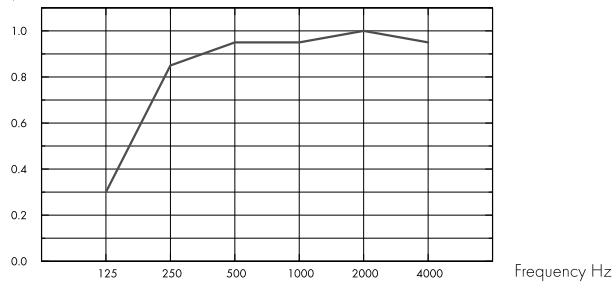

– Akusto Wall C Akutex HS 40 mm, 60 mm o.d.s.

THK mm	o.d.s. mm	$\alpha_p$ , Practical sound absorption coefficient						$\alpha_w$	Sound absorption class
		125 Hz	250 Hz	500 Hz	1000 Hz	2000 Hz	4000 Hz		
40	60	0.30	0.85	0.95	0.95	1.00	0.95	1.00	A



## Indoor Air Quality

Certificate / Label

Eurofins Indoor Air Comfort®

IAC

French VOC

A

Finnish M1

•



## Circularity

Minimum post-consumer recycled content

60%

Recyclability

Fully recyclable



## Fire safety

Country

Europe

Standard

EN 13501-1

Class

A2-s1,d0

The glass wool core of the tiles is tested and classified as non-combustible according to EN ISO 1182.



## Humidity Resistance

Class C, relative humidity 95% and 30°C, according to EN 13964:2014



## Visual appearance

White 500, nearest NCS colour sample S 0500-N, 84% light reflectance.



### Cleanability

---

Daily dusting and vacuum cleaning. Weekly wet wiping.



### Accessibility

---

The tiles are not demountable except in selected installation diagrams. See quantity specification for more information.



### Installation

---

Installed according to installation diagrams, installation guides and drawing aid. For information regarding minimum overall depth of system see quantity specification. The systems should not be placed behind goals or similar areas where they are likely to be hit regularly. In such cases a protective net in front of the system is recommended.



### Mechanical properties

---

See table about Max live load and Min load bearing capacity and Functional demands, Mechanical properties at [www.ecophon.com](http://www.ecophon.com).



### CE

---

Ecophon ceiling systems are CE marked according to the European harmonized standard EN13964:2014. CE marked construction products are covered by a Declaration of Performance (DOP) which enables customers and users to easily compare performance of products available on the European market.

## INSTALLATION DIAGRAM (M505C4) FOR ECOPHON AKUSTO™ WALL C AKUTEX HS VERTICAL INSTALLATION WITH CONNECT THINLINE PROFILE AND DISTANCE.

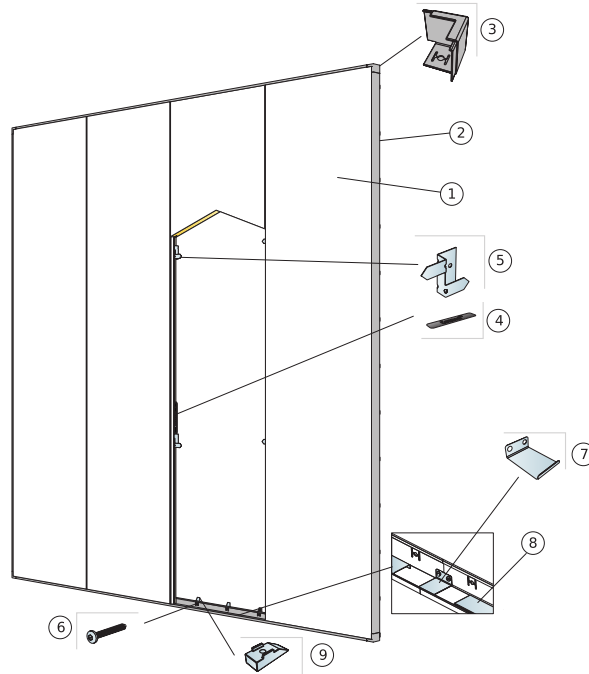

© Ecophon Group

### QUANTITY SPECIFICATION [EXCL. WASTAGE]

	<b>Size, mm</b>
	<b>2700x600</b>
1 Akusto Wall C Akutex HS	0,62/m <sup>2</sup>
2 Connect Thinline Profile, L=2644 mm	as required
3 Connect Thinline Corner	as required
4 Connect Spline	as required
5 Connect Thinline Fixing C4, for panel support every 1000 mm	as required
6 Installation screw C4, installed at 200 mm centres (select fastener according to wall material)	as required
7 Connect Thinline Splice, used to extend Thinline profiles where needed.	as required
8 Connect Thinline Space Bar	as required
9 Connect Distance C4, installed at 200 mm centres	as required
Δ Overall depth of system: 55 mm	-

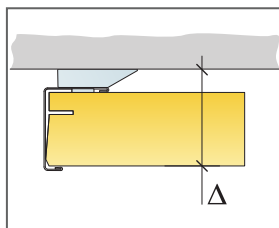

See Quantity Specification

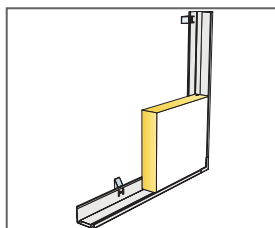

Detail of panel with Thinline system with distance

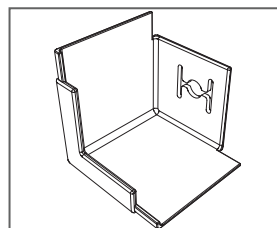

Detail of Thinline corner

# Ecophon Akusto™ Screen

*Ecophon Akusto™ Screen has an exposed profile system. The size of the product is 1500 x 1200mm, thickness 40 mm. Available in Texona and Caretec surface. Suitable for open space offices. Combined with a sound absorbing ceiling to achieve excellent acoustic properties in the room.*



## SYSTEM RANGE

	Size, mm	1500x1200
	FreeStanding	•
	Thickness	40
	Inst. Diagr.	M526



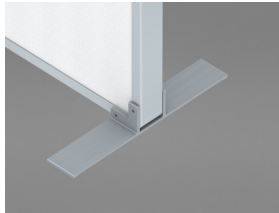

Akusto Floor foot



Akusto Floor corner

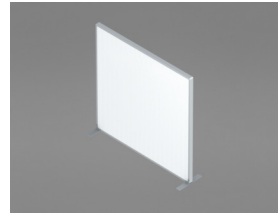

Akusto Screen system



## Acoustic

### Sound Absorption:

>Sound absorption test results according to EN ISO 354. Sound attenuation test results according to ISO 10053.

$A_{eq}$ , Equivalent absorption area per unit ( $m^2$  sabin)

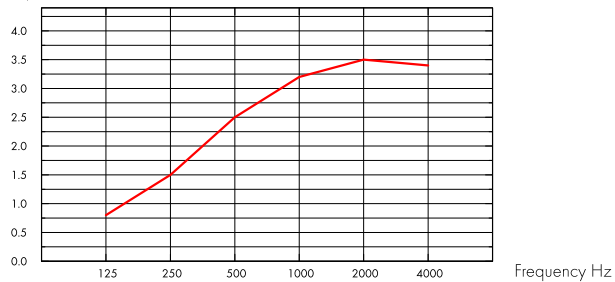

— Akusto Screen, size 1500x1200 mm

Screen sound attenuation (dB)

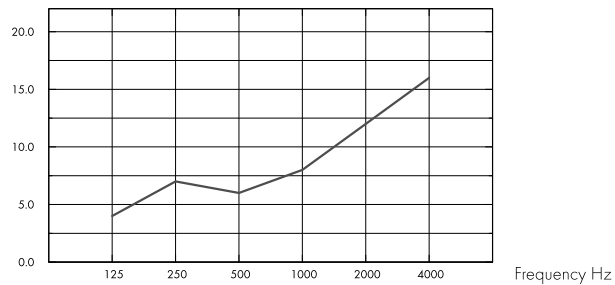

— Akusto Screen, size 1500x1200 mm

THK mm	$A_{eq}$ , Equivalent absorption area per unit ( $m^2$ sabin)					
	125 Hz	250 Hz	500 Hz	1000 Hz	2000 Hz	4000 Hz
40	0.8	1.5	2.5	3.2	3.5	3.4

THK mm	Screen sound attenuation (dB)						Insertion loss (dB)
	125 Hz	250 Hz	500 Hz	1000 Hz	2000 Hz	4000 Hz	
40	4.0	7.0	6.0	8.0	12.0	16.0	10.0



## Indoor Air Quality

Certificate / Label

French VOC, A



## Circularity

Fully recyclable.



### Visual appearance

---

Texona in white and Caretec has high light reflectance. For more information regarding visual appearance of the various surfaces: See Ecophon Colours and surfaces.



### Cleanability

---

Weekly dusting and vacuum cleaning. The Caretec surface also withstands weekly wet wiping.



### Use of disinfectants

---

The Caretec surface and Texona Ginger, Sea salt, Thyme, Oyster and Garlic withstand the frequent use of ethanol (70%)-based disinfectants. Additionally, Caretec withstands Klorilli (chloramine 0,1 %). Dampen a soft polyester microfiber cloth with the solution and wipe the surface in gentle circular movements.



### Installation

---

Installed according to the installation guide that is delivered with the product.



### Mechanical properties

---

The product is tested according to EN14073-2 and EN1023.

## INSTALLATION DIAGRAM (M515) FOR ECOPHON AKUSTO SCREEN

---

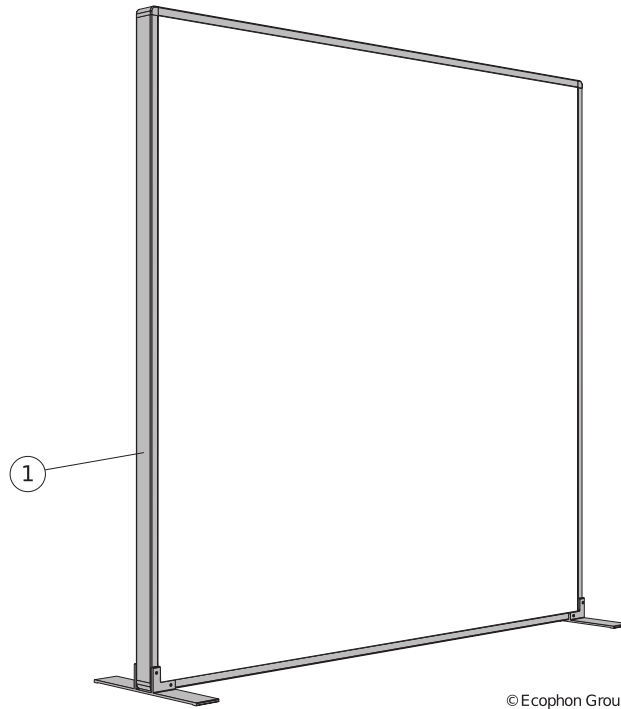

QUANTITY SPECIFICATION (EXCL. WASTAGE)

---

**Size, mm**

**1500x1200**

---

1

Akusto Screen

---