

**MATERIAL CHARACTERISTICS**

<b>FIBERGLASS COMPOSITE</b>	glass-fibre-reinforced polyester, mineral fillers, additives
<b>TENSILE STRENGTH</b>	65 N/mm <sup>2</sup> (ISO 527)
<b>BENDING STRENGTH</b>	120 N/mm <sup>2</sup> (ISO 14125)
<b>ELASTICITY MODULE</b>	10,000 N/mm <sup>2</sup> (ISO 14125)
<b>DENSITY</b>	2.0 g/cm <sup>3</sup> (ISO 1172)
<b>COEFFICIENT OF LINEAR EXPANSION</b>	1.5 - 2.0 x 10 <sup>-5</sup> 1/K
<b>HEAT RESISTANCE</b>	100°C continuous load, up to 240°C with a load duration up to 110 min.
<b>FROST RESISTANCE</b>	-35°C
<b>WATER PENETRATION LEVEL</b>	0 mm
<b>WATER ABSORPTION</b>	0,078 % (EN ISO 62:2008-05 Procedure 1)
<b>MATERIAL STRUCTURE</b>	Capillary free

**PURPOSE OF USE**

Component for the line drainage of surfaces in order to collect, transport and discharge rainwater from adjacent fixed surfaces.

\*\* ) Not suitable for the diagonal or transverse travel of motorways and highways.

# MEARIN EXPERT 1500

A 15, B 125, C 250, D 400\*\*, E 600\*\*

nominal width 150

## MEARIN EXPERT 1500 DRAINAGE CHANNEL WITHOUT FALL WITH INTEGRATED EDGE MADE OF GALVANISED STEEL (V) OR STAINLESS STEEL (E) AND SEALING JOINT ACCORDING TO EN 1433

Channels made of glass-fibre-reinforced composite. Clear width 150 mm, total width 182 mm. Suitable for all channel covers **MEA 150 CLIPFIX** and **MEA TSH 150 TOPSLOT**. For the realisation of water level slopes. Loading classes A 15 to E 600\*\* according to EN 1433. Load capacity according to specification when installed according to the MEA installation instructions.

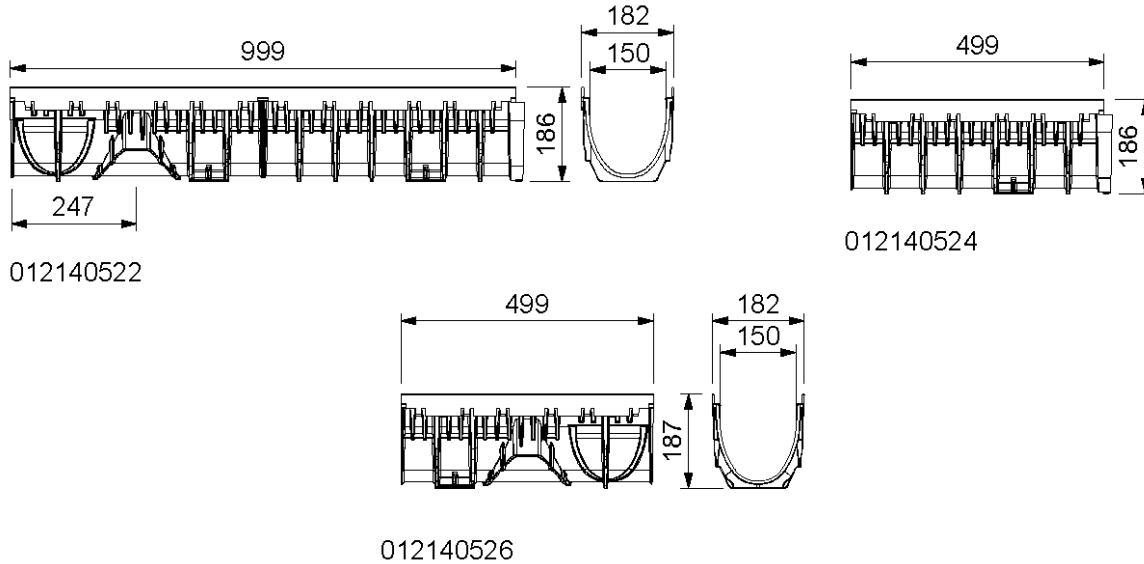

### MEARIN EXPERT V 1500 DRAINAGE CHANNEL BODY WITHOUT FALL, LOADING CLASSES TO E 600 \*\*)

Designation	Ord. No.	Length [mm]	Height [mm]	kg/unit
MEARIN EXPERT V 1500.0 Drainage channel body 5) 14) **)	012140522	1000	187	6,40
MEARIN EXPERT V 1500.1 Drainage channel body 3) **)	012140524	500	187	3,25
MEARIN EXPERT V 1500.1 RW Drainage channel body for change of drain direction 5) 14) 15) **)	012140526	500	187	3,25

### MEARIN EXPERT E 1500 DRAINAGE CHANNEL BODY WITHOUT FALL, LOADING CLASSES TO E 600 \*\*)

Designation	Ord. No.	Length [mm]	Height [mm]	kg/unit
MEARIN EXPERT E 1500.0 Drainage channel body 5) 14) **)	012140912	1000	187	6,40
MEARIN EXPERT E 1500.1 Drainage channel body 3) **)	012140914	500	187	3,25
MEARIN EXPERT E 1500.1 RW Drainage channel body for change of drain direction 5) 14) 15) **)	012140916	500	187	3,25

\*\* ) Not suitable for the diagonal or transverse travel of motorways and highways.  
 3) Connection option for end caps with connector or for gullies / silt boxes.  
 5) Connection option for vertical drain Ø 160 mm (drainage preformation), end caps with connector or to gullies / silt boxes.  
 14) Connection option for corner-, t- and cross- connections.  
 15) Utilization option as a flow direction change.

# MEARIN EXPERT 1500

A 15, B 125, C 250, D 400\*\*, E 600\*\*

nominal width 150

## MEARIN EXPERT 1500 ACCESSORIES

### MEARIN EXPERT V 1500 SILT BOX WITHOUT COVER, WITH SEDIMENT BUCKET \*\*)

Designation	Ord. No.	Length [mm]	Height [mm]	kg/unit
MEARIN EXPERT V 1500.EK silt box with pipe connector Ø 160 mm, incl. sediment bucket **)	012145110	500	694	7,80

### MEARIN EXPERT E 1500 SILT BOX WITHOUT COVER, WITH SEDIMENT BUCKET \*\*)

Designation	Ord. No.	Length [mm]	Height [mm]	kg/unit
MEARIN EXPERT E 1500.EK silt box with pipe connector Ø 160 mm, incl. sediment bucket **)	012140918	500	694	7,80

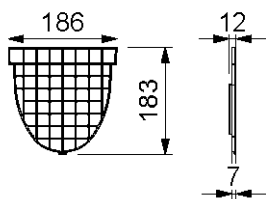

010140541

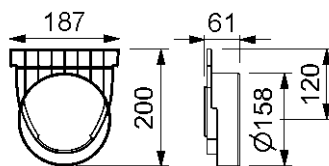

010140543

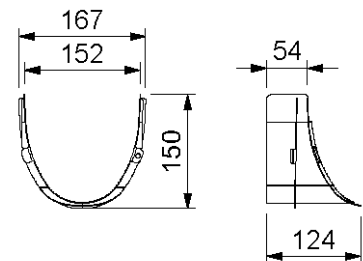

010140544

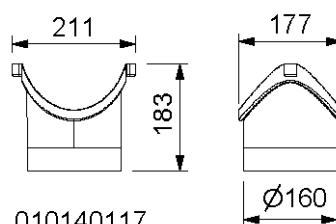

010140117

### MEARIN EXPERT 1500 CONNECTION ACCESSORIES AND END CAPS

Designation	Ord. No.	Material	Height [mm]	kg/unit
MEARIN PLUS/EXPERT 1500.SE End cap closed for channel start/end	010140541	PC	183	0,10
MEARIN PLUS/EXPERT 1500.E End cap with outlet Ø 160 mm for channel end	010140543	PC	200	0,14
MEARIN PLUS/EXPERT 1500 Adapter for lateral gutter connection, for corner, T- and cross connections	010140544	Galv. steel	150	0,60
MEARIN PLUS/EXPERT 1500 - 2000 Vertical outlet connection Ø 160 mm	010140117	PP	182	0,14

\*\*) Not suitable for the diagonal or transverse travel of motorways and highways.

**JOINTING COMPOUNDS FOR STANDARD APPLICATIONS \*\*\*)**

Designation	Ord. No.	Material	kg/unit
SABA MS Floor GREY sealant 600 ml in a bag, stable ***)	010152708	MS-polymer-basis	0,88
SABA Primer 9102 forundercoat, 1 liter	010155803	Silane-basis	0,92
Joint Cleaner solvent 48, 1 liter, Cleaner for adhesive flanks	010155807	-	0,84
Dispensing gun for 600 ml bags	010152707	-	0,79

\*\* ) Not suitable for the diagonal or transverse travel of motorways and highways.

\*\*\* ) For watertight mounting of drainage channels (only for channels transporting rainwater). Not suitable for installation in LAU-facilities, gaz stations or similar constructions

This edition of the technical data sheet shall be valid from February 2023 until a revised version is published and replaces any previous publications. The respectively current version is available for download at [www.mea-group.com](http://www.mea-group.com).

MEA Bautechnik GmbH  
 Business unit MEA Water Management  
 Sudetenstraße 1  
 86551 Aichach  
 Tel.: +49 (0) 82 51. 91 0  
 Fax: +49 (0) 82 51. 91 13 06  
 E-Mail: [info@mea-group.com](mailto:info@mea-group.com)  
[www.mea-group.com](http://www.mea-group.com)