

## Substructure Waterproofing - Ancillaries

### Grace Protection 03

Bituminous board for permanent protection of Grace waterproof membrane.

#### Description

Robust bitumen protection boards for protecting Grace waterproof membranes from damage during construction activity.

#### Installation

##### Vertical Installation

1. Start at bottom of wall and apply to height of first backfill layer.
2. Wherever possible backfill and compact in layers to minimise risk of displacement of boards.
3. To locate boards, prime five 150 mm x 150 mm 'patches' (one in each corner, and one in the middle) of each board with B2 Primer and allow to dry. Apply Bitustik™ 4000 150 mm double sided bitumen tape to the primed strips.
4. Apply boards to clean dry membrane and roll 'patches' firmly. Remove release film from 'patches' and apply boards to membrane.
5. Apply B2 Primer to 75 mm edge of all boards. When dry tape all butt joints between boards with cut strips of membrane. Roll well to achieve full adhesion.
6. In cold weather it may be necessary to soften the cut membrane strips by slightly heating.
7. Provide temporary propping of protection boards where necessary and remove as backfill is placed.

#### Horizontal Protection

Repeat the installation instructions for horizontal protection of membranes.

In high wind conditions provide temporary ballast to the protection boards.

#### Limitations

Suitable for use with graded backfill materials.

Maximum exposure of protection boards 30 days.

#### NBS Specification Clause

Refer to Clause J40 380.

#### Health and Safety

There is no requirement for a Material Safety Data Sheet for Protection Boards or tapes.

For Primer B2 read the product label and Material Safety Data Sheet (MSDS) before use. Users must comply with all risk and safety phrases. MSDSs can be obtained from Grace Construction Products.

#### Advantages

- Recommended for use with Bituthene® and backfilled Preprufe® membranes.
- Rot resistant.
- Provides protection against damage from backfill and site operations.
- Can be folded through 90°.
- Lightweight.
- Easy to install.

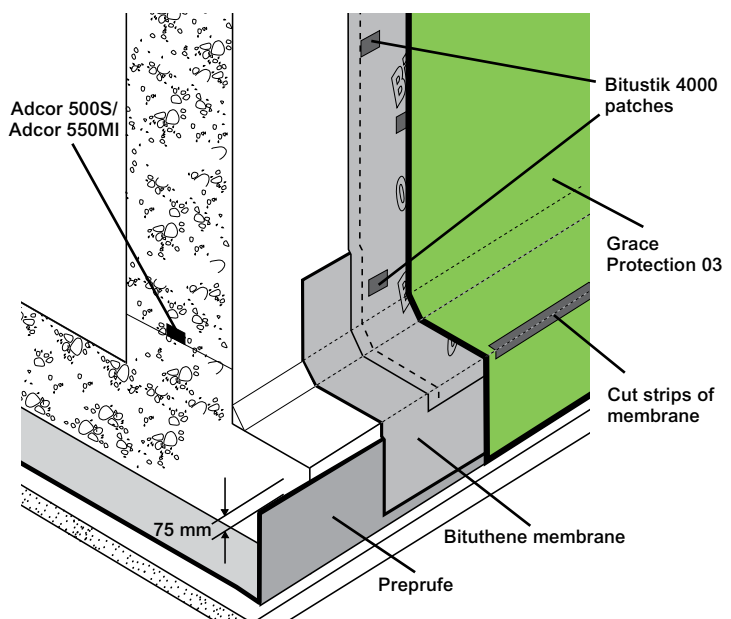

Details shown are typical illustrations only and not working drawings. For assistance with working drawings and additional technical advice please contact Grace Technical Services

## Supply

### Grace Protection 03

Length	2.03 m $\pm$ 6%
Width	0.90 m $\pm$ 6%
Thickness	3.0 mm $\pm$ 6%
Nominal Weight	5 kg/board (300 boards per pallet)

### Ancillary Products

Bitustik™ 4000	150 mm x 12 m rolls (6 rolls per carton)
Primer B2	5 and 25 litre drums
Coverage	10 sq m per litre (depending upon method of application, surface porosity and ambient temperature)

[www.graceconstruction.com](http://www.graceconstruction.com)

Grace Construction Products Limited Ipswich Road Slough Berkshire SL1 4EQ United Kingdom  
Tel +44 (0)1753 490000 Fax +44 (0)1753 490001

Adcor, Bituthene and Preprufe are registered trademarks of W R Grace & Co.-Conn. Bitustik is a trademark of W R Grace & Co.-Conn.

The information given is based on data and knowledge considered by GRACE to be true and accurate and is offered for the user's consideration, investigation and verification only. Since the conditions of use are beyond our control we do not warrant the results to be obtained. None of these statements, recommendations or suggestions shall constitute a warranty, guarantee, representation or statement of similar legal nature. No statement, recommendation or suggestion is intended for any use which would violate or infringe statutory obligations or any rights belonging to a third party. This data sheet should be checked against the latest version available from the local GRACE Representative or the GRACE website. The information contained in the latest data sheet supersedes all previously published editions. Visits to site by GRACE personnel do not constitute supervisory responsibility.

These products may be covered by patents or patents pending.

Copyright 2011. Grace Construction Products Ltd GRAPROT/UK/001a/SM Printed in UK 02/11

GRACE