

Grace Protection Boards - Decks

A range of protection boards to prevent damage to waterproofing membranes that have been applied to concrete decks.

Description

Horizontally applied waterproofing membranes can be damaged by site traffic and during installation of deck finishes. To protect membranes, Grace have developed a range of protection boards, designed for a variety of deck finishes.

Advantages

- Provides protection against damage from installation of deck finishes.
- Lightweight and easy to lay.
- Can be applied to waterproofing membranes as soon as they can be trafficked.
- Used with bituminous tapes to protect all joints.

Concrete Deck Waterproofing Membranes

The protection boards included in this product data sheet form part of the following Grace concrete deck waterproof membrane systems:

- Procor® Deck System 2
- Procor® Deck System 4R
- Servidek®/Servipak®
- Servirufe® Traffic Deck

For information on these waterproof membrane systems please refer to the respective product data sheet.

Concrete Deck Waterproofing - Protection Board Selection Chart

Deck Finishes	Recommended Protection Board	Thickness (mm)	Recommended Tape for Joints in Protection Boards	Tape Width (mm)
Pavoids/paving slabs	Grace Protection Board/Roll	2	Bitutape™ 4000	70
Soft landscaping	Grace Protection Board/Roll	2	Bitutape™ 4000	70
Timber decking	Grace Protection Board TD	1.5	Bitutape™ 4000	70
Hot asphalt	Servipak® 3 or 6	3 or 6	Armourtape™	100

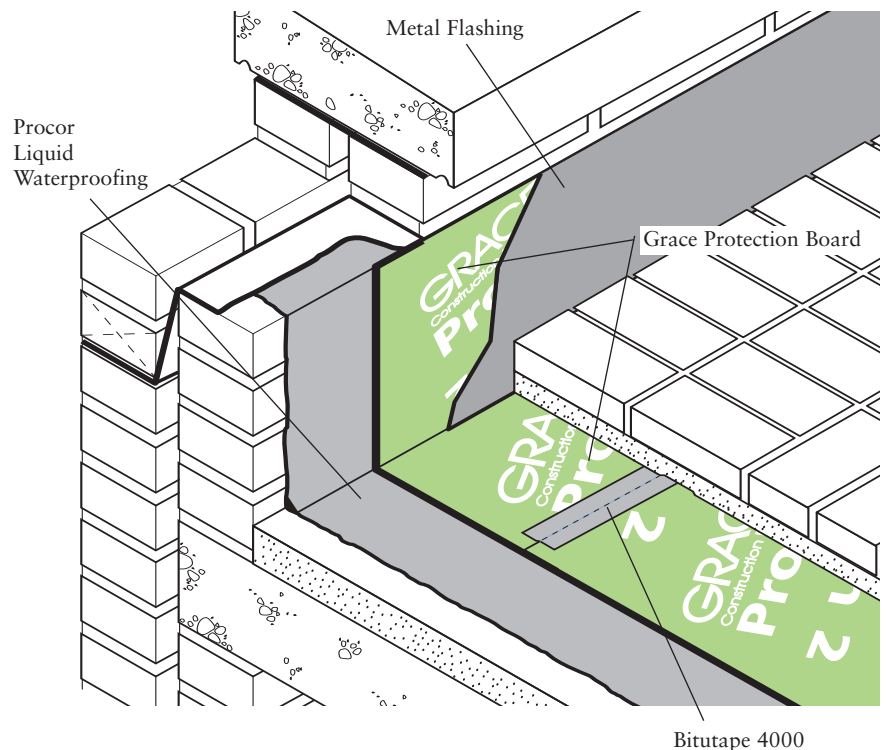

Supply

Grace Protection Roll/Board	1 m x 20 m rolls x 2 mm 16 rolls/pallet 1 m x 2 m Boards 225 Boards/pallet
Servipak® 3	1 m x 2 m x 3 mm 130 boards/pallet
Servipak® 6	1 m x 1 m x 6 mm 50 boards/pallet
Grace Protection Board TD 1.5	1 m x 2 m x 1.5mm 256 boards/pallet
Ancillaries Bitutape™ 4000	70 mm x 20 m roll 8 rolls/carton
Armourtape™	75 mm x 10 m roll 16 rolls/carton
Bitustik™ 4000	150 mm x 12 m rolls
Primer B2	5 Lit + 25 Lit cans

Limitations

Maximum exposure of protection boards before installation of finishes: 30 days.

Protection boards should always be fully loaded by screeds, hard and soft landscaping etc. (not applicable to Procor Protection Board TD 1.5).

Protection boards are designed to provide protection against damage during installation of finishes only. If protection boards are to be regularly trafficked by site vehicles, use additional protection measures.

Application

Grace recommend that concrete deck waterproofing and protection is only carried out by trained waterproofing applicators.

For details of trained applicators please contact Grace.

Installation

Grace Protection Roll 2

1. Measure length required and cut to length from roll.
2. Apply vertically with asphaltic paper facing the waterproofing.
3. Use Bitutape™ 4000 strips to adhere boards to membrane where necessary.
4. All edge laps should be overlapped 50 mm, primed and taped with Bitutape 4000. Roll well to achieve full adhesion.
5. In high wind conditions provide temporary ballast until deck finishes are installed.
6. If unbonded protection is required (recommended on pedestrianised decks) apply the sheet with polythene film facing the waterproofing.
7. If bonded protection is required (recommended on trafficked decks) apply the sheet with the asphaltic paper facing the waterproofing.
8. Remove the polythene film at all board laps to enable Bitutape 4000 to be bonded to the bituminous compound.

Servipak 3 or 6

1. Use Servitape™ 4000 to adhere boards where necessary

2. All joints should be butt jointed and primed with Primer B2 applied lightly by roller. Allow primer to dry then tape with Armourtape and roll well to achieve full adhesion.
3. Where detailing work is required, score the board surface with a knife and fold through 90°.

Procor Protection Board TD 1.5

1. Use Servitape strips to locate boards where necessary
2. All laps should be butt jointed and taped with Bitutape™ 4000, roll well to achieve full adhesion.
3. In high wind conditions provide temporary ballast until deck finishes are installed.
4. When timber battens from the decking system are laid onto the boards allow a staggered layout or cut notches in battens to allow for water run off.
5. If additional protection beneath the timber decking is required, use an aggregate layer between the timber battens.

Performance

All protection boards listed in this product data sheet show no puncture under the chisel impact test detailed in The Highways Agency Bridge Deck Waterproofing Specification BD 47.

Health And Safety

There is no requirement for a Material Safety Data Sheet for Protection Boards. For health and safety questions on these products please contact Grace Construction Products Limited.

 Visit our web site at www.graceconstruction.com

Grace Construction Products Ltd, Ajax Avenue, Slough, Berkshire SL1 4BH United Kingdom Tel +44 (0)1753 692929 Fax +44 (0)1753 691623

Adcor, Aerofil, BETEC, Bituthene, Hydproduct, Insupak, Korkpak, Paraflex, Paraseal, Preprufe, Procor, Servised, Servidek, Servigard, Servijoint, Servimastic, Servipak, Servirufe, Serviseal, Servistrip, Servitite, Vertigard and Vertiseal are registered trademarks of W R Grace & Co.-Conn.
Adprufe, Armourtape, Bitushield, Bitustik, Bitutape, Hydropaste, Pak Adhesive, PVC Edgetie, Serviband, Serviflex, Servitape, Slipstrip, and Solarshield are trademarks of W R Grace & Co.-Conn.

The information given is based on data and knowledge considered to be true and accurate and is offered for the user's consideration, investigation and verification. Since the conditions of use are beyond our control we do not warrant the results to be obtained. Please read all statements, recommendations or suggestions in conjunction with our conditions of sale including those limiting warranties and remedies which apply to all goods supplied by us. No statement, recommendation or suggestion is intended for any use which would violate or infringe statutory obligations or any rights belonging to a third party.

Copyright 2006. Grace Construction Products Limited.

Printed in England - 05.06- Ref. WM017D

GRACE
Construction Products