

CELLECTA **HEXATHERM® XPERi** insulation installed externally against basement wall
 CELLECTA **HEXATHERM® XFLOOR** insulation installed below floating screed

B1

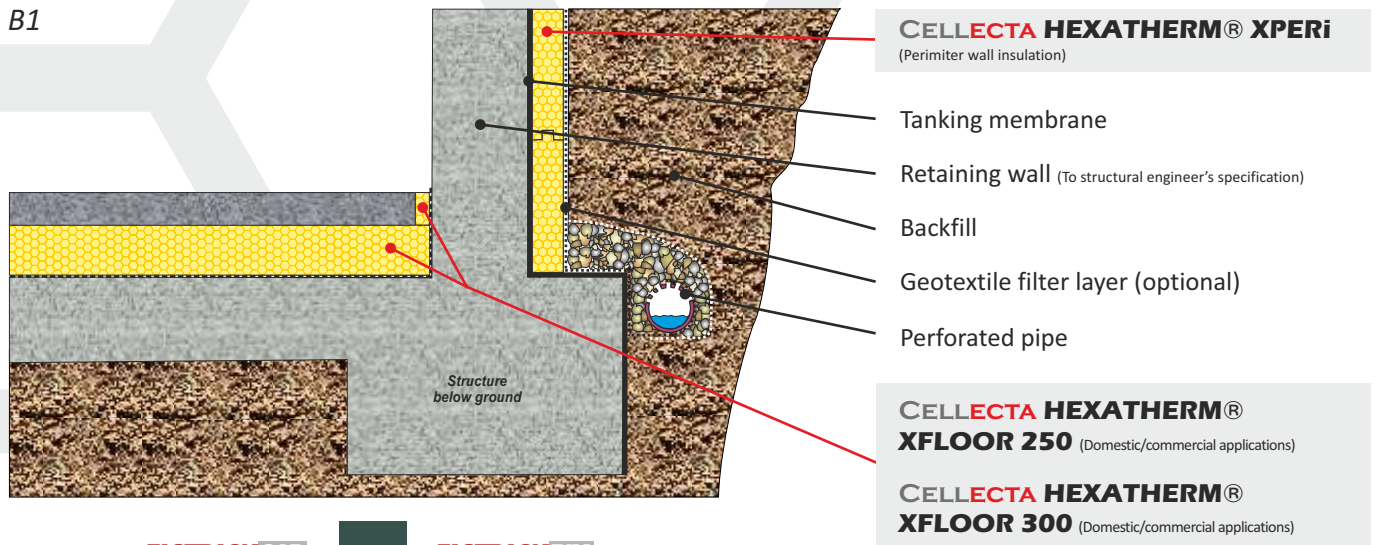

FASTRACKCAD
ARCHITECTURAL CAD DATABASES

nsPlus

FASTRACKBIM
ARCHITECTURAL BIM DATABASES

PRODUCT INFORMATION

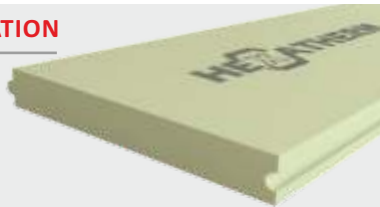

XPERi & **XFLOOR** boards have outstanding compressive strength, low water absorption and life-long thermal performance, make them the ideal insulation for basements and below ground applications.

PRODUCT BENEFITS

- Very low water absorption
- High compressive strength
- Excellent life-long thermal performance
- Closed cell structure

PHYSICAL PROPERTIES

	XPERi	XFLOOR	
		250	300
Thermal Conductivity EN 12667 (W/mK)	≤30mm 0.035 ≥40mm 0.035	0.035 -	- 0.035
Strength at 10% compression EN 826 (kPa)	≤30mm 250 ≥40mm 300	250 -	- 300
Strength at 2% compression EN 1606 (kPa)	≤30mm 80 ≥40mm 125	80 -	- 125
Long term water absorption by immersion EN 12087	0.7%	0.7%	0.7%
Temperature range	-50/+75 °C	-50/+75 °C	-50/+75 °C
Board size (mm)	600 x 2500	600 x 2500	600 x 2500
Thickness* (mm) (other sizes manufactured to order)	30 40 50 60 80 100 120 140 160	20 25 30	40 50 60 75 80 100 120 140 160
Edge profile	T&G	Square	Square

(1) Excluding XFLOOR 500

(2) Currently undergoing assessment. (3) On completion of ISO14001 assessment.

TYPICAL THICKNESS OF INSULATION REQUIRED

The method of calculating the U-value of a basements is more complex than other applications. To determine the thickness of insulation required contact **CELLECTA** for assistance.
 T. 08456 71-71-74.
 E. technical@cellecta.co.uk

THIRD PARTY ACCREDITATION & APPROVALS

BM TRADA⁽²⁾ Q Mark certified product
 NHBC, LABC and Premier guarantee accepted
 BREAM MAT 6 compliant⁽³⁾

STANDARDS

EN 13164: 2012
 ISO 9001 - Quality management system (QMS)⁽²⁾
 ISO 14001 - Environmental management system (EMS)⁽²⁾

ENVIRONMENTAL CREDENTIALS



CODE FOR SUSTAINABLE HOMES

The following Code for Sustainable Homes credits are obtainable as a result of incorporating **HEXATHERM®** into the construction detailed.

Pol 1		Mat 1	
HEXATHERM XPS boards		Element N°	820100010
GWP value	<5	Green Guide rating	C
Code credits	1	Code credits	0.5

Note. Pol.1 Code credits have an approximate weighted value of 0.7

Note. Mat 1 Code credits have an approximate weighted value of 0.3