



FIREMAC 2000

The Firemac 2000 is a flap type ventilator suitable for natural and smoke extraction. Various options are available within the range providing flexibility and choice for the designer and customer. These include insulated and uninsulated versions along with units incorporating translucent polycarbonate tops for providing natural daylight. A further option is a unit with a thermally separated construction.

The variety of options and low profile appearance make the Firemac suitable for industrial buildings, shopping centres and atria. Smoke exhaust from stairwells is an ideal application for this unit.

MATERIAL

Corrosion resistant mill finish aluminium.

FIREMAC 2000

OPERATION

P2 double-acting compressed air operation

M motor operation

Suffix: **B** fire function **FS** failsafe (P model only)

BASE OPTIONS

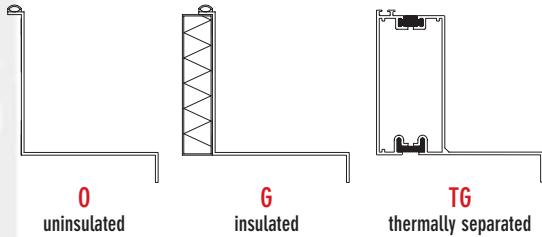

FLANGE OPTIONS

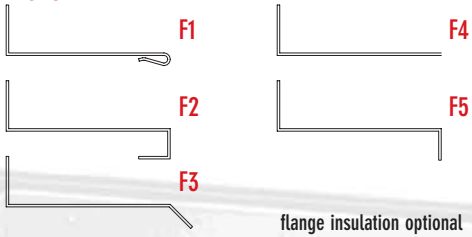

FLAPS

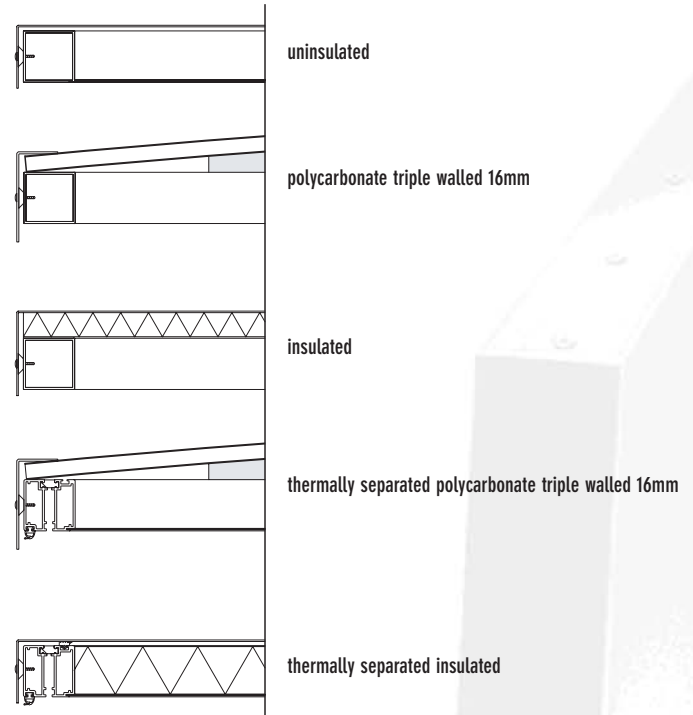

Type	Geometric area m ²	Aerodynamic area m ²	Weight with aluminium flaps kg	Weight with translucent polycarbonate flaps kg	Weight with uninsulated aluminium flaps kg	Weight with uninsulated translucent polycarbonate flaps kg	Height mm	Throat size width x length mm
1520	3.00	1.95	120	102	45	45	200	1500 x 2000
2020	4.00	2.60	140	116	60	60	200	2000 x 2000
2025	5.00	3.25	164	135	75	75	200	2000 x 2500
2525	6.25	4.06	188	150	90	90	200	2500 x 2500

CROSS SECTIONS

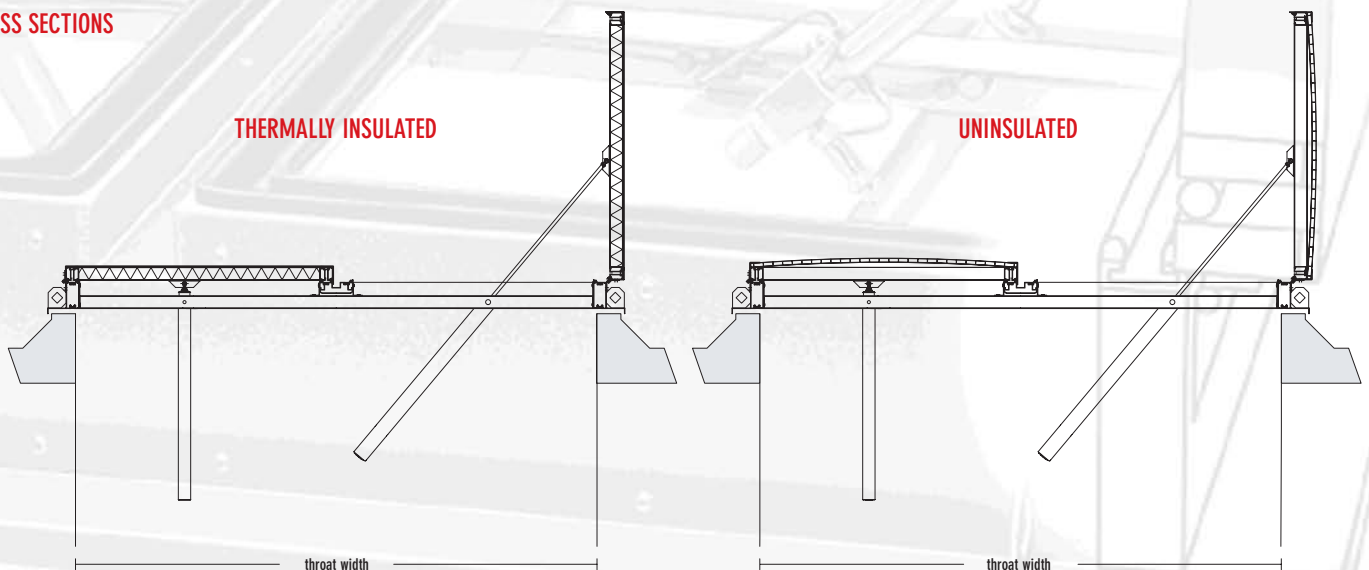

McKENZIE MARTIN LIMITED

ETON HILL WORKS, ETON HILL ROAD, RADCLIFFE, MANCHESTER, M26 2US

TEL: 0161 723 2234 FAX: 0161 725 9531 EMAIL: general@mckenziemartin.co.uk