

# Tectite ADVANCE

## The Carbon Steel Push-fit System



# Tectite ADVANCE

## *The Carbon Steel Push-fit System*

Tectite Advance is our latest innovative push-fit System. It will revolutionise your approach to vented and unvented closed circuit heating and chilled water installations.



- ***The first galvanised carbon steel push-fit jointing System***
- ***Fittings and carbon steel System tube available in sizes from 15mm to 54mm***
- ***Low profile, compact design providing electrical continuity***
- ***Installed cost savings of up to 70% when compared to traditional jointing methods***
- ***10 year System guarantee***
- ***No special tools or time consuming threading required***

Designed for use as a System in conjunction with our galvanised and plastic coated XPress Carbon steel System tube, our research shows that a Tectite Advance System is five times quicker to install than a traditional screwed steel installation.\*

With installed cost savings of up to 70% borne out in an independent industry report, Tectite Advance will help deliver your projects on time and within budget.

\*Research carried out in conjunction with Leeds College of Building, February 2007.

## Installation instructions

To ensure Tectite Advance fittings stay clean and free from damage, only remove the fitting from its packaging immediately prior to installation.

### Preliminaries

Select the right size of tube and fitting. Ensure both are clean and free from damage, scores and imperfections, and that the "O" ring and grab ring are clean and intact within the fitting. Do not use any additional lubricant or sealing compounds.

### Preparation



1. Cut the tube square using a cutting tool such as the Rems Cento, or a rotary tube cutter.



2. When using plastic coated XPress Carbon steel System tube, the coating must be removed to the socket depth of the fitting using the S115 stripping tool from the XPress accessories range. Select the correct sized tool, fully insert the tube and twist the tool until the excess of plastic is completely detached.



3. Remove any burrs or sharp edges from the external tube end using an S120 deburring tool from the XPress accessories range. Also deburr the internal bore. If using plastic coated tube, the use of the S115 tool (as Point 2), will deburr the inside of 15mm to 28mm tube. The same tool will also deburr the outside of plastic coated tube – insert the tube into the opposite end of the tool and twist.

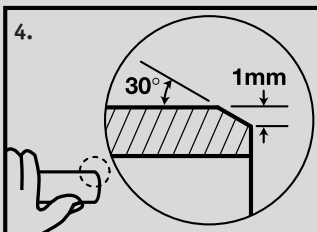

4. Having deburred as above you will be left with a 1mm chamfer on the outside of the tube, as indicated in the diagram. Wipe clean the tube end to remove all swarf and debris.



5. Mark the socket depth using a marker/pencil and the T117 depth gauge or with a ruler to the correct depth (see table).

### Joining



1. Inspect the fitting ensuring that the grab rings/'O'-rings have not been contaminated with grit or debris. Insert the tube/pipe into the mouth of the fitting to rest against the grab ring.



2. Push the tube firmly with a slight twisting action until it reaches the tube stop with a positive "click".



3. Ensure the depth insertion mark corresponds with the mouth of the fitting, then pull firmly on the tube to ensure the fitting is secure.

### Tectite Advance fitting socket depths

Size	Socket depth
15mm	18mm
18mm	18mm
22mm	19mm
28mm	20mm
35mm	31mm
42mm	32mm
54mm	37mm

NOTE: Tectite Advance fittings must not be used with male ended fittings or valves from other Tectite ranges (Except T526S).

Other third party male-ended products should not be used with Tectite Sprint.

Do not use Tectite Advance on gas services

Tectite Advance Fittings are non-demountable.

## System Performance

### Working temperatures and pressures

A Tectite Advance System performs to the following working temperatures and pressures.

#### Tectite Advance performance when correctly assembled with carbon steel tube to DIN 2394/NEN 1982

Sizes	Service Temperature			Max 114°C
	Min -24°C	30°C	65°C	
15mm to 54mm	20 bar	20 bar	16 bar	10 bar

### Tube compatibility

Tectite Advance fittings are designed to be used with our galvanised and plastic coated XPress Carbon steel System tube to DIN 2394/NEN 1982.

They can also be used with other thin-walled carbon steel tubes meeting this specification.



### Guarantees

Tectite Advance fittings are guaranteed for 5 years against manufacturing defects.

When used in a System exclusively with our XPress Carbon steel System tube, a guarantee of 10 years applies.

To qualify for these guarantees, products must be installed in accordance with our instructions on specified applications.

### Specification clauses

The following specification clauses provide the exact wording required to ensure the correct Tectite product is used for the job.

#### Tectite Advance fitting specification

“Push-fit fittings shall be made from carbon steel in sizes from 15mm to 54mm, they will be capable of operating between -24°C and 114°C. With a pressure rating of 20 bar from -24°C to 30°C, 16 bar from 31°C to 65°C and of 10 bar from 66°C to 114°C. Suitable for use on unvented closed circuit heating and chilled water applications, with galvanised or plastic coated XPress carbon steel System tube to DIN 2394/NEN 1982 or other carbon steel tube to DIN 2394/NEN 1982. Fittings shall provide electrical continuity when installed with carbon steel tube and will have a guarantee of 5 years against all manufacturing defects and be drawn from the Tectite Advance range from Pegler Yorkshire.

#### Tectite Advance System specification

“Push-fit fittings shall be made from carbon steel in sizes from 15mm to 54mm, they will be capable of operating between -24°C and 114°C. With a pressure rating of 20 bar from -24°C to 30°C, 16 bar from 31°C to 65°C and of 10 bar from 66°C to 114°C. Suitable for use on unvented closed circuit heating and chilled water applications, Fittings shall provide electrical continuity when installed with carbon steel tube and be drawn from the Tectite Advance range from Pegler Yorkshire. Tubes shall be galvanised/ plastic coated XPress carbon steel System tube to DIN 2394/NEN 1982 drawn from the XPress Carbon range from Pegler Yorkshire. The system will be constructed exclusively with components from the Tectite Advance and XPress Carbon ranges from Pegler Yorkshire and have a guarantee of 10 years against all manufacturing defects”.

#### Carbon Steel System Tube

##### SC640 – Galvanised Carbon Steel System Tube

3 meter lengths

SIZE	MTR	CODE
15mm x 1.2mm	3m	45080
18mm x 1.2mm	3m	45081
22mm x 1.5mm	3m	45082
28mm x 1.5mm	3m	45083
35mm x 1.5mm	3m	45084
42mm x 1.5mm	3m	45085
54mm x 1.5mm	3m	45086

##### SC640 – Galvanised Carbon Steel System Tube

6 meter lengths

SIZE	MTR	CODE
15mm x 1.2mm	6m	25080
18mm x 1.2mm	6m	25081
22mm x 1.5mm	6m	25082
28mm x 1.5mm	6m	25083
35mm x 1.5mm	6m	25084
42mm x 1.5mm	6m	25085
54mm x 1.5mm	6m	25086

##### SC660 – Plastic Coated Galvanised Carbon Steel System Tube

6 meter lengths

SIZE	MTR	CODE
15mm x 2.2mm	6m	25060
18mm x 2.2mm	6m	25061
22mm x 2.5mm	6m	25062
28mm x 2.5mm	6m	25063
35mm x 2.5mm	6m	25064
42mm x 2.5mm	6m	25065
54mm x 2.5mm	6m	25066



**Tectite Advance push-fit fittings**

<b>TA1 Straight coupling</b>		
SIZE	BOX QTY	CODE
15mm	10	76000
18mm	10	76001
22mm	5	76002
28mm	5	76003
35mm	5	76004
42mm	1	76005
54mm	1	76006



<b>TA12S Street Elbow</b>		
SIZE	BOX QTY	CODE
15mm	10	76040
18mm	10	76041
22mm	5	76042
28mm	5	76043
35mm	5	76044
42mm	1	76045
54mm	1	76046

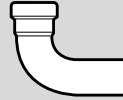

<b>TA30 Female Branch Tee</b>		
SIZE	BOX QTY	CODE
15 x 15mm x 1/2"	10	76085
18 x 18mm x 1/2"	10	76086
22 x 22mm x 1/2"	5	76087
28 x 28mm x 1/2"	2	76088
35 x 35mm x 1/2"	1	76089
42 x 42mm x 1/2"	1	76090
54 x 54mm x 1/2"	1	76091

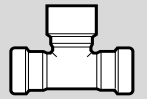

<b>TA2 Straight female connector</b>		
SIZE	BOX QTY	CODE
15mm x 1/2"	10	76007
18mm x 1/2"	10	76008
22mm x 3/4"	5	76010
28mm x 1"	5	76011



<b>TA12S Street Elbow</b>		
SIZE	BOX QTY	CODE
15mm	10	76047
18mm	10	76048
22mm	5	76049
28mm	5	76050
35mm	5	76051
42mm	1	76052
54mm	1	76053



<b>TS6 Stop End</b>		
SIZE	BOX QTY	CODE
15mm	10	25866
18mm	5	25870
22mm	5	25874
28mm	5	25876
35mm	1	25878
42mm	1	25880
54mm	1	25882



<b>TA3 Straight male connector</b>		
SIZE	BOX QTY	CODE
15mm x 1/2"	10	76013
18mm x 1/2"	10	76014
22mm x 3/4"	5	76016
28mm x 1"	5	76017
35mm x 1 1/4"	5	76018
42mm x 1 1/4"	1	76019
54mm x 2"	1	76020



<b>TA12S Street Elbow</b>		
SIZE	BOX QTY	CODE
15mm	10	76054
18mm	10	76055
22mm	5	76056
28mm	5	76057
35mm	5	76058
42mm	1	76059
54mm	1	76060



<b>TA69 Straight Male Union Connector</b>		
SIZE	BOX QTY	CODE
15mm x 1/2"	10	76092
18mm x 1/2"	10	76094
22mm x 3/4"	5	76097
28mm x 1"	2	76099
35mm x 1 1/4"	5	76100
42mm x 1 1/4"	1	76101
54mm x 2"	1	76102



<b>TA6 Reducer</b>		
SIZE	BOX QTY	CODE
18 x 15mm	10	76021
22 x 15mm	5	76022
22 x 18mm	5	76023
28 x 15mm	5	76024
28 x 18mm	5	76025
28 x 22mm	5	76026
35 x 15mm	5	76110
35 x 18mm	5	76111
35 x 22mm	5	76027
35 x 28mm	5	76028
42 x 22mm	1	76112
42 x 28mm	1	76113
42 x 35mm	1	76029
54 x 22mm	1	76030
54 x 28mm	1	76031
54 x 35mm	1	76114
54 x 42mm	1	76032



<b>TA24 Equal tee</b>		
SIZE	BOX QTY	CODE
15mm	10	76061
18mm	10	76062
22mm	5	76063
28mm	2	76064
35mm	5	76065
42mm	1	76066
54mm	1	76067

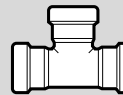

**Accessories**

<b>T117 Depth Gauge</b>		
SIZE	BOX QTY	CODE
15 to 54mm	1	76120

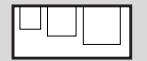

<b>TA12 Elbow</b>		
SIZE	BOX QTY	CODE
15mm	10	76033
18mm	10	76034
22mm	5	76035
28mm	5	76036
35mm	5	76037
42mm	1	76038
54mm	1	76039



<b>TA25 Tee, reduced branch</b>		
SIZE	BOX QTY	CODE
18 x 18 x 15mm	10	76068
22 x 22 x 15mm	5	76069
22 x 22 x 18mm	5	76070
28 x 28 x 15mm	2	76071
28 x 28 x 18mm	2	76072
28 x 28 x 22mm	2	76073
35 x 35 x 15mm	5	76074
35 x 35 x 18mm	5	76075
35 x 35 x 22mm	5	76076
35 x 35 x 28mm	5	76077
42 x 42 x 22mm	1	76078
42 x 42 x 28mm	1	76079
42 x 42 x 35mm	1	76080
54 x 54 x 22mm	1	76081
54 x 54 x 28mm	1	76082
54 x 54 x 35mm	1	76083
54 x 54 x 42mm	1	76084

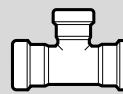

<b>S115 Tube stripper</b>		
SIZE	BOX QTY	CODE
15mm	1	39260
18mm	1	39261
22mm	1	39262
28mm	1	39263
35 to 54mm	1	39264



<b>S120 Deburring tool</b>		
SIZE	BOX QTY	CODE
15 to 54mm	1	39168





The perfect commercial partnership



Pegler is an expert in the production of Taps, Mixers and Valve products. It boasts an unrivalled track record for integrity, quality, reliability and innovation.



Yorkshire is a specialist in the production of metal plumbing and heating fittings. It has an established reputation for manufacturing quality products.



LUXURY TAP SOLUTIONS



HEATING CONTROLS



VALVES AND FITTINGS



UTILITY TAP SOLUTIONS



INTEGRAL SOLDER RING FITTINGS



THE PUSH-FIT JOINTING SYSTEM



THE PRESS-FIT JOINTING SYSTEM



COMPRESSION FITTINGS



END FEED FITTINGS



COMMERCIAL VALVES



## The Carbon Steel Push-fit System

For further information, please contact your appropriate Sales Office

### UK

Telephone: 0113 270 6945 / 0113 272 5380

Fax: 0113 270 5644 / 0113 272 5385

Email: [yorkshire.sales@peglyorkshire.co.uk](mailto:yorkshire.sales@peglyorkshire.co.uk)

### Northern Ireland

Telephone: 028 9070 6990

Fax: 028 9070 6999

Email: [belfast.sales@peglyorkshire.co.uk](mailto:belfast.sales@peglyorkshire.co.uk)

### EXPORT

Telephone: +44 (0) 1302 560 330

Fax: +44 (0) 1302 730 513

Email: [export@peglyorkshire.co.uk](mailto:export@peglyorkshire.co.uk)

### Technical Support

Telephone: 0113 270 6945

Fax: 0113 270 5644

Email: [yorkshiretech.help@peglyorkshire.co.uk](mailto:yorkshiretech.help@peglyorkshire.co.uk)



# Yorkshire

Yorkshire Fittings Limited, Haigh Park Road, Stourton, Leeds, West Yorkshire, LS10 1RT, England.

[www.peglyorkshire.co.uk](http://www.peglyorkshire.co.uk)

Registered Company No. 00401507. Place of Registration: England  
All brand names and logo styles are registered trademarks.

Maintaining a policy of continual product development, Pegler Yorkshire reserve the right to change specifications, design and materials of products listed in this price list without prior notice. LIT.REF: 880297 04.08