

# Servirufe® Traffic Deck System

Cold-applied, concrete deck waterproofing system combining sheet and liquid membranes.

## Advantages

- **Dual Protection System** - combines the advantages of preformed sheet with seamless liquid for maximum assurance.
- **Robust protection** - Servipak® boards prevent damage during construction and service.
- **No naked flame system** - eliminates fire hazard.
- **Flexible** - membrane and compound properties accommodate minor movement.
- **Bonded system** - prevents lateral water migration and transfers braking forces to substrate.
- **Optional drainage system** - high compressive strength drainage sheet available to provide efficient deck drainage.

## System Description

Servirufe® Traffic Deck System combines Bituthene® 4000 sheet membrane and Servidek® liquid membrane with Servipak® protection boards to provide a durable waterproofing and protection system capable of accepting a wide variety of wearing surfaces on concrete decks subject to pedestrian and vehicular traffic.

Unlike hot applied systems which can become brittle and debond from the substrate, Servirufe Traffic Deck System remains flexible and fully bonded.

The addition of Insupak® 2 HD or SHD insulation boards provides an insulated traffic deck system.

The system can be further enhanced by using Hydroduct® as a sub-surface drainage sheet.

Servirufe Traffic Deck with Drainage Option

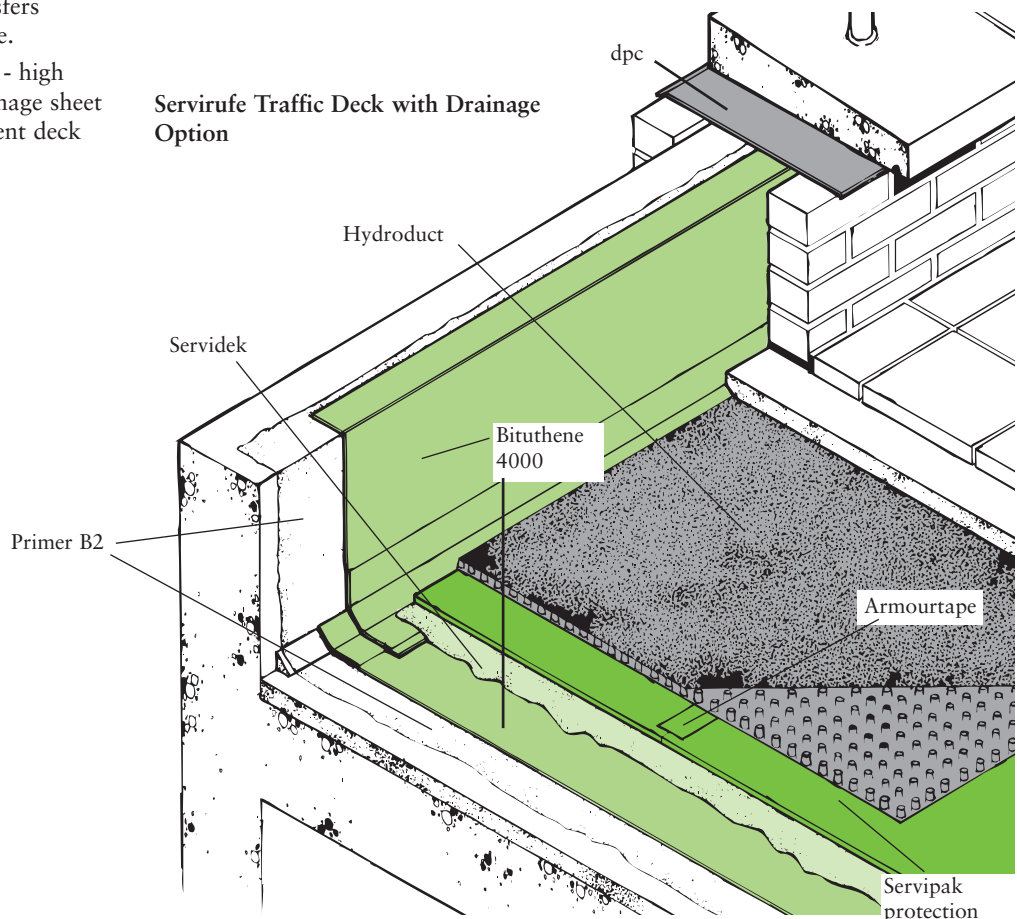

*Details shown are typical illustrations only and not working drawings. For assistance with working drawings and additional technical advice please contact Grace Technical Services*

## Supply

<b>Bituthene® 4000</b>	1.0 m x 20.0 m roll (20 sq m)
Weight	32 kg
Palletisation	15 rolls per pallet
Storage	Store upright in dry conditions below +30°C.
<b>Primer B2</b>	5 and 25 litre drums
Coverage	10-12 sq metres per litre depending on method of application, surface texture, porosity and ambient temperature
<b>Servidek®</b>	22.5 litre pack
Coverage	Approx. 12.5 sq metres per mixed unit @ 1.5mm thickness
Storage	Under cover in original sealed containers above +4°C, below +30°C
Shelf Life	12 months
Working life	Approximately 20 minutes at 20°C RH 60%
<b>Protection Boards</b>	
Servipak® 3	3 mm x 1.0 m x 2.0 m
Servipak® 6	6 mm x 1.0 m x 2.0 m
Armourtape	75 mm x 10 m rolls
Hydroduct® 650	32 m x 1.25 m = 40 m <sup>2</sup>
<b>Ancillary Materials</b>	See separate data sheets

### Equipment by others

Brush or airline for cleaning surface. Soft broom, paint brush or roller, Stanley knife and hand tools.

### Installation

#### Surface Preparation

Substrate surfaces must be dry, clean, and free from sharp projections such as nail heads, concrete nibs, etc. Concrete surfaces should have a float finish.

All surfaces to be waterproofed should be first treated with B2 primer, at a coverage rate of 10 m<sup>2</sup> to 12 m<sup>2</sup> per litre and allowed to dry completely.

#### Application

1. Release paper on Bituthene 4000 membrane is removed prior to application to the substrate. In all cases, as the membrane is laid, it must be pressed firmly from the middle outwards so that air is not trapped.

2. Adjacent membrane sheets should be overlapped by at least 100 mm along their length and by at least 100 mm at ends and vertical joints.

3. All lap joints must be pressed firmly to form a continuous bond ensuring weathertightness.

4. Parts A and B of Servidek compound are mixed on site to a combined volume of 22.5 litres and spread by a trowel or squeegee onto the membrane at a coverage rate of approximately 12.5 m<sup>2</sup> per unit. Application of Servidek compound must take place immediately, otherwise pouring and spreading will be restricted.

5. Application of Servidek compound should not be made if rain or frost are imminent, or in conditions where it is likely to freeze before curing.

6. Servidek compound should be protected immediately from solar heat gain by bedding Servipak 3 protection boards onto the uncured compound.

7. Servipak 3 protection boards should be cut and trimmed on site and joints closely butted. Joints between the boards are covered with Armour Tape bonded onto primed surface of Servipak 3 boards.

8. Any exposed vertical surfaces of Bituthene 4000 membrane should be adequately protected by Solarshield or a suitable counter flashing.

9. A suitable surfacing of hot-rolled asphalt or concrete must be applied over the Servipak 3 protection boards.

### Health And Safety

For Servidek, Primer B2, Bituthene Liquid Membrane read the product label and Material Safety Data Sheet (MSDS) before use. Users must comply with all risk and safety phrases. MSDS's can be obtained from Grace Construction Products or from our web site at [www.graceconstruction.com](http://www.graceconstruction.com).

There is no legal requirement for a Material Safety Data Sheet for Bituthene 4000, Servipak Protection Boards, Armourtape, Hydroduct. For health and safety questions on these products please contact Grace Construction Products Limited.

### Specification

For NBS specifications contact Grace Technical Services.

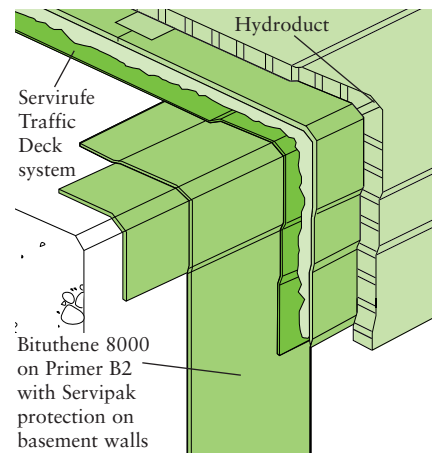
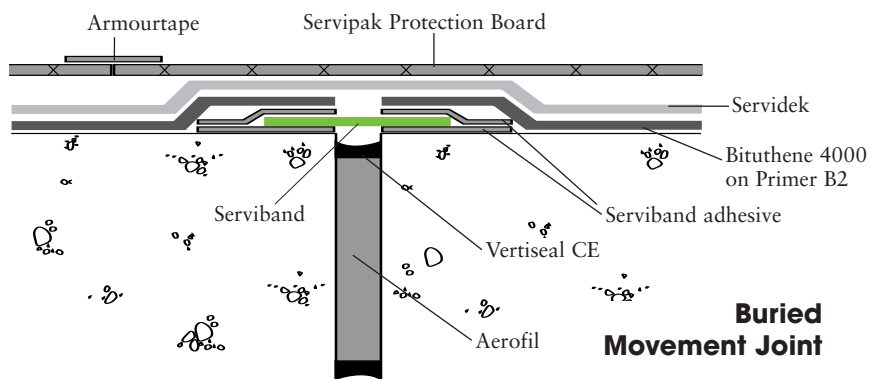

Detail of Basement Roof

 Visit our web site at [www.graceconstruction.com](http://www.graceconstruction.com)

Grace Construction Products Ltd, Ajax Avenue, Slough, Berkshire SL1 4BH United Kingdom Tel +44 (0)1753 692929 Fax +44 (0)1753 691623

Adcor, Aerofil, BETEC, Bituthene, Hydroduct, Insupak, Korkpak, Paraflex, Paraseal, Preprufe, Procor, Servised, Servidek, Servigard, Servijoint, Servimastic, Servipak, Servirufe, Serviseal, Servistrip, Servitite, Vertigard and Vertiseal are registered trademarks of W R Grace & Co.-Conn.  
Adprufe, Armourtape, Bitustik, Bitutape, Hydropaste, Pak Adhesive, PVC Edgetie, Serviband, Serviflex, Servitape, Slipstrip, and Solarshield are trademarks of W R Grace & Co.-Conn.

The information given is based on data and knowledge considered to be true and accurate and is offered for the user's consideration, investigation and verification. Since the conditions of use are beyond our control we do not warrant the results to be obtained. Please read all statements, recommendations or suggestions in conjunction with our conditions of sale including those limiting warranties and remedies which apply to all goods supplied by us. No statement, recommendation or suggestion is intended for any use which would violate or infringe statutory obligations or any rights belonging to a third party.

Copyright 2006. Grace Construction Products Limited.

Printed in England - 05.06- Ref. RM003B

**GRACE**  
Construction Products