

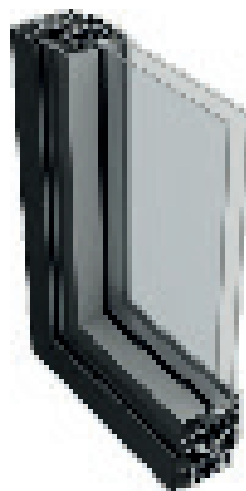

# 77IWE Open-Out window

Our high performance 77IWE Open-Out Window System is perfectly suited for a wide number of applications including hospitals, schools and high-rise apartments. The 77IWE shares the same impressive performance figures as our Open-In variant, making it our most efficient casement window.

The system is available in a wide variety of configurations, all of which offer exceptional levels of thermal performance as a result of incorporating technologies such as thermal polyamides, insulated centre seals and foam insertions. For ease of installation, the 77IWE system has been designed to fully integrate with our aluminium curtain walling and door systems.



## DESIGN FEATURES

- › High levels of thermal performance
- › Multi chamber polyamide thermal breaks, insulated centre seals and foam insertions provide excellent performance
- › Integrates with AluK curtain wall and door systems
- › Dedicated groove for EPDM mounting
- › 77mm frame depth
- › Suites with 77IW open-in system

## OPTIONS

- › Wide variety of configurations
- › Range of locking options with patented AluK Groove
- › Trickle ventilation available
- › Restrictor available
- › Available for actuators and teleflex opening options
- › Folding openers with link bar for safety
- › Available in single or dual colour polyester powder coating, texture and anodised finishes

Secured by Design



Police Preferred Specification



## SPECIFICATIONS

Performance and accreditations	77IWE
U-Value (Double Glazing) 1.0 CP	1.2 W/m²K
U-Value (Triple Glazing) 0.4 CP	0.8 W/m²K
Air Permeability	Class 4 (600 Pa)
Water Tightness	E1050 (1050 Pa)
Wind Resistance	C5 (2400 Pa)
Security	PAS 24 & SBD
3rd Party Certification Q-Mark	✓
System	
Depth	77mm
Configurations	
Top Hung	✓
Side Hung	✓
Bottom Hung	✓
Weight limits	
Top Hung	
Max Size (mm)	1500w x 2400h (See Technical Manual)
Min. Size (mm)	460w x 460h (See Technical Manual)
Max Weight	180kg (See Technical Manual)
Side Hung	
Max Size (mm)	838w x 2400h (See Technical Manual)
Min. Size (mm)	460w x 460h (See Technical Manual)
Max Weight	55kg (See Technical Manual)
Bottom Hung	
Max Size (mm)	- (See Technical Manual)
Min. Size (mm)	460w x 460h (See Technical Manual)
Max Weight	90kg (See Technical Manual)
Glazing	
Glazing Thickness	24mm – 50mm
System features	
Single Colour	✓
Dual Colour	✓
Textured Finish	✓
Anodised Finish	✓
Locking	Multi-Point
Locking Handles	✓
Folding Openers	✓
Espagnolette Handle	✓
100mm Restriction	✓
Trickle Ventilation	✓
Variable Angle Corner Post	✓
Reverse Glazing Adapter	✓
Z-profile	✓

## CAD CROSS SECTIONS

Additional details are available on request.

### 77IWE

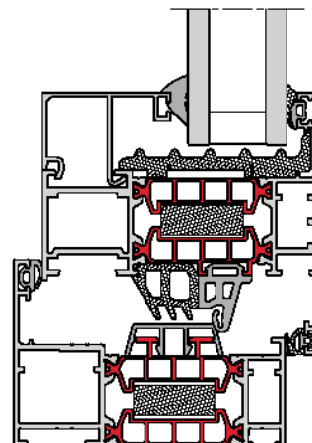

### 77IWE FIXED LIGHT

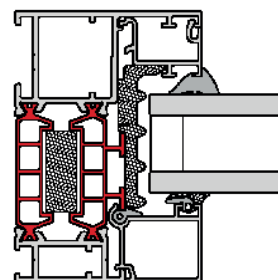

### 77IWE CILL

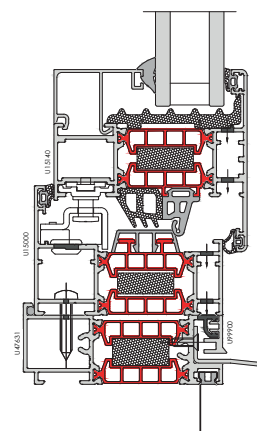

## CONFIGURATIONS

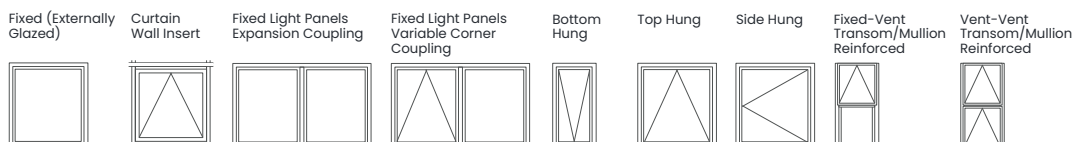

These elevations are PAS24 compliant.