



**Avon Barrier Company Ltd**



## SG1500CR High Impact Sliding Gate

The Avon SG1500CR High Impact Sliding Gate provides a high level of security against unauthorised vehicle access. Designed to withstand substantial direct impact forces, the gate will protect sites from extreme aggressive attacks.

Developed and manufactured by engineers with significant experience in the fields of High Security and Access Control, the gate is a highly dependable security product.

The Gate incorporates a full impact resistant system which enables a wide range of gate heights, clear widths and infill to be provided. Foundation depths are from under 500mm subject to gate design.

The SG1500CR gate has been independently **physically tested** in a number of full scale crash tests conducted in accordance with PAS 68 by the Transport Research Laboratory (TRL).

The impact test used a weighted 7,500kg vehicle travelling at 80kph with zero penetration.

### Features

- Physically impact tested to highest PAS 68 criteria
- Manufactured from heavy gauge materials
- Variable height and clear widths
- Manual operating override facility
- High quality coating system (minimum galvanised)
- Shallow mounting less than 500mm overall depth

### Benefits

- Confidence in proven performance
- Strength and Durability
- Flexibility to suit site requirements
- Operational under power failure conditions
- Reliable and Dependable
- Overcomes site depth restrictions

**Avon Barrier Company Ltd**  
191-195 South Liberty Lane  
Ashton Vale Trading Estate  
Bristol BS3 2TN UK

TEL (44) 0117 953 5252  
Fax (44) 0117 953 5373  
Email  
[security@avon-barrier.co.uk](mailto:security@avon-barrier.co.uk)  
[www.avon-barrier.co.uk](http://www.avon-barrier.co.uk)  
[www.avon-barrier.com](http://www.avon-barrier.com)

# SG1500CR

## Avon High Impact Sliding Gate

# Technical Specification

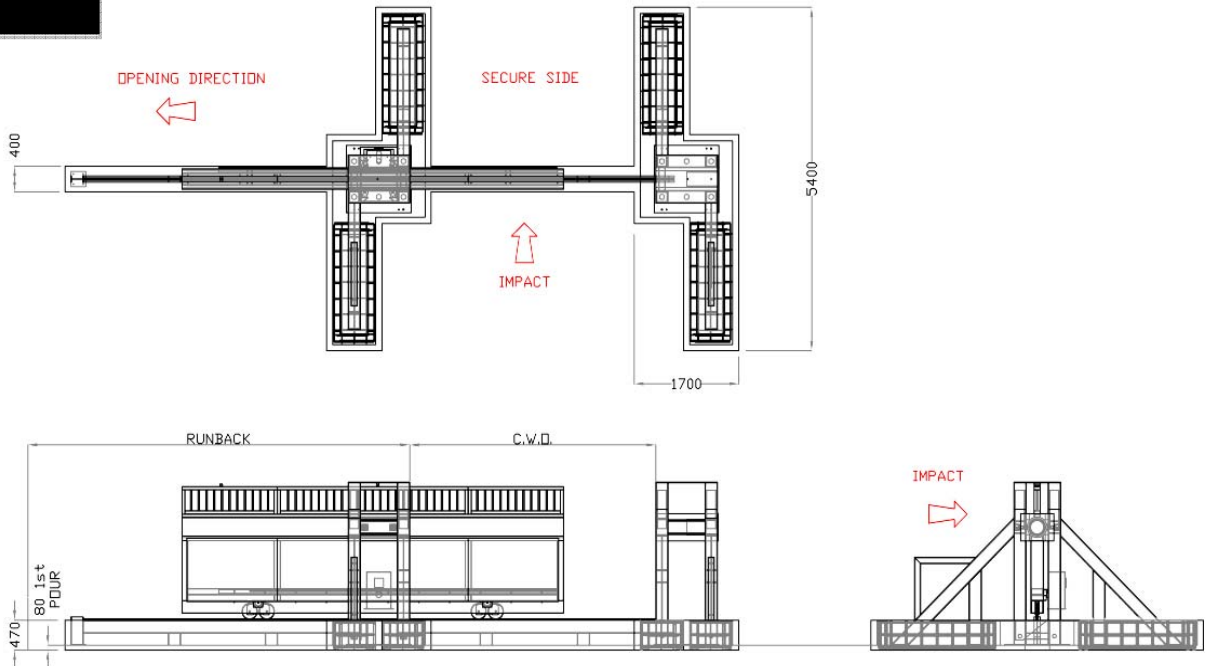

## SG1500CR High Impact Sliding Gate

### Options

The Gate comes with a push-button control as standard, however it can be customised to interface with a wide range of access control equipment to suit specific customer requirements (available as options) and any configuration including (but not limited to) inductive loop systems, card readers, communication equipment and manned guard panic systems can be accommodated.

Where the Gate control point is remote from the installation, we strongly recommend the fitting of a recordable CCTV system, traffic lights and safety inductive loop systems

### Options available

- Emergency buttons with lock down
- UPS backup for the electrical system
- Access control and Intercom systems
- Inductive loop systems
- Traffic lights and back-indication system
- Serrated / Barbed Wire toppings
- Matching infill panels

### Technical Details

**Physical Dimensions:** To suit site requirements

**Power requirements:** Subject to gate size and construction

**Impact absorption:** 1852KJ

**Construction:** The framework is constructed from fully welded, heavy gauge, steel angle and box section and hi-tensile structural steel.



Avon Barrier Company Ltd



### Avon Barrier Company Ltd

191-195 South Liberty Lane  
 Ashton Vale Trading Estate Bristol BS3 2TN UK  
 Tel (44) 0117 9535 252  
 Fax (44) 0117 9535 373  
 Email [security@avon-barrier.co.uk](mailto:security@avon-barrier.co.uk)  
 Website [www.avon-barrier.com](http://www.avon-barrier.com)  
[www.avon-barrier.co.uk](http://www.avon-barrier.co.uk)